

NOTES:

- (1) PURGE ALL WATER SUPPLY LINES TO REMOVE SOLIDS PRIOR TO TOY INSTALLATION.
- (2) PROVIDE ELECTRICAL BOND WITH POOL REBAR.
- (3) INSTALL ALL WATER TOYS PLUMB AND LEVEL.
- (4) PROVIDE STRAINER UPSTREAM OF TOY WITH MAX 1/32" PERFORATIONS.

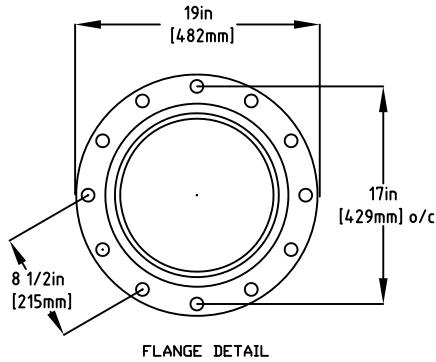

R49 1/4in [R1249.5mm]

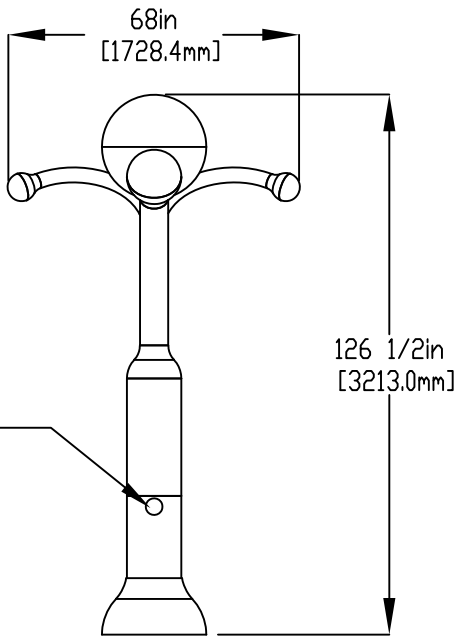
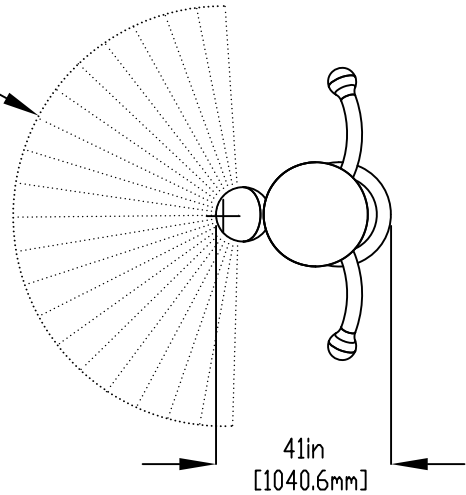

2-WAY DIVERTER

LOWER FLANGE COVER AFTER TOY IS INSTALLED.

1" (25mm) FLEX HOSE PROVIDED BY EMPEX.

5/8" (16mm) X 9"mm 316SS
 THREADED ROD, C/W FENDER WASHER
 LOCKWASHER & NUT (X6), WITH MINIMUM
 6" (150mm) EMBEDMENT. EPOXY SET
 ANCHOR ADHESIVE
 TO BE PROVIDED BY CONTRACTOR

2" (50mm) COUPLING
 2" (50mm)-1" (25mm) REDUCER
 1" (25mm) HOSEBARB & SS CLAMP
 TO BE PROVIDED BY CONTRACTOR

WATERFEED
 2" (50mm) PVC SCH 40 PIPE
 EXTENDED 4" (100mm) ABOVE SLAB.

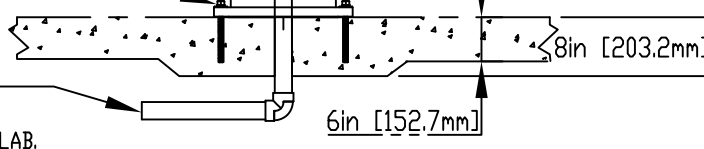

Notes: Overall dimensions of toys are approximate.
 Approximate Weight: 180lbs / 81.8kgs

© EMPEX WATERTOYS



WATER SUPPLY

30 gpm @ 25 psi
 1.89L/S @17.5m

AQUABAT #1

AB101

01/04/2020

SCALE:

Sheet 1 of 1