

NOTES:

- (1) PURGE ALL WATER SUPPLY LINES TO REMOVE SOLIDS PRIOR TO TOY INSTALLATION.
- (2) PROVIDE ELECTRICAL BOND WITH POOL REBAR.
- (3) INSTALL ALL WATER TOYS PLUMB AND LEVEL.
- (4) PROVIDE STRAINER UPSTREAM OF TOY WITH MAX 1/32" (0.8mm) PERFORATIONS.

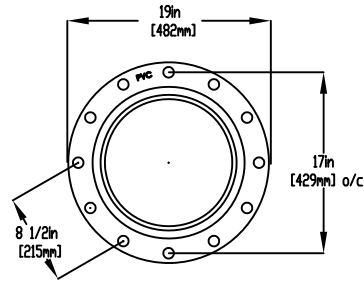

FLANGE DETAILS

R 123in
[R 3124.0mm]
SPRAY DIAMETER NTS

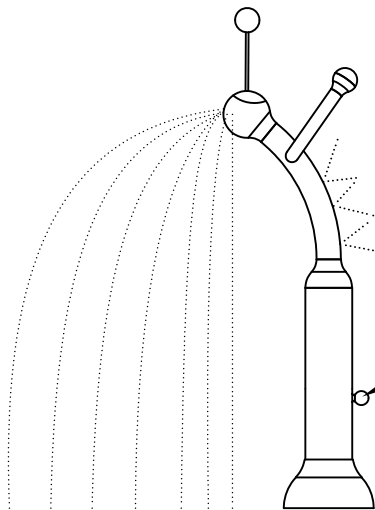
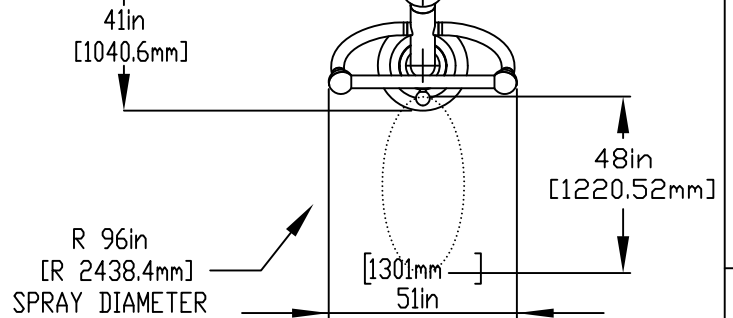
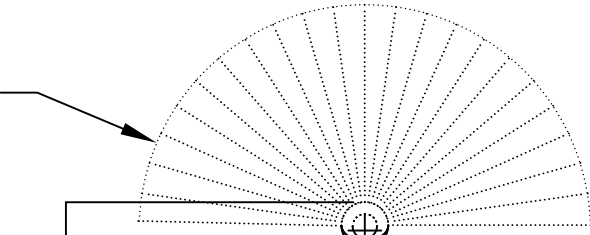

2-WAY DIVERTER

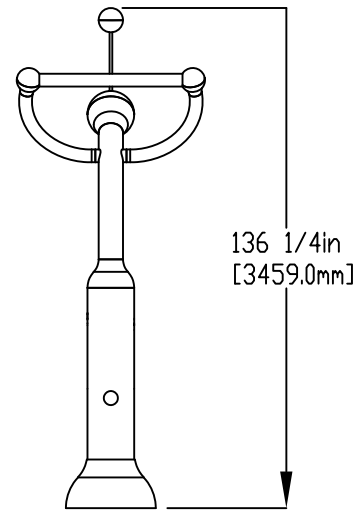

LOWER FLANGE COVER AFTER TOY IS INSTALLED.

5/8" (16mm) X9" (230mm) 316SS
THREADED ROD, C/W FENDER WASHER,
LOCK WASHER & NUT (X6), MINIMUM
6" (150mm) EMBEDMENT. WITH EPOXY SET
ANCHOR ADHESIVE.
TO BE PROVIDED BY CONTRACTOR

1" (25mm) FLEX HOSE
PROVIDED BY EMPEX.

2" (50mm) COUPLING
2" (50mm)-1" (25mm) REDUCER
1" (25mm) HOSEBARB W/SS CLAMP
TO BE PROVIDED BY CONTRACTOR

WATERFEED
2" (50mm) PVC SCH 40 PIPE
EXTENDED 6" (152mm) ABOVE SLAB.

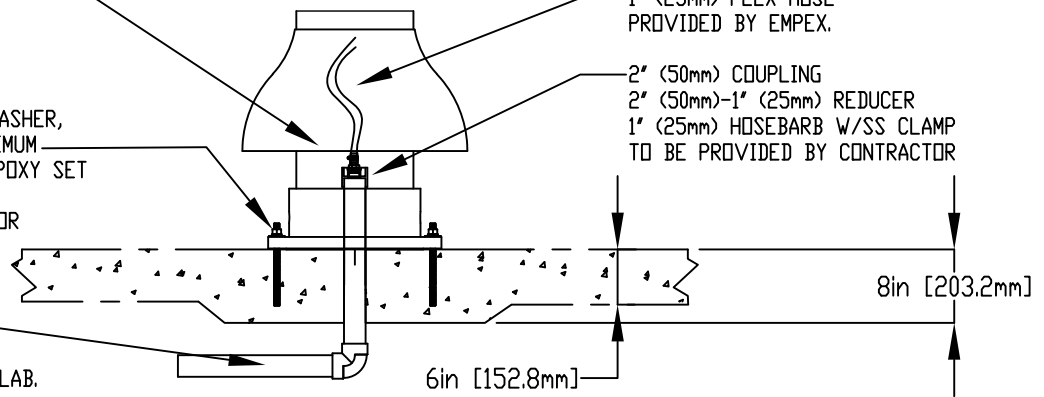

Notes: Overall dimensions of toys are approximate.
Approximate Weight: 170lbs / 77.3kgs

© EMPEX WATERTOYS

WATER SUPPLY

30 gpm @ 25 psi
1.89L/S @17.5m

AQUABAT #5

AB105

01/04/2020

SCALE:

Sheet
1 of 1