

1

2

3

4

NOTES:

(1) PURGE ALL WATER SUPPLY LINES TO REMOVE SOLIDS PRIOR TO TOY INSTALLATION.

(2) PROVIDE ELECTRICAL BOND WITH POOL REBAR.

(3) INSTALL ALL WATER TOYS PLUMB AND LEVEL.

(4) PROVIDE STRAINER UPSTREAM OF TOY WITH MAX 1/32" (0.8MM) PERFORATIONS.

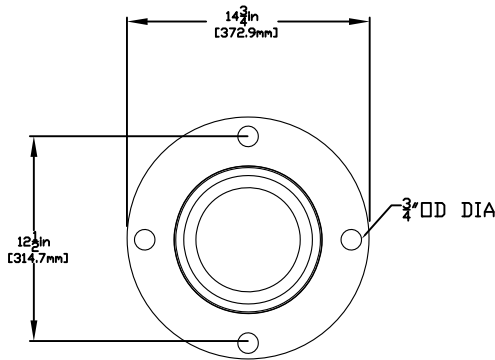
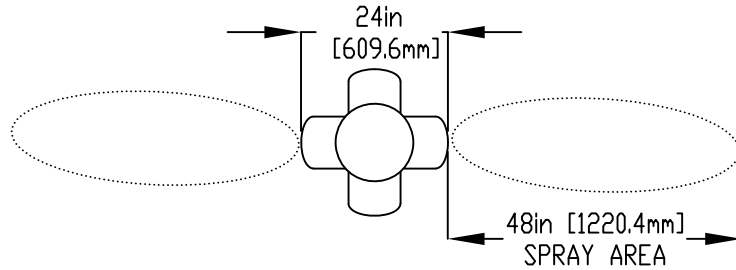

FLANGE DETAIL

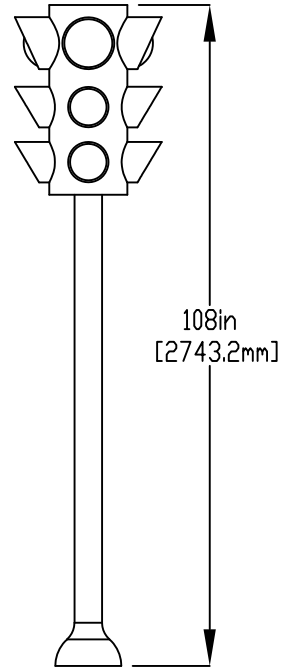

FLOODED COLUMN

LOWER FLANGE COVER AFTER INSTALL

WATERFEED
2" (50mm) FEED PIPE TO BE CUT CLOSE PRIOR TO INSTALL TO ALLOW FULL DRAINAGE (WINTERIZATION)

ENSURE LEVEL & PLUMB
INSTALL Ø6" (152mm) X 1/8" (3mm) GASKET, PROVIDED BY EMPEX

5/8" (16mm) X 9" (229mm) SS THREADED ROD, C/W FENDER WASHER, LOCKWASHER & NUT (X4), MINIMUM 6" (152mm) EMBEDMENT, EPOXY SET ANCHOR ADHESIVE TO BE PROVIDED BY CONTRACTOR

8in [203.5mm]

6in [153.0mm]

A

B

C

D

E

F

A

B

C

D

E

F

Notes: Overall dimensions of toys are approximate.

© EMPEX WATERTOYS



WATER SUPPLY
30 gpm @ 25 psi
1.89L/S @17.5m

AQUASTOP

ABU107

17/02/2022

SCALE:

Sheet
1 of 1

1

2

3

4