

NOTES:

- (1) PURGE ALL WATER SUPPLY LINES TO REMOVE SOLIDS PRIOR TO TOY INSTALLATION.
- (2) PROVIDE ELECTRICAL BOND WITH POOL REBAR.
- (3) INSTALL ALL WATER TOYS PLUMB AND LEVEL.
- (4) PROVIDE STRAINER UPSTREAM OF TOY WITH MAX 1/32" (0.8mm) PERFORATIONS.

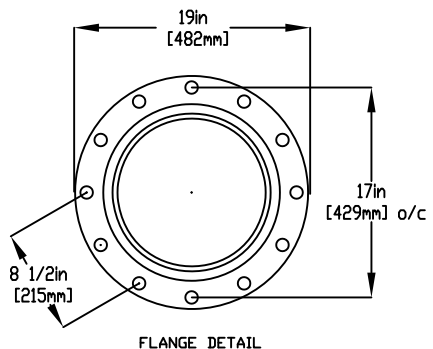

2' (50mm) COUPLING
 2' (50mm) - 1" (25mm) REDUCER
 1" (25mm) HOSEBARB W/ SS CLAMP TO BE PROVIDED BY CONTRACTOR

5/8" (16mm) X 11" (280mm) 316SS THREADED ROD, C/W FENDER WASHER LOCK WASHER & NUT (X8), MINIMUM 7" (178mm) EMBEDMENT. EPOXY SET ANCHOR ADHESIVE TO BE PROVIDED BY CONTRACTOR

GRANULAR BASE

WATERFEED
 2" (50mm) PVC SCH 40 PIPE EXTENDED 6" (152mm) ABOVE SLAB

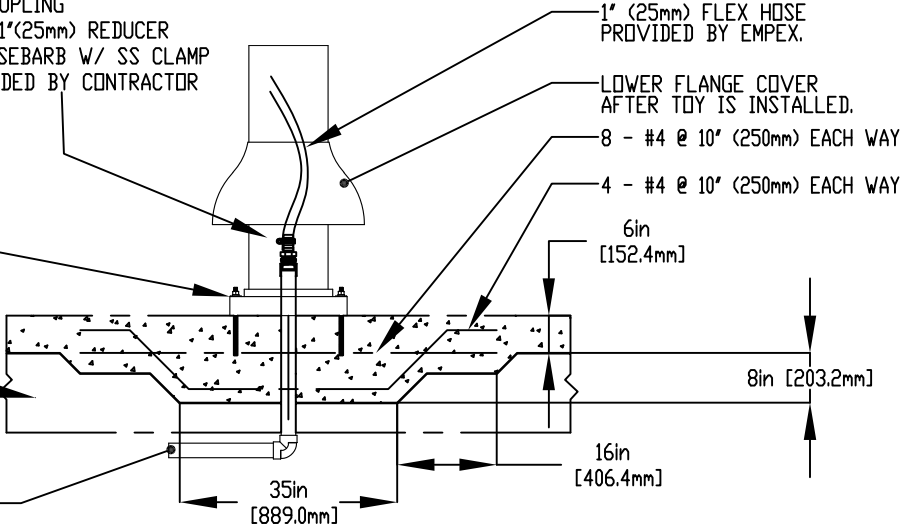

Notes: Overall dimensions of toys are approximate.
 Approximate Weight: 270Lbs / 122.7kg

© EMPEX WATERTOYS



WATER SUPPLY
 50 gpm @ 25 psi
 3.15L/S @ 17.5m

SPLASHIN' SWEETS

AD101 01/05/2020 SCALE: Sheet 1 of 1