

NOTES:

- (1) PURGE ALL WATER SUPPLY LINES TO REMOVE SOLIDS PRIOR TO TOY INSTALLATION.
- (2) PROVIDE ELECTRICAL BOND WITH POOL REBAR.
- (3) INSTALL ALL WATER TOYS PLUMB AND LEVEL.
- (4) PROVIDE STRAINER UPSTREAM OF TOY WITH MAX 1/32" (0.8mm) PERFORATIONS.

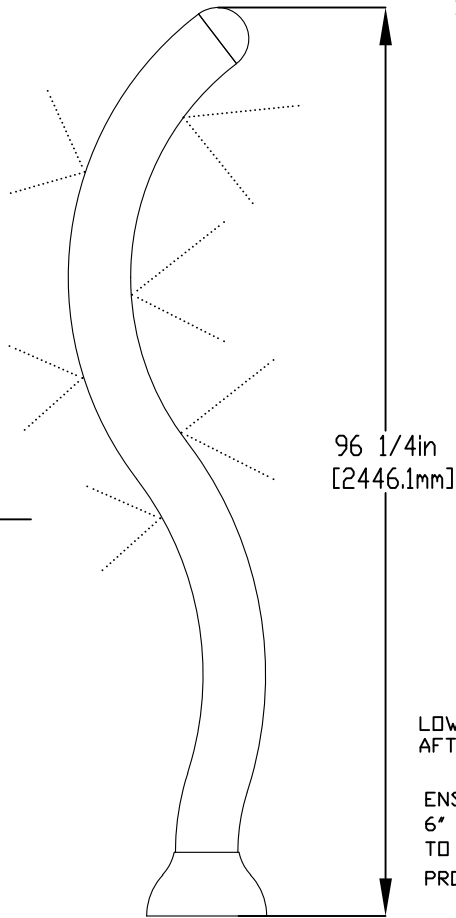

Ø72in [1828.8mm]
SPRAY DIAMETER

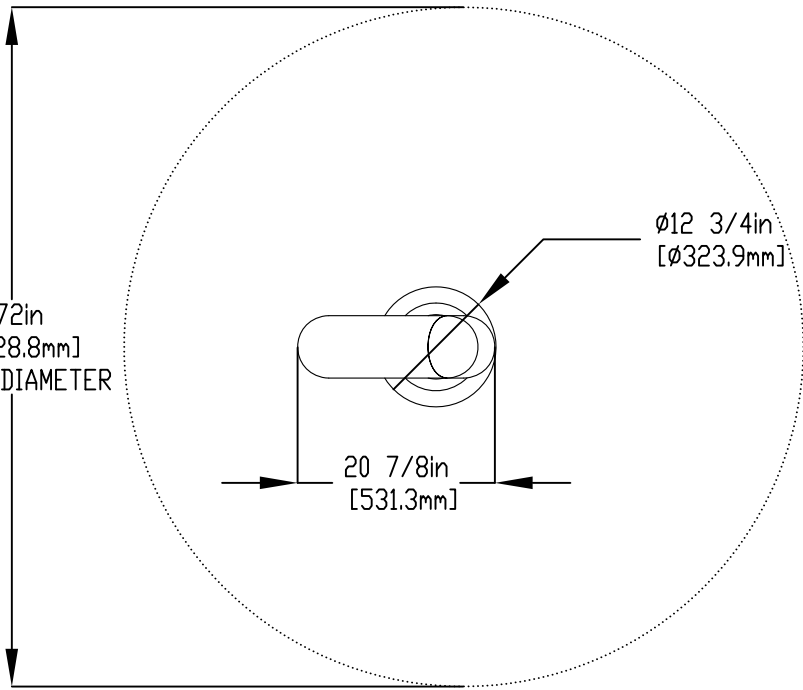

LOWER FLANGE COVER AFTER INSTALL

ENSURE LEVEL & PLUMB
6" (152mm) X 1/8" (3mm) GASKET TO BE INSTALLED UNDER FLANGE PROVIDED BY EMPEX

1/2" (13mm) X 8" (203mm) 316SS THREADED ROD, C/W FENDER WASHER, LOCKWASHER & NUT (X4), MINIMUM 6" (152mm) EMBEDMENT, EPOXY SET ANCHOR ADHESIVE TO BE PROVIDED BY CONTRACTOR

WATERFEED
2" (50mm) PVC SCH 40 PIPE CUT CLOSE PRIOR TO INSTALL TO ALLOW FOR DRAINAGE (WINTERIZATION)

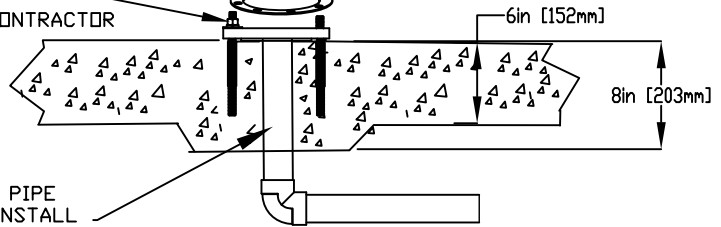
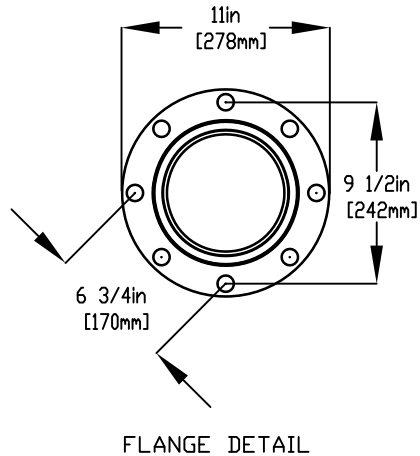

Notes: Overall dimensions of toys are approximate.
Approximate Weight: 72lbs / 32.7kgs

© EMPEX WATERTOYS

WATER SUPPLY
30 gpm @ 25 psi
1.89L/S @17.5m

AQUAWIGL DOLCE

AD272

03/09/2020

SCALE:

Sheet
1 of 1