

NOTES:

- (1) PURGE ALL WATER SUPPLY LINES TO REMOVE SOLIDS PRIOR TO TOY INSTALLATION.
- (2) PROVIDE ELECTRICAL BOND WITH POOL REBAR.
- (3) INSTALL ALL WATER TOYS PLUMB AND LEVEL.
- (4) PROVIDE STRAINER UPSTREAM OF TOY WITH MAX 1/32" (0.8mm) PERFORATIONS.

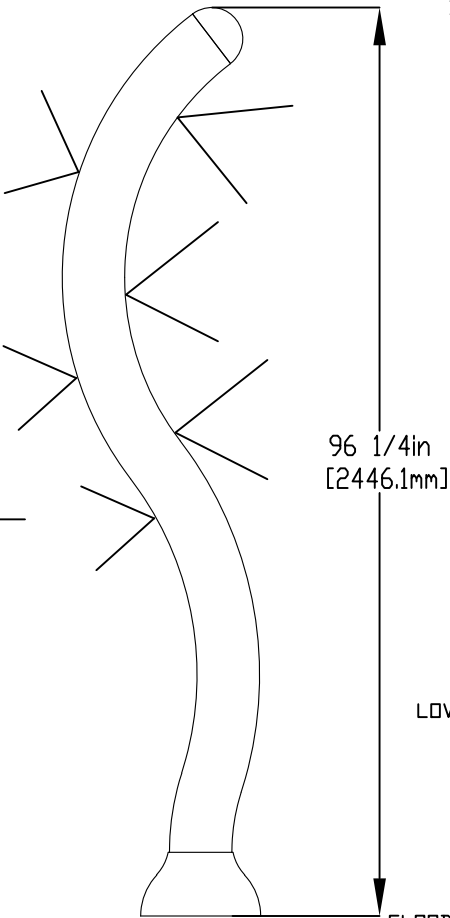

Ø72in [1828.8mm]
SPRAY DIAMETER

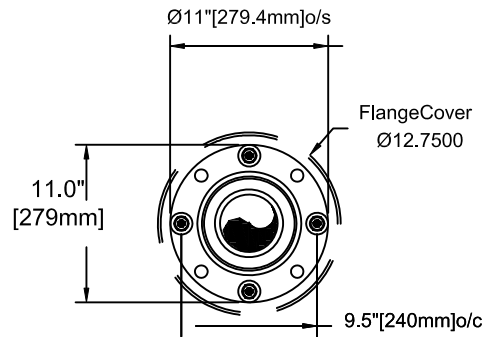
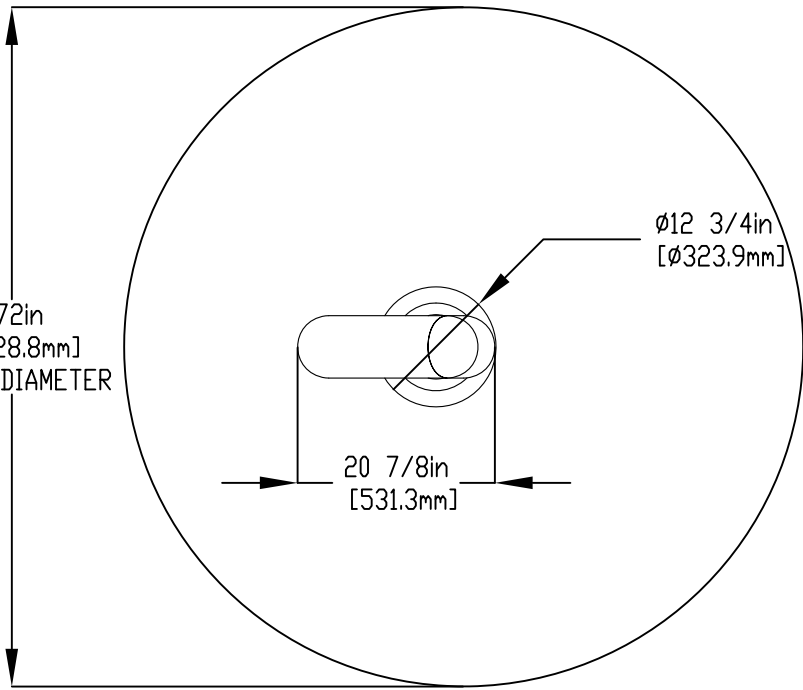

LOWER FLANGE COVER AFTER INSTALL

FLOODED COLUMN

ENSURE LEVEL SURFACE INSTALL 6" (152mm) X 1/8" (3mm) GASKET PROVIDED BY EMPEX

2" (50mm) FEED PIPE CUT CLOSE TO ALLOW FULL DRAINAGE (WINTERIZATION)

STAINLESS STEEL (316)
Ø1/2" (13mm) TREADED ROD
WASHER, LOCKWASHER & NUT
7" (180mm) TREADED ROD LENGTH WITH 5" (120mm) EMBEDMENT. INSTALL MINIMUM 5 ANCHORS. TO BE PROVIDED BY CONTRACTOR

2" (50mm) S40 PVC PIPE WATERFEED

8in [202.3mm]



Notes: Overall dimensions of toys are approximate.
Approximate Weight: 72lbs / 32.7kgs

© EMPEX WATERTOYS

WATER SUPPLY
30 gpm @ 25 psi
1.89L/S @ 17.5m

AQUAWIGL DOLCE

AD272

03/09/2020

SCALE:

Sheet 1 of 1

A

B

C

D

E

F