

NOTES:

- (1) PURGE ALL WATER SUPPLY LINES TO REMOVE SOLIDS PRIOR TO TOY INSTALLATION.
- (2) PROVIDE ELECTRICAL BOND WITH POOL REBAR.
- (3) INSTALL ALL WATER TOYS PLUMB AND LEVEL.
- (4) PROVIDE STRAINER UPSTREAM OF TOY WITH MAX 1/32" (0.8mm) PERFORATIONS.

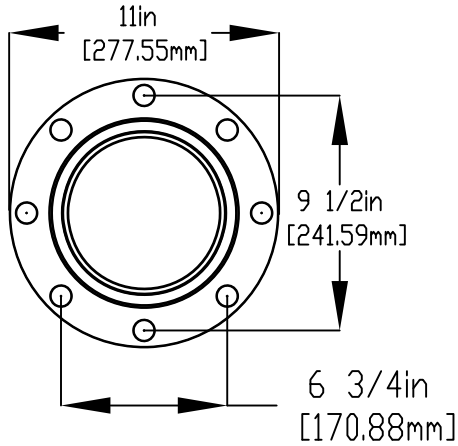

FLANGE DETAIL

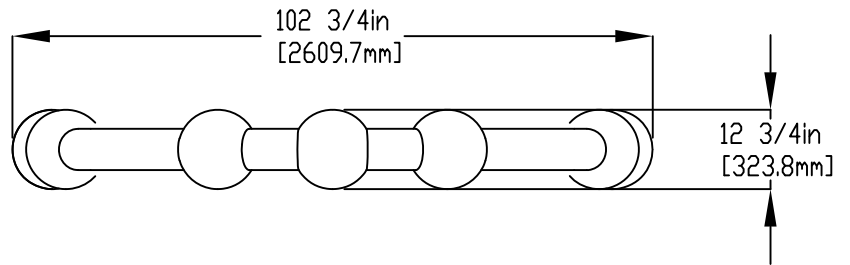
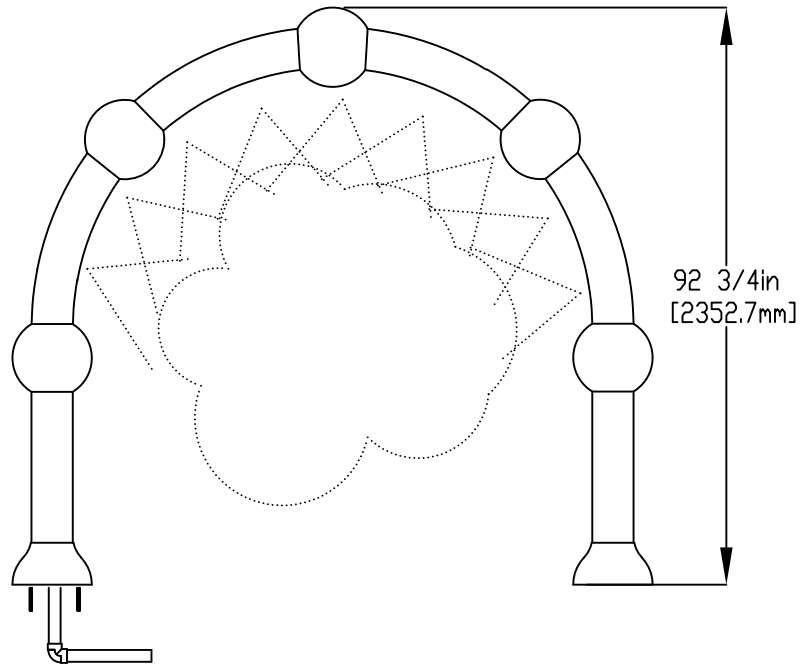

LOWER FLANGE COVER AFTER TOY IS INSTALLED.

1/2" (13mm) X 8" (203mm) 316SS
THREADED ROD C/W FENDER WASHER
LOCK WASHER & NUT (X4). MINIMUM
6" (152mm) EMBEDMENT, EPOXY SET
ANCHOR ADHESIVE
TO BE PROVIDED BY CONTRACTOR

ENSURE LEVEL & PLUMB
6" (152mm) X 1/8" (3mm) GASKET
INSTALLED UNDER FLANGE
TO BE PROVIDED BY EMPEX

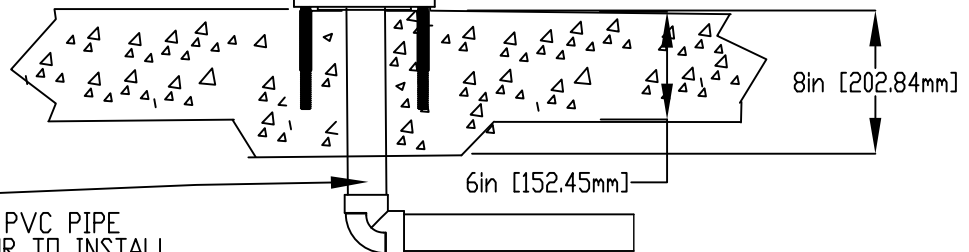

WATERFEED
2" PVC SCH 40 PVC PIPE
CUT CLOSE PRIOR TO INSTALL
TO ALLOW FULL DRAINAGE (WINTERIZATION)



Notes: Overall dimensions of toys are approximate.
Approximate Weight: 150lbs / 68.2kgs

© EMPEX WATERTOYS

WATER SUPPLY

35 gpm @ 25 psi
2.21L/S @17.5m

AQUAROLO

AD810

10/02/2022

SCALE:

Sheet
1 of 1