

NOTES:

(1) PURGE ALL WATER SUPPLY LINES TO REMOVE SOLIDS PRIOR TO TOY INSTALLATION.

(2) PROVIDE ELECTRICAL BOND WITH POOL REBAR.

(3) INSTALL ALL WATER TOYS PLUMB AND LEVEL.

(4) PROVIDE STRAINER UPSTREAM OF TOY WITH MAX 1/32" (0.81mm) PERFORATIONS.

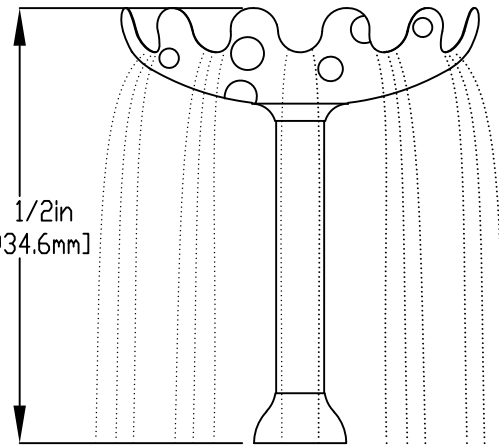
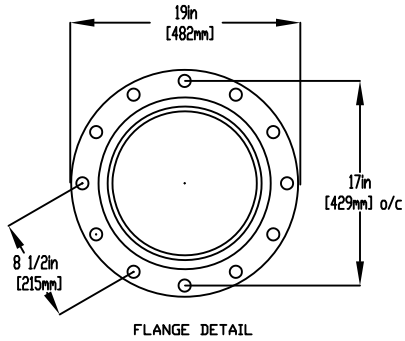
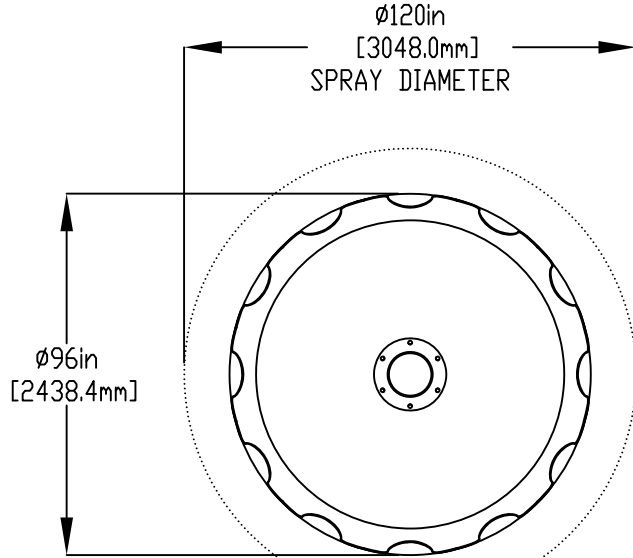

LOWER FLANGE COVER AFTER TOY IS INSTALLED.

5/8" (16mm) X 9" (230mm) 316SS THREADED ROD C/W FENDER WASHER, LOCK WASHER & NUT (X6), MINIMUM 6" (152mm) EMBEDMENT, EPOXY SET ANCHOR ADHESIVE TO BE PROVIDED BY CONTRACTOR

GRANULAR BASE

WATER FEED 4" (100mm) PVC SCH 40 PIPE CUT CLOSE TO ALLOW FOR FULL DRAINAGE (WINTERIZATION)

ENSURE LEVEL SURFACE. INSTALL $\phi 12"$ X $1/8"$ GASKET UNDER COLUMN PIPE FLANGE.

8- #4 @ 10" (250mm) EACH WAY

4- #4 @ 10" (250mm) EACH WAY

6in [152]

8in [203]

35in [889]

16in [406.4mm]

Notes: Overall dimensions of toys are approximate. Approximate Weight: 376lbs \170.9kgs

© EMPEX WATERTOYS



WATER SUPPLY

400 gpm @ 10 psi
25.3 L/S @ 7 m

AQUAFOUNTAIN DOLCE

AD898

11/02/2022

SCALE:

Sheet 1 of 1