

1

2

3

4

NOTES:

- (1) PURGE ALL WATER SUPPLY LINES TO REMOVE SOLIDS PRIOR TO TOY INSTALLATION.
- (2) PROVIDE ELECTRICAL BOND WITH POOL REBAR.
- (3) INSTALL ALL WATER TOYS PLUMB AND LEVEL.
- (4) PROVIDE STRAINER UPSTREAM OF TOY WITH MAX 1/32" (0.8mm) PERFORATIONS.

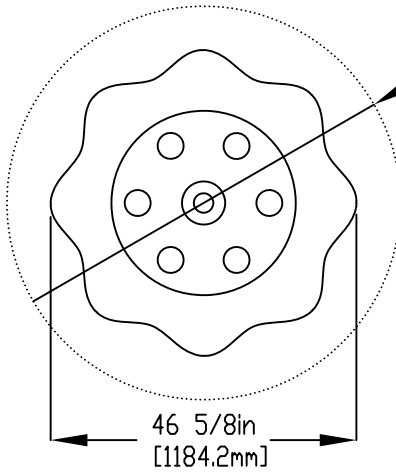

ø60in
[ø1524.0mm]
SPRAY AREA

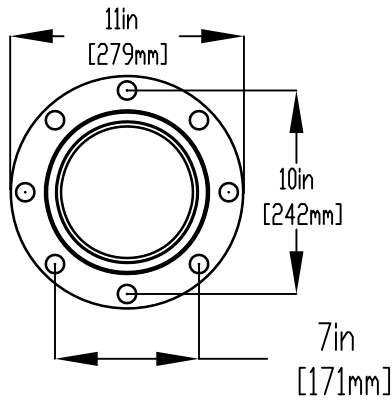

FLANGE DETAIL

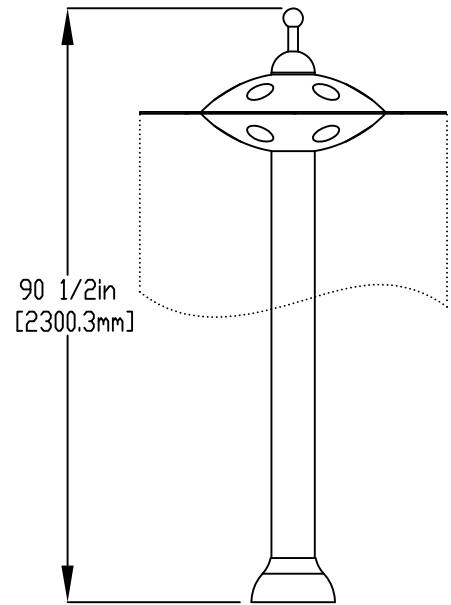

LOWER FLANGE COVER
AFTER TOY IS INSTALLED.

5/8" (16mm) X 8" (203mm) 316SS
THREADED ROD, C/W FENDER WASHER
LOCK WASHER, & NUT, (X6), MINIMUM
6" (152mm) EMBEDMENT, EPOXY SET
ANCHOR ADHESIVE
TO BE PROVIDED BY CONTRACTOR

FLOODED COLUMN
ENSURE LEVEL & PLUMB
ø 6" (152mm) X 1/8" (3mm) GASKET
INSTALLED UNDER FLANGE.
TO BE PROVIDED BY EMPEX

8- #4 @ 10" (250mm) EACH WAY
4- #4 @ 10" (250mm) EACH WAY

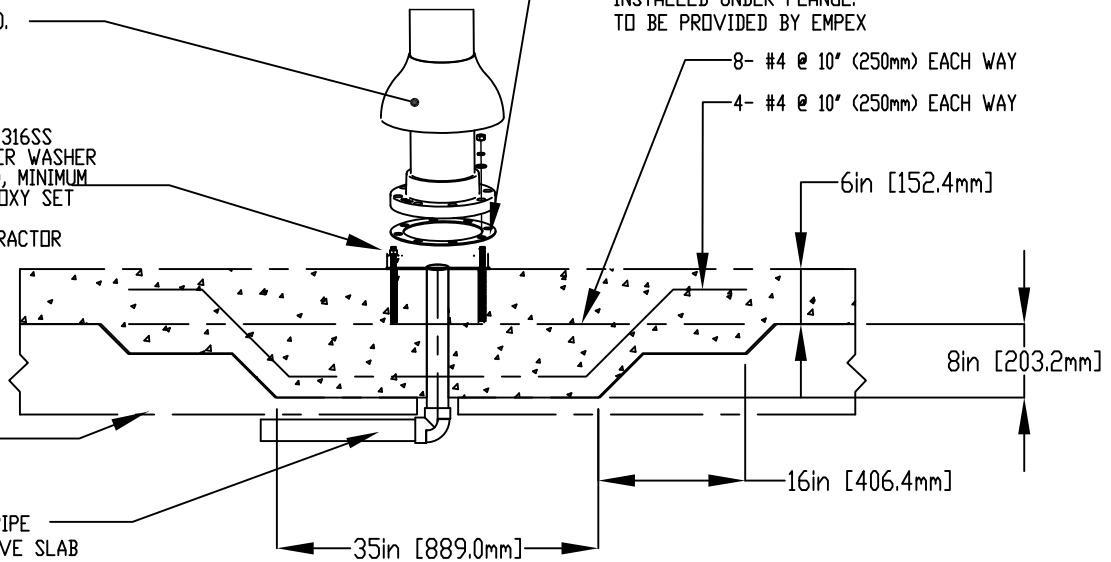

GRANULAR
BASE

WATERFEED
2" (50mm) PVC SCH 40 PIPE
EXTENDED 6" (152mm) ABOVE SLAB

A

A

B

B

C

C

D

D

E

E

F

F



Notes: Overall dimensions of toys are approximate.

© EMPEX WATERTOYS

WATER SUPPLY
70 gpm @ 10 psi
4.4 L/S @ 7m

AQUASAUCER

AG107

15/05/2020

SCALE:

Sheet
1 of 1

1

2

3

4