

1

2

3

4

NOTES:

- (1) PURGE ALL WATER SUPPLY LINES TO REMOVE SOLIDS PRIOR TO TOY INSTALLATION.
- (2) PROVIDE ELECTRICAL BOND WITH POOL REBAR.
- (3) INSTALL ALL WATER TOYS PLUMB AND LEVEL.
- (4) PROVIDE STRAINER UPSTREAM OF TOY WITH MAX $\frac{1}{32}$ " (0.8mm) PERFORATIONS.

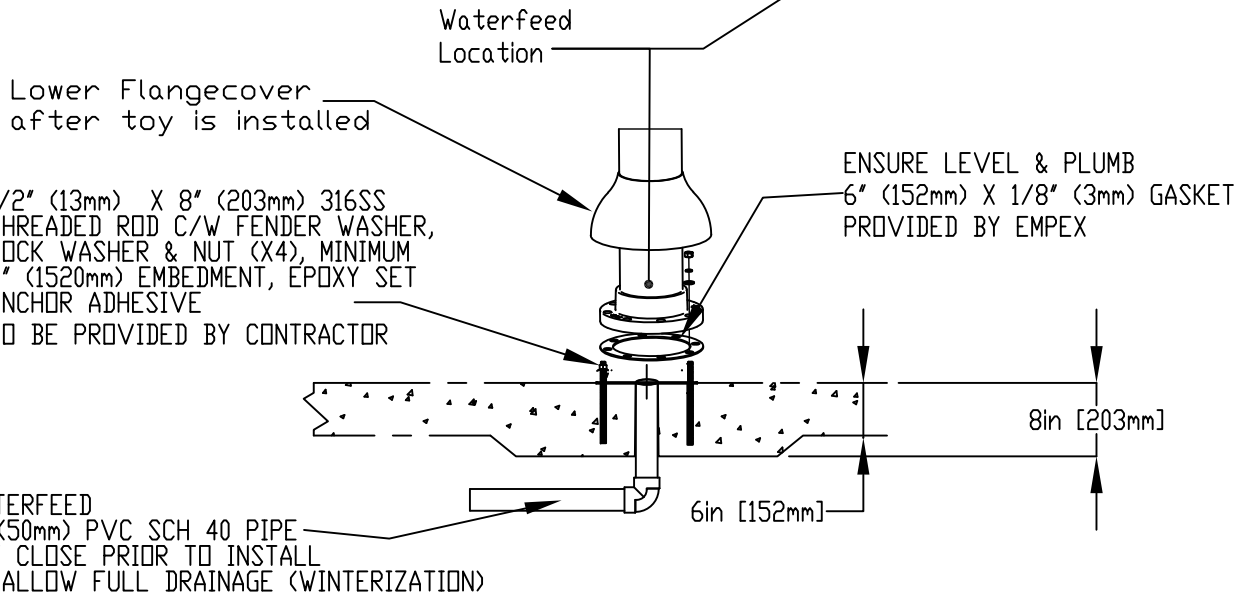
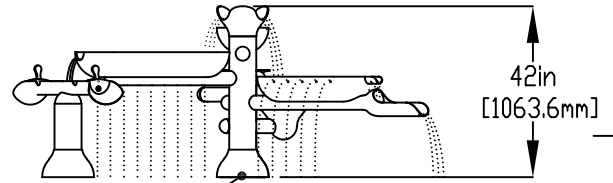
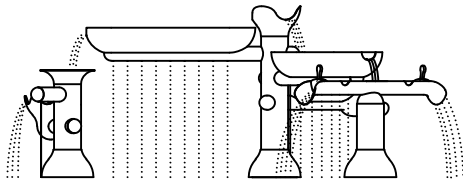
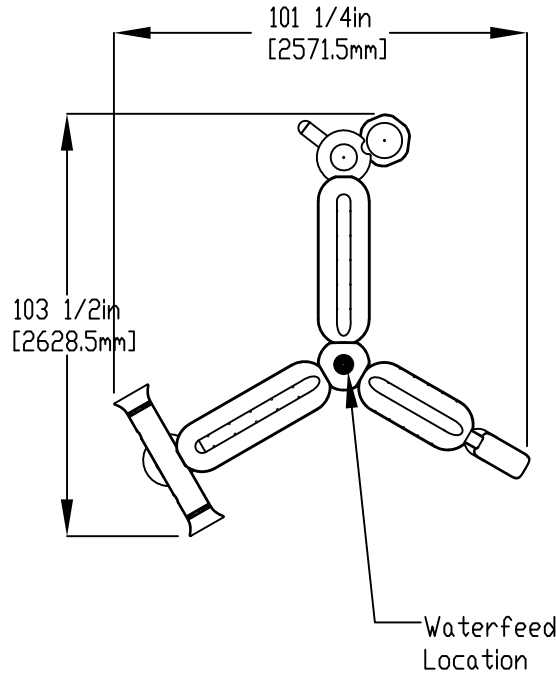
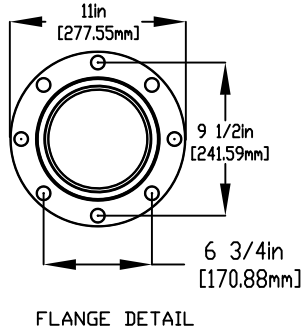

Notes: Overall dimensions of toys are approximate.
Approximate Weight: 136lbs / 61.8kgs

© EMPEX WATERTOYS

WATER SUPPLY

40 gpm @ 25 psi
2.5 L/S @17.5m

AQUALAB

AL106

12/04/2021

SCALE:

Sheet
1 of 1

1

2

3

4