

NOTES:

(1) PURGE ALL WATER SUPPLY LINES TO REMOVE SOLIDS PRIOR TO TOY INSTALLATION.

(2) PROVIDE ELECTRICAL BOND WITH POOL REBAR.

(3) INSTALL ALL WATER TOYS PLUMB AND LEVEL.

(4) PROVIDE STRAINER UPSTREAM OF TOY WITH MAX 1#32" (0.8mm) PERFORATIONS.

A

B

C

D

E

F

A

B

C

D

E

F

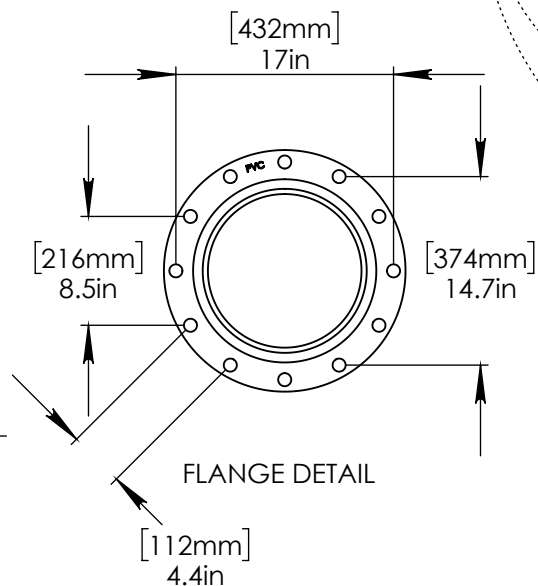
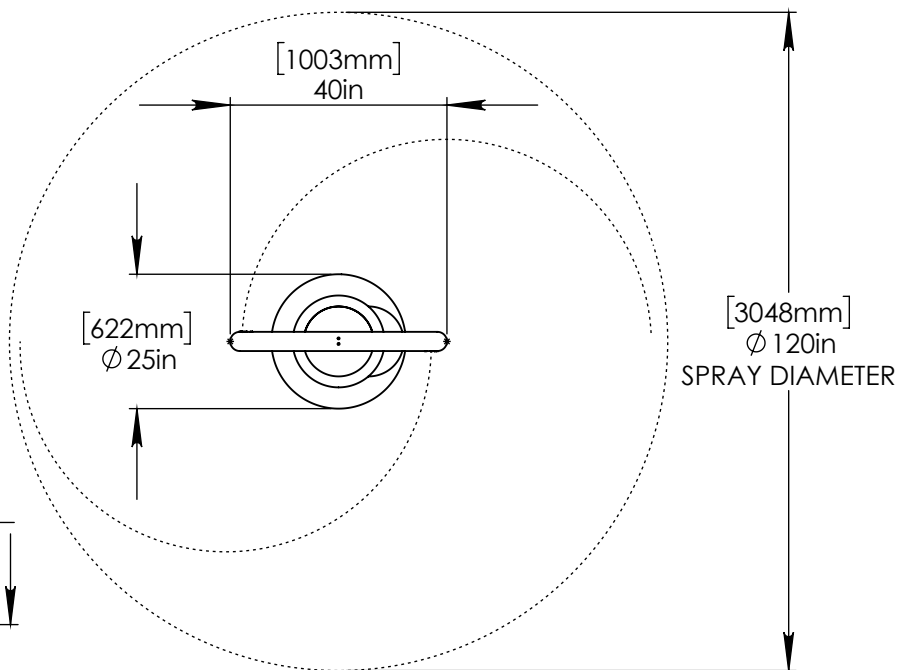

FLANGE DETAIL

1" (25mm) FLEX HOSE PROVIDED BY EMPEX

2" (50mm) TO 1" (25mm) REDUCER TO BE PROVIDED BY CONTRACTOR.

LOWER FLANGE COVER AFTER INSTALL.

STAINLESS STEEL (316) Ø 5/8" (16mm) THREADED ROD, WASHER, LOCK WASHER, & NUT. 9" (230mm) THREADED ROD LENGTH WITH 6" (150mm) EMBEDMENT.

2" (50mm) PVC SCH 40 WATERFEED EXTENDED 8" (200mm) ABOVE SLAB.

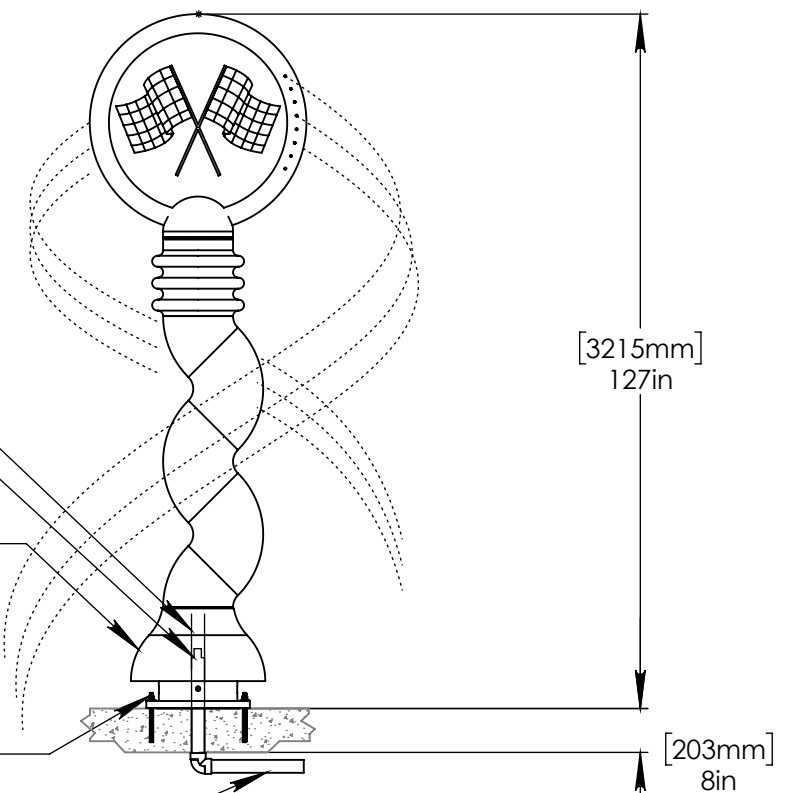

Notes: Overall dimensions of toys are approximate.

© EMPEX WATERTOYS

**WATER SUPPLY**

30 gpm @ 25 psi
1.89L/S @ 17.5m

AQUATWIRL RACER

AS105

1/3/2019

SCALE:
1:35

Sheet
1 of 1