

NOTES:

- (1) PURGE ALL WATER SUPPLY LINES TO REMOVE SOLIDS PRIOR TO TOY INSTALLATION.
- (2) PROVIDE ELECTRICAL BOND WITH POOL REBAR.
- (3) INSTALL ALL WATER TOYS PLUMB AND LEVEL.
- (4) PROVIDE STRAINER UPSTREAM OF TOY WITH MAX 1#32" (0.8mm) PERFORATIONS.

WATER PATTERN, SPRAY DIAMETER

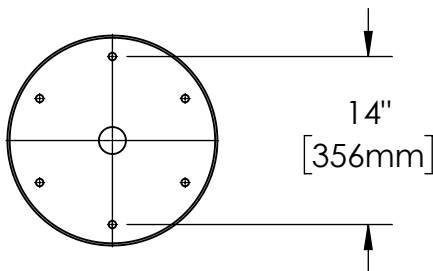
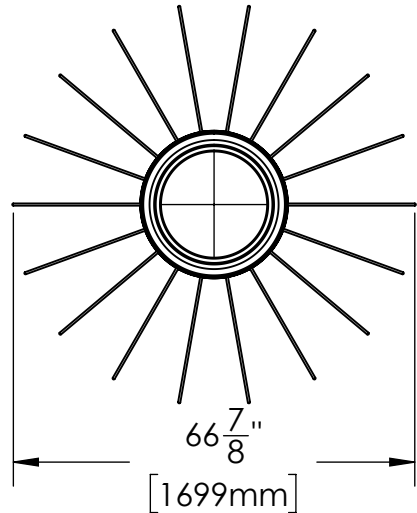

BASE DETAIL

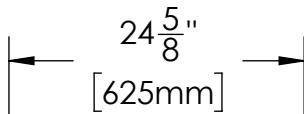
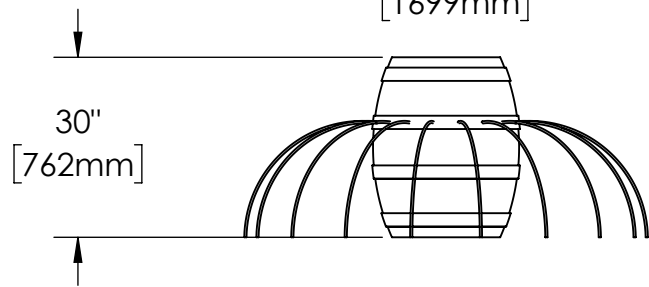

2"(50mm) TO 1"(25mm) REDUCER+CLAMP TO BE SUPPLIED BY CONTRACTOR

1"(25mm) HOSE SUPPLIED BY EMPEX

BASE

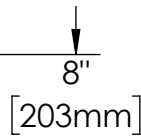

2"(50mm) PVC SCH 40 PIPE EXTENDED 4"(100mm) ABOVE POOL SLAB

1/2"(13mm) STAINLESS (316) THREADED ROD, WASHER, LOCK WASHER, & NUT. SUGGESTED 6"(150mm) THREADED ROD WITH 4"(100mm) EMBEDMENT.



Notes: Overall dimensions of toys are approximate.

© EMPEX WATERTOYS

WATER SUPPLY

45 gpm @ 25 psi  
2.84 L/S @ 17.5m

AQUABARREL

**AW102**

1/28/2021

SCALE:

Sheet 1 of 1