

NOTES:

(1) PURGE ALL WATER SUPPLY LINES TO REMOVE SOLIDS PRIOR TO TOY INSTALLATION.

(2) PROVIDE ELECTRICAL BOND WITH POOL REBAR.

(3) INSTALL ALL WATER TOYS PLUMB AND LEVEL.

(4) PROVIDE STRAINER UPSTREAM OF TOY WITH MAX 1/32" (0.8mm) PERFORATIONS.

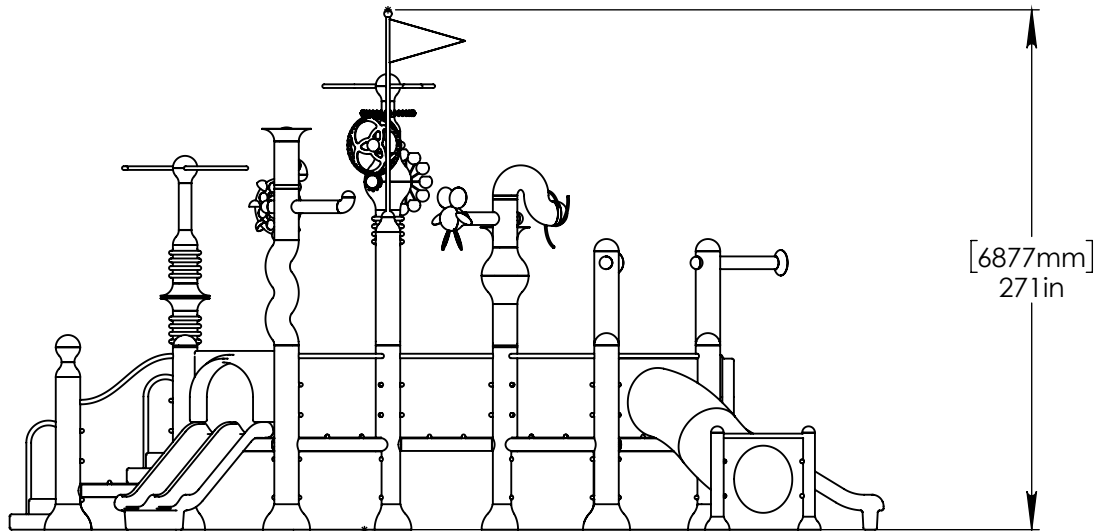
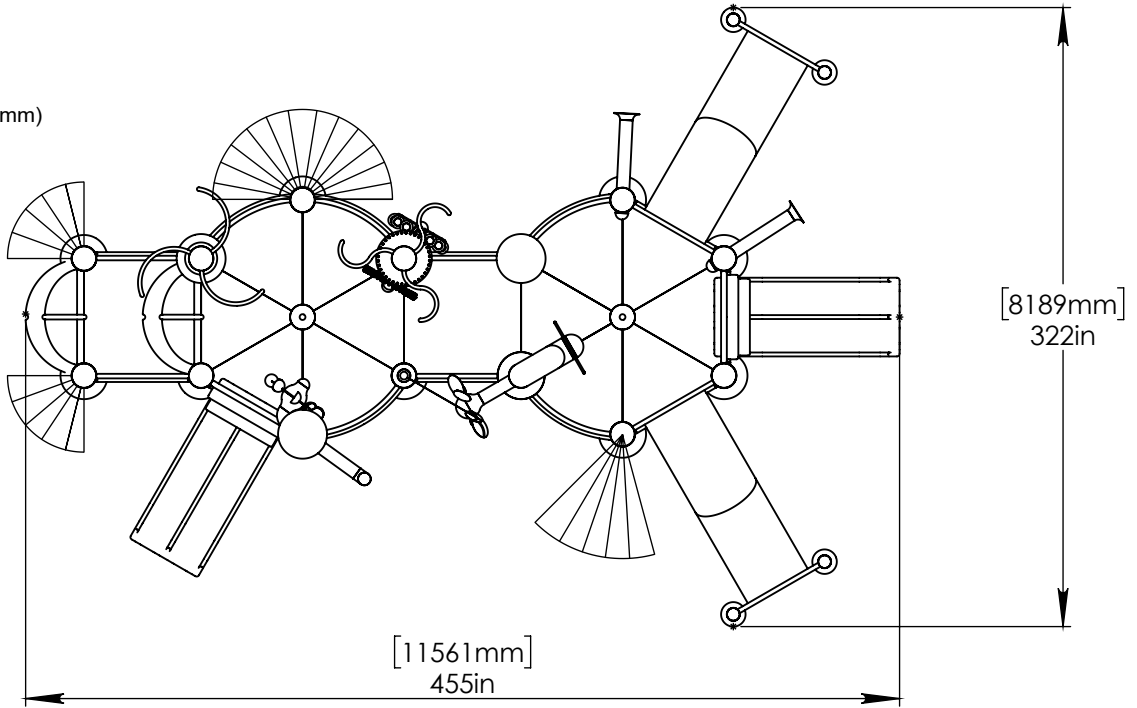

Notes: Overall dimensions of toys are approximate.

© EMPEX WATERTOYS



WATER SUPPLY
 460 gpm @ 25 psi
 29L/S @17.5m

AQUADEK

C410-4S

7/20/2016

SCALE:
1:2

Sheet
1 of 2

A

A

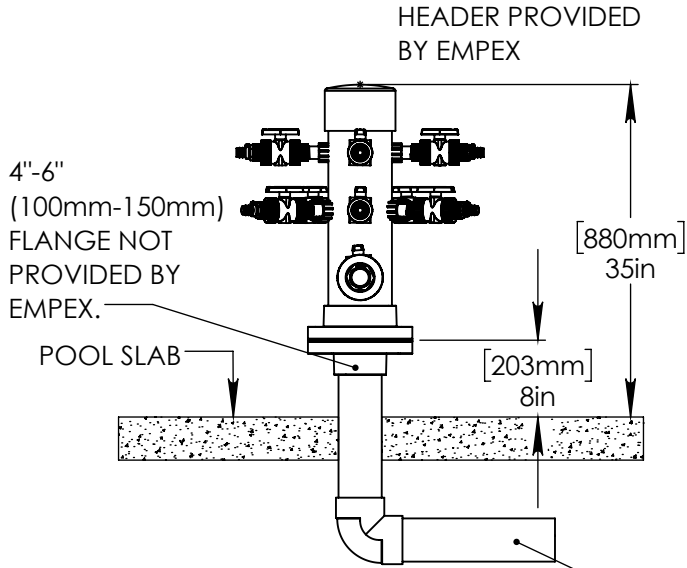

- (2) 2" (50mm) VALVES:
(2) AQUAFALLS
- (9) 1" (25mm) VALVES:
AQUASWIRL
AQUAWIZZ
AQUANOODLE
AQUAMILL
AQUASHROOM
(2) FINGERSHOOTERS
(2) FINIALS

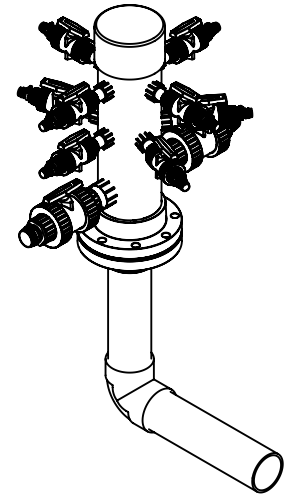

6" (150mm) PVC SCH 40 WATERFEED.

B

B

C

C

D

D

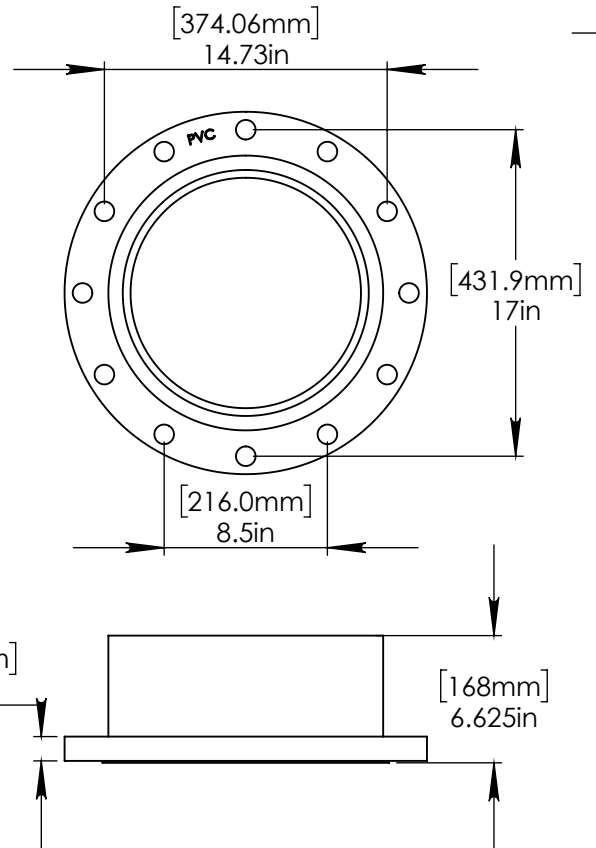
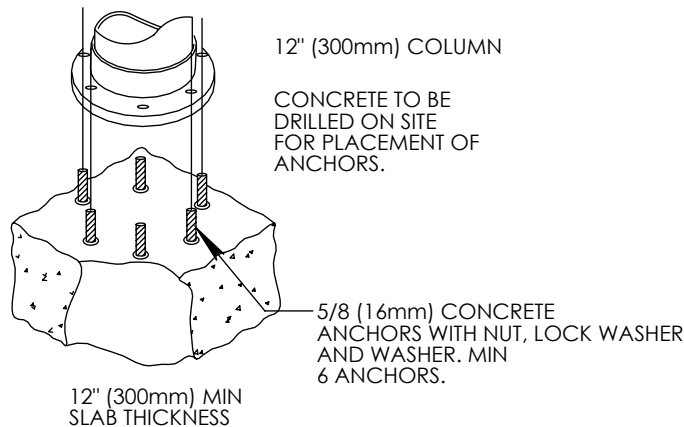

E

E

F

F



Notes: Overall dimensions of toys are approximate.

© EMPEX WATERTOYS

WATER SUPPLY
460 gpm @ 25 psi
29L/S @17.5m

AQUADEK

C410-4S

7/20/2016

SCALE:
1:20

Sheet
2 of 2