

NOTES:

(1) PROVIDE ELECTRICAL BOND WITH POOL REBAR.

(2) 2 PART EPOXY MAY BE USED IN LIEU OF INSERT ANCHOR.

(3) PURGE ALL WATER SUPPLY LINES TO REMOVE SOLIDS PRIOR TO TOY INSTALLATION.

(4) INSTALL ALL WATER TOYS PLUMB AND LEVEL.

(5) PROVIDE STRAINER UPSTREAM OF TOY WITH MAX 1#32" (0.8mm) PERFORATIONS.

A

B

C

D

E

F

A

B

C

D

E

F

[8157mm]
321in

[7740mm]
305in

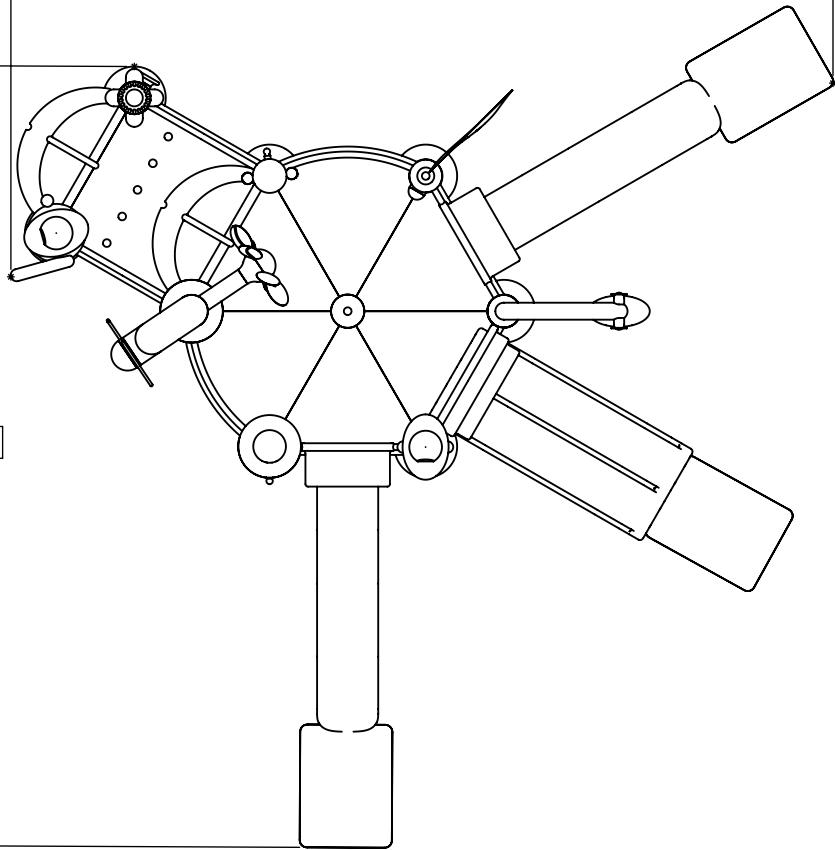

[6187mm]
244in

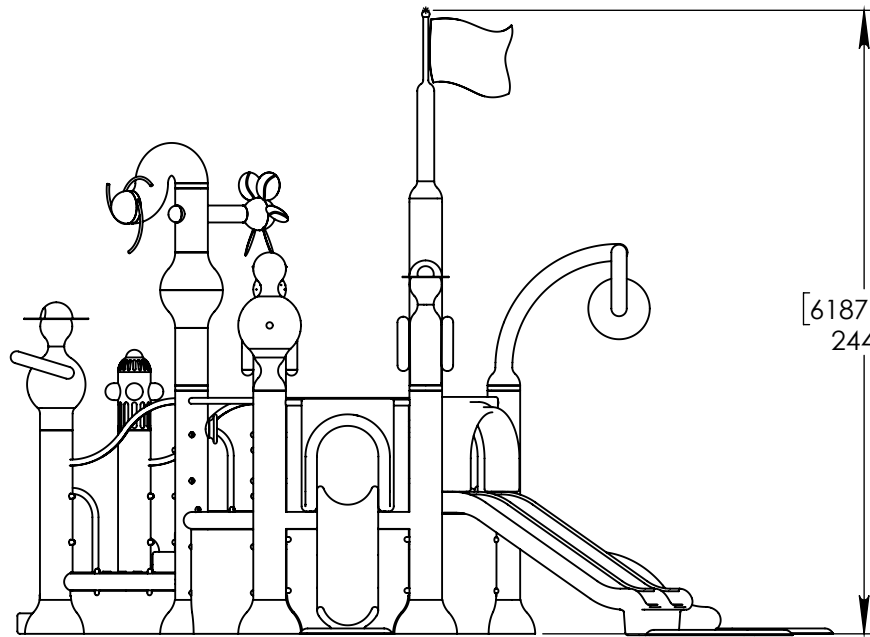

Notes : (1) Dual Dimensions
(2) Outer dimensions of toys are approximate.

© EMPEX WATER TOYS
JAN 24, 2017

Scale
N.T.S.



WATER SUPPLY

250 gpm @ 25 psi
15.6L/S @17.5m

AQUADEK

C410-F-3S

Edition

Sheet
1/2

A

A

B

B

C

C

(1) 1.5" (38mm) VALVES:
FLAG POLE

(7) 1" (25mm) VALVES:
DEK JETS
AQUAWIZZ
(5) AQUATOTS

(1) 0.5" (13mm) VALVES:
AQUADUNK

4"-6"
(100mm-150mm)
FLANGE NOT
PROVIDED BY
EMPEX

POOL SLAB

[879mm]
35in

[203mm]
8in

4" (100mm) PVC SCH 40
WATERFEED

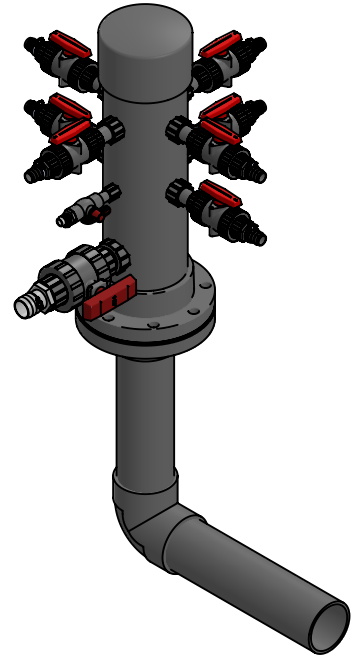

D

D

E

E

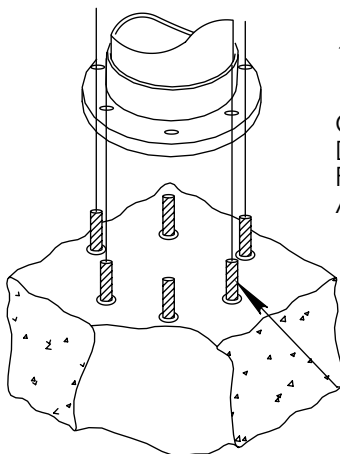

12" (300mm) COLUMN

CONCRETE TO BE
DRILLED ON SITE
FOR PLACEMENT OF
ANCHORS.

12" (300mm) MIN
SLAB THICKNESS

5/8 (16mm) CONCRETE
ANCHORS WITH NUT, LOCK WASHER
AND WASHER. MIN
6 ANCHORS.

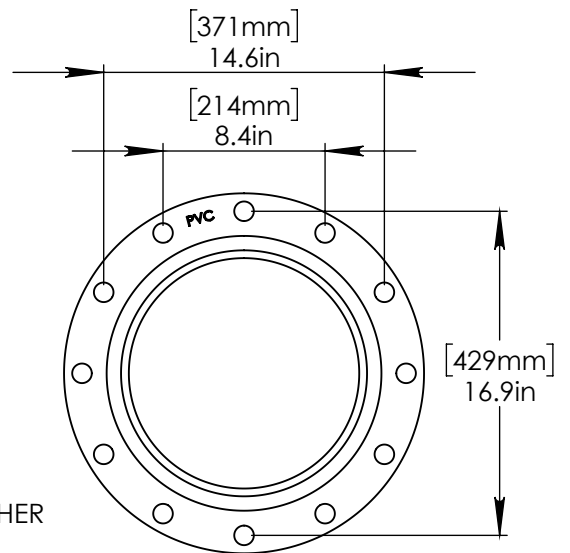

12" FLANGE

F

F



Notes : (1) Dual Dimensions
(2) Outer dimensions of toys are approximate.

C EMPEX WATER TOYS
JAN 24, 2017

Scale
N.T.S.

WATER SUPPLY

250 gpm @ 25 psi
15.6L/S @17.5m

AQUADEK

C410-F-3S

Edition

Sheet
2/2