

NOTES:

(1) PURGE ALL WATER SUPPLY LINES TO REMOVE SOLIDS PRIOR TO TOY INSTALLATION.

(2) PROVIDE ELECTRICAL BOND WITH POOL REBAR.

(3) INSTALL ALL WATER TOYS PLUMB AND LEVEL.

(4) PROVIDE STRAINER UPSTREAM OF TOY WITH MAX 1/32" (0.8mm) PERFORATIONS.

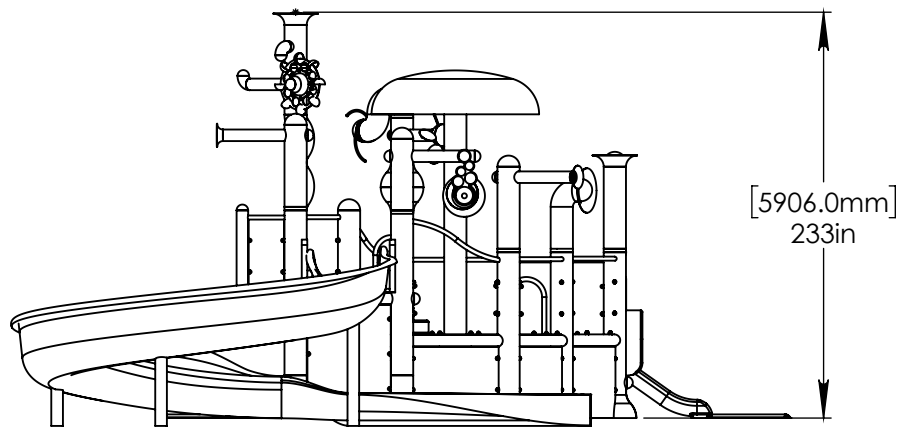
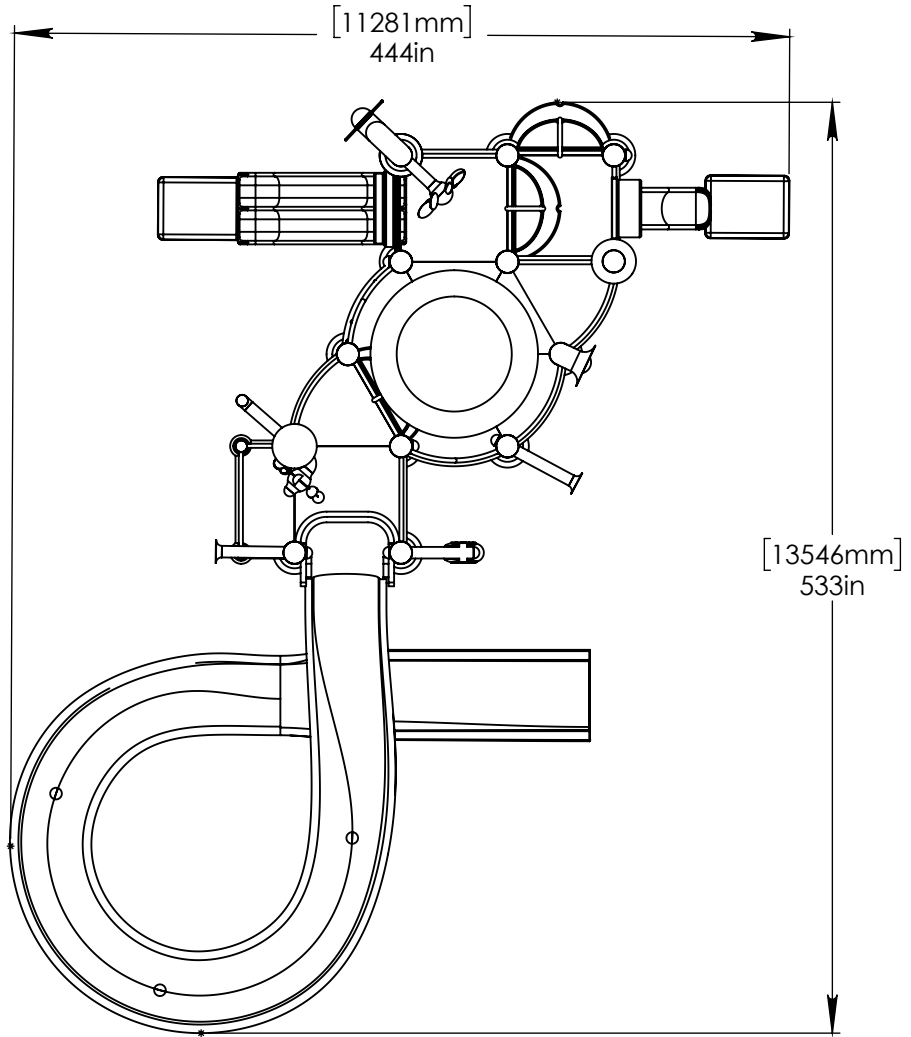

Notes: Overall dimensions of toys are approximate.

© EMPEX WATERTOYS

WATER SUPPLY

810 gpm @ 25 psi  
51.1L/S @ 17.5m

**AQUADEK**

**C610-246B**

1/26/2017

SCALE:  
1:110

Sheet  
1 of 3

# MANIFOLD A

HEADER TO BE SUPPLIED BY EMPEX

4"-6"  
(100mm-150mm)  
FLANGE NOT  
PROVIDED BY  
EMPEX

POOL SLAB

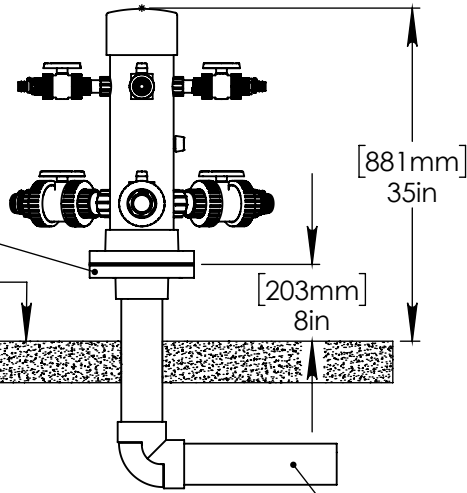

4" (100mm) PVC SCH 40  
WATERFEED

2" (150mm) VALVES:  
(3) AQUABRELLA

1.5" (138mm) VALVES:  
(1) AQUATUBA

1" (100mm) VALVES:  
(1) AQUASHROOM  
(1) AQUAWIZZ  
(2) FINEALS

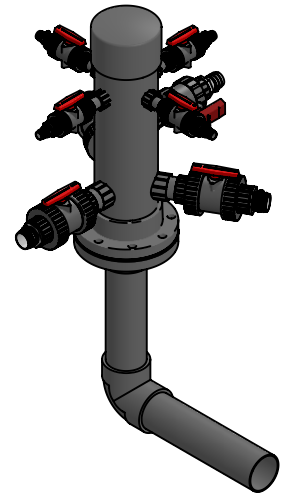

# MANIFOLD B

HEADER TO BE SUPPLIED BY EMPEX

6" (150mm)  
FLANGE NOT  
PROVIDED BY  
EMPEX

POOL SLAB

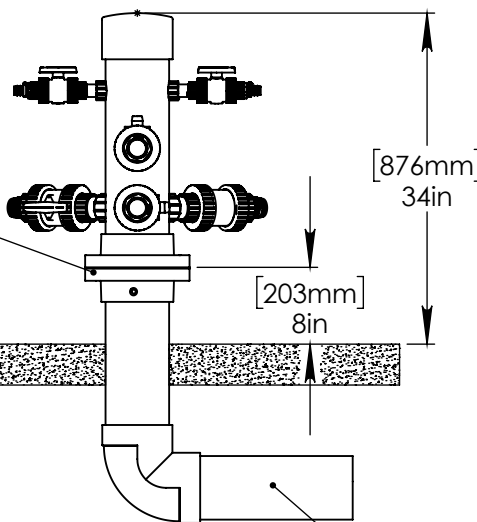

6" (150mm) PVC SCH 40  
WATERFEED

2" (150mm) VALVES:  
(3) 360° SLIDE  
(2) AQUAFALLS

1" (100mm) VALVES:  
(1) AQUACURTAIN  
(1) AQUANOODLE

0.5" (50mm) VALVES:  
(1) AQUADUNK

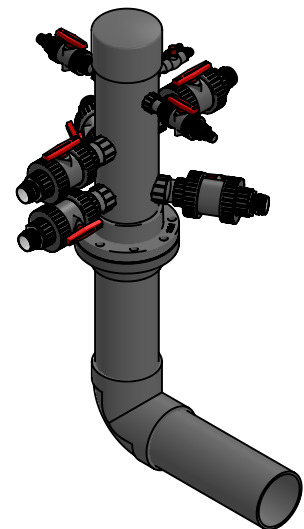

Notes: Overall dimensions of toys are approximate.

© EMPEX WATERTOYS

### WATER SUPPLY

810 gpm @ 25 psi  
51.1L/S @ 17.5m

## AQUADEK

**C610-246B**

1/26/2017

SCALE:  
1:20

Sheet  
2 of 3

A

A

B

B

C

C

D

D

E

E

F

F

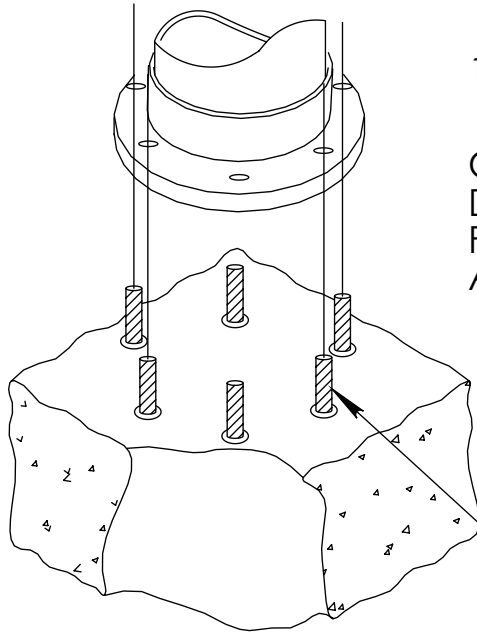

12" (300mm) COLUMN

CONCRETE TO BE DRILLED ON SITE FOR PLACEMENT OF ANCHORS.

5/8 (16mm) CONCRETE ANCHORS WITH NUT, LOCK WASHER AND WASHER. MIN 6 ANCHORS.

12" (300mm) MIN SLAB THICKNESS

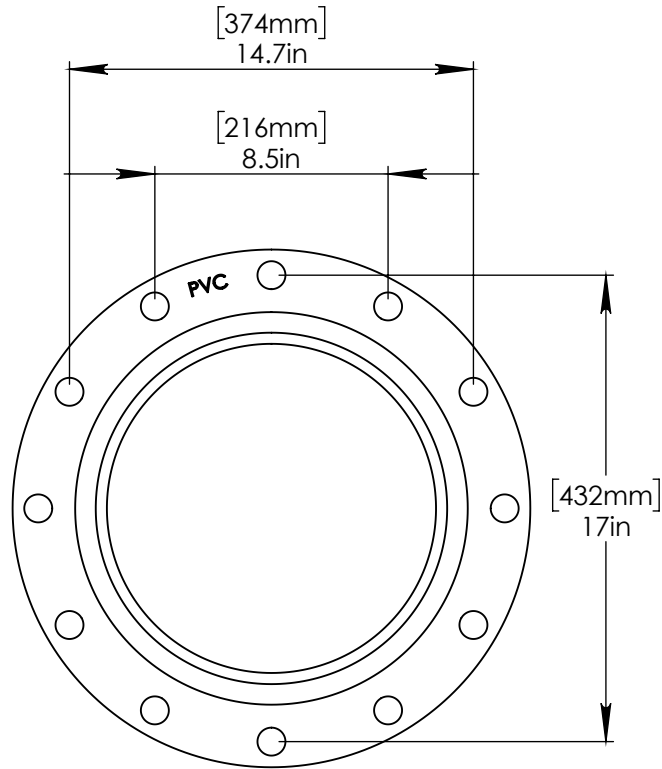

12" FLANGE



Notes: Overall dimensions of toys are approximate.

© EMPEX WATERTOYS

WATER SUPPLY

810 gpm @ 25 psi  
51.1L/S @ 17.5m

**AQUADEK**

**C610-246B**

1/26/2017

SCALE:  
1:10

Sheet  
3 of 3