

NOTES:

(1) PURGE ALL WATER SUPPLY LINES TO REMOVE SOLIDS PRIOR TO TOY INSTALLATION.

(2) PROVIDE ELECTRICAL BOND WITH POOL REBAR.

(3) INSTALL ALL WATER TOYS PLUMB AND LEVEL.

(4) PROVIDE STRAINER UPSTREAM OF TOY WITH MAX 1/32" (0.8mm) PERFORATIONS.

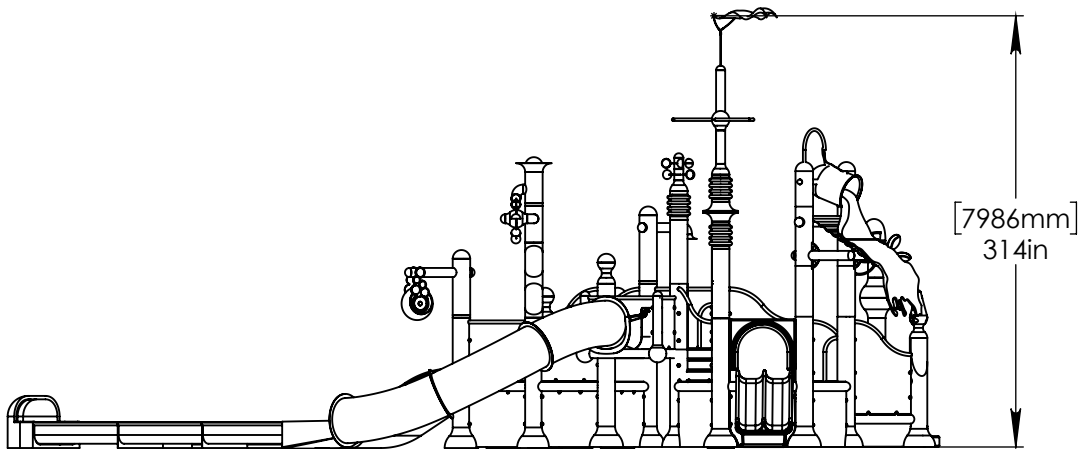
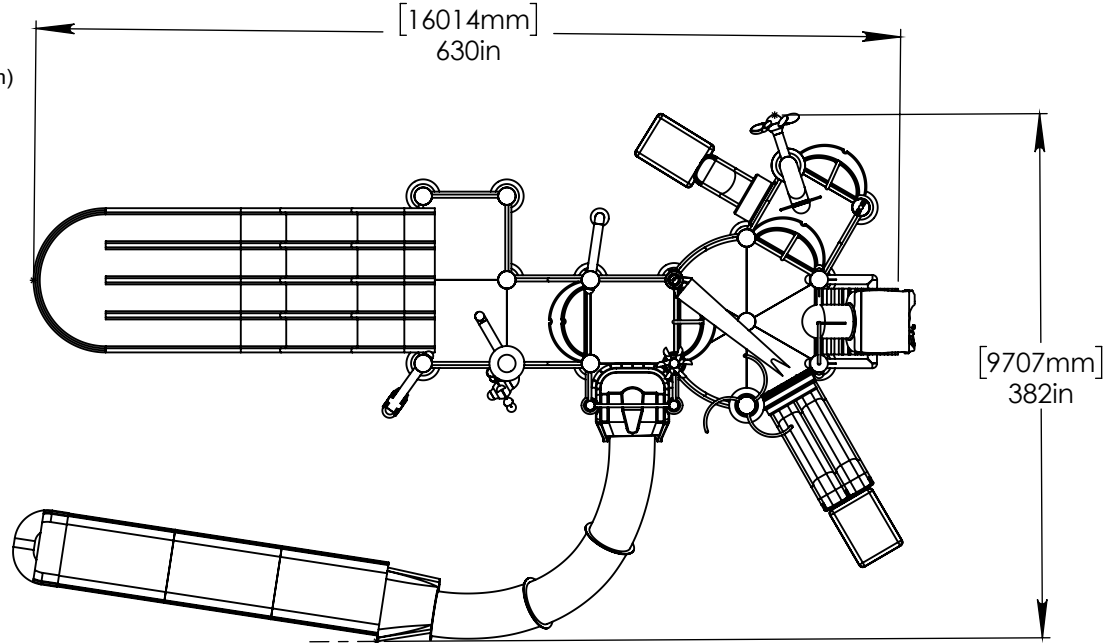

Notes: Overall dimensions of toys are approximate.

© EMPEX WATERTOYS

WATER SUPPLY

670 gpm @ 25 psi
42.2 L/S @17.5m

AQUADEK

C610-CR-1S-L

8/16/2016

SCALE:
1:140

Sheet
1 of 3

MANIFOLD A

HEADER PROVIDED BY EMPEX

- (4) 2" (50mm) VALVES:
- (3) FIBERGLASS SLIDE
- (1) AQUADUNKER

- (5) 1" (25mm) VALVES:
- AQUASWIRL
- AQUAWIZZ
- AQUACURTAIN
- AQUACLUNE
- AQUAFLAG

6" (150mm) FLANGE NOT PROVIDED BY EMPEX.

POOL SLAB

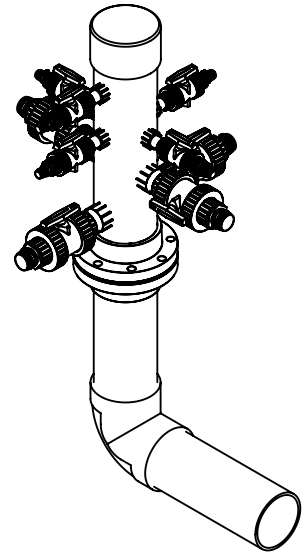
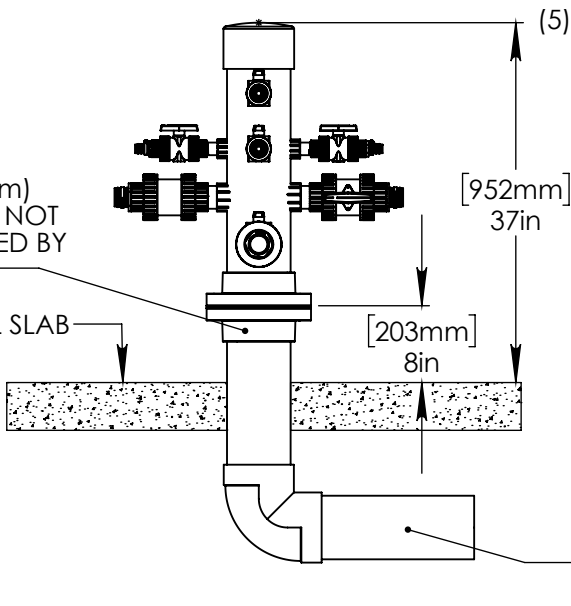

6" (150mm) PVC SCH 40 WATERFEED.

MANIFOLD B

HEADER PROVIDED BY EMPEX

- (2) 2" (50mm) VALVES:
- LARGE SLIDE

- (3) 1" (25mm) VALVES:
- AQUANOODLE
- (2) FINIAL

- (1) 0.5" (13mm) VALVES:
- AQUADUNK

6" (150mm) FLANGE NOT PROVIDED BY EMPEX.

POOL SLAB

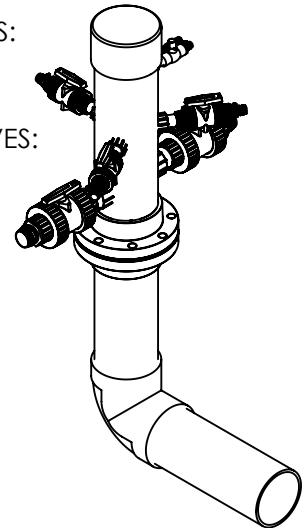
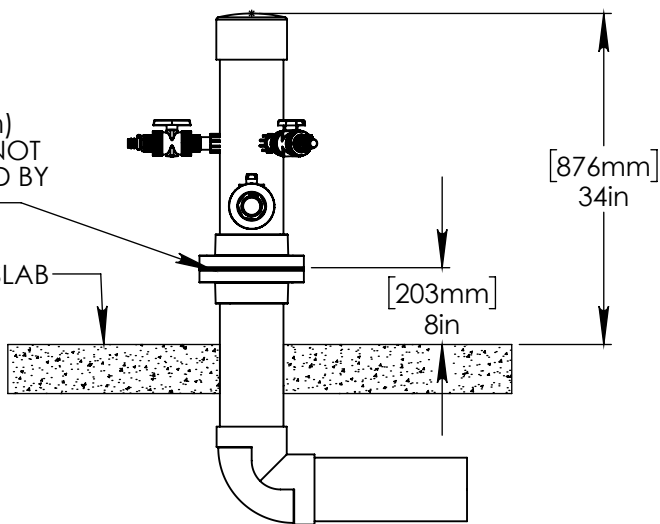

Notes: Overall dimensions of toys are approximate.

© EMPEX WATERTOYS

WATER SUPPLY

670 gpm @ 25 psi
42.2 L/S @ 17.5m

AQUADEK

C610-CR-1S-L

8/16/2016

SCALE:
1:20

Sheet
2 of 3

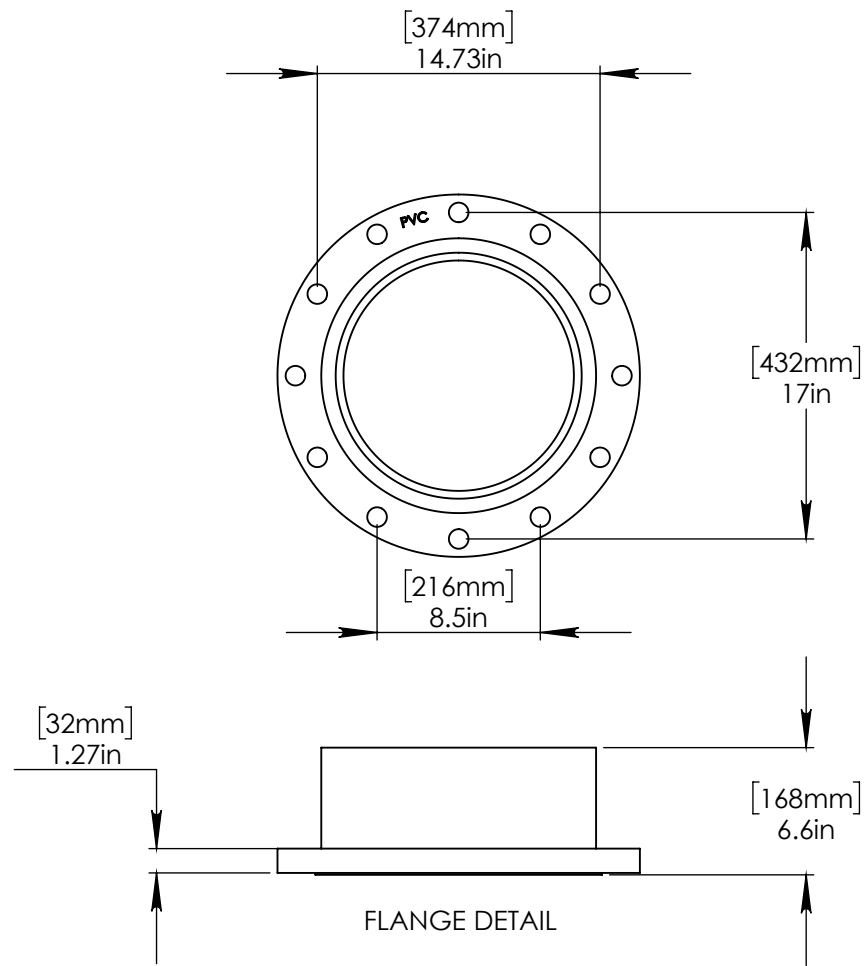
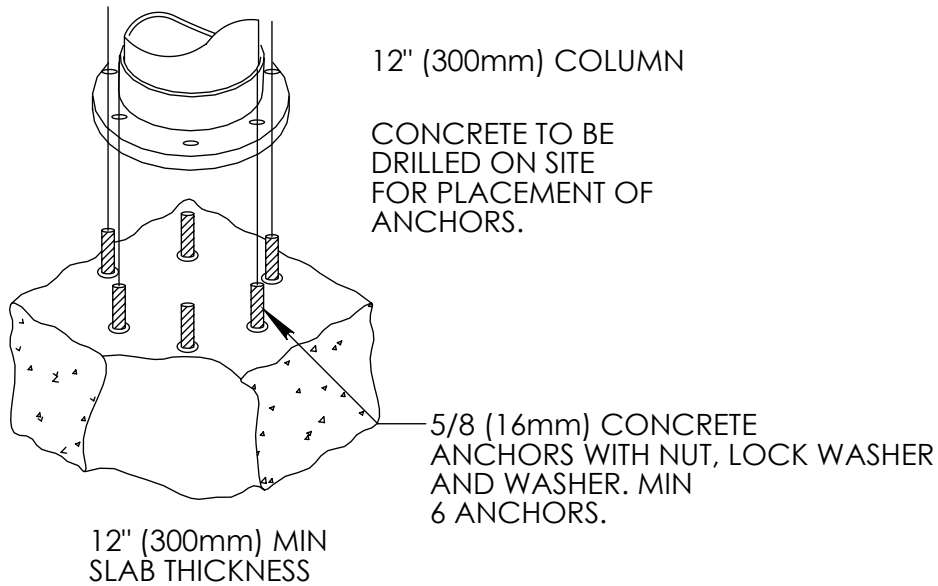

Notes: Overall dimensions of toys are approximate.

© EMPEX WATERTOYS

WATER SUPPLY
670 gpm @ 25 psi
42.2 L/S @ 17.5m

AQUADEK

C610-CR-1S-L

8/16/2016

SCALE:
1:10

Sheet
3 of 3