

NOTES:

(1) PURGE ALL WATER SUPPLY LINES TO REMOVE SOLIDS PRIOR TO TOY INSTALLATION.

(2) PROVIDE ELECTRICAL BOND WITH POOL REBAR.

(3) INSTALL ALL WATER TOYS PLUMB AND LEVEL.

(4) PROVIDE STRAINER UPSTREAM OF TOY WITH MAX 1/32" (0.8mm) PERFORATIONS.

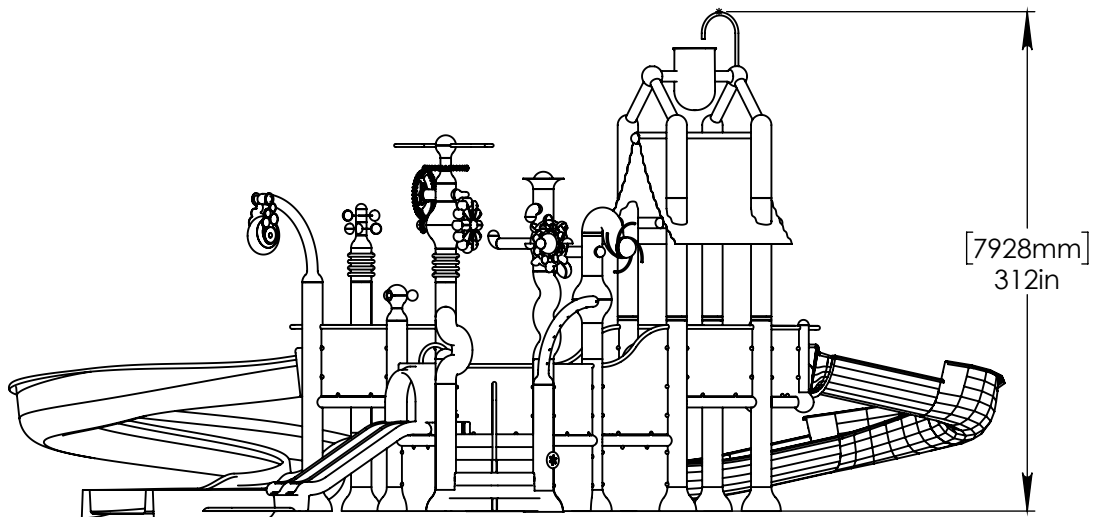
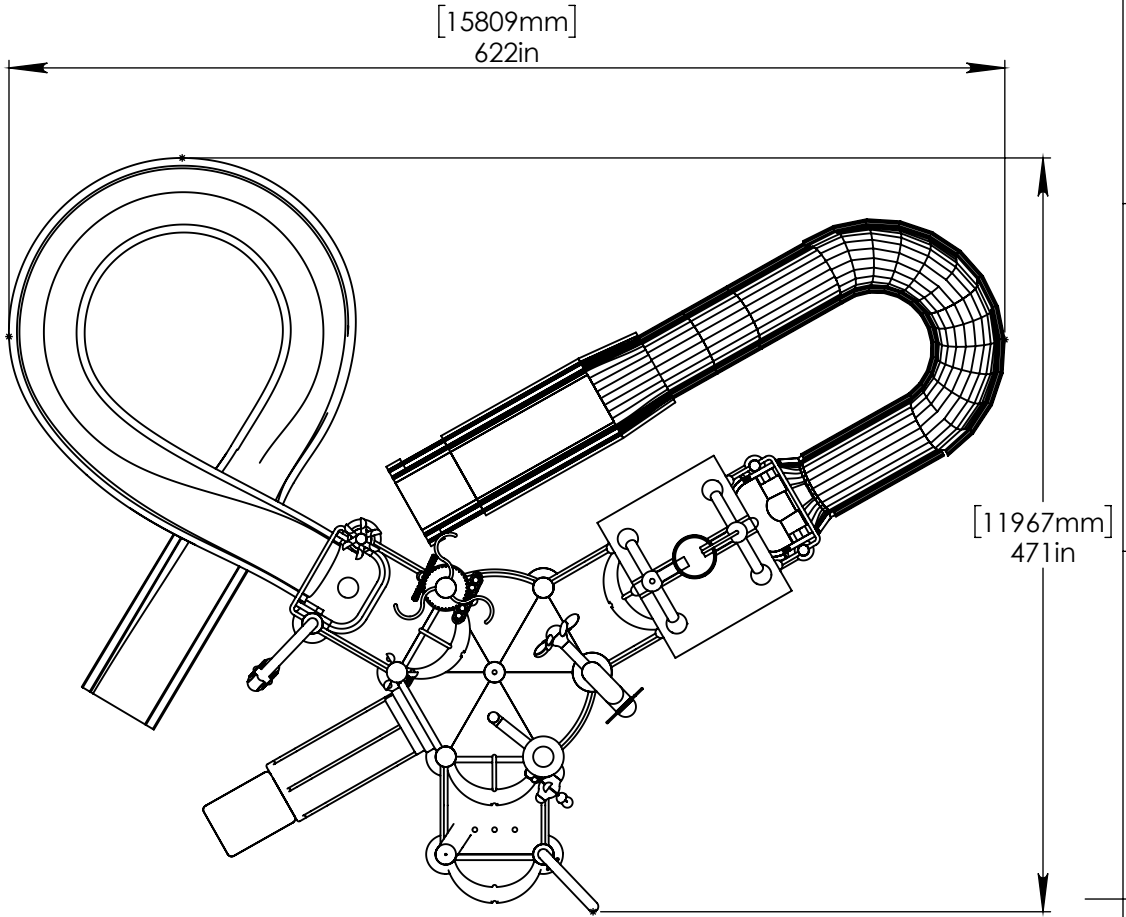

Notes: Overall dimensions of toys are approximate.

© EMPEX WATERTOYS



WATER SUPPLY

740 gpm @ 25 psi
46.7 L/S @17.5m

AQUADEK

C610-CR-2SD24

2/3/2017

SCALE:
1:120

Sheet
1 of 3

MANIFOLD A

4"-6"
(100mm-150mm)
FLANGE NOT
PROVIDED BY
EMPEX

POOL SLAB

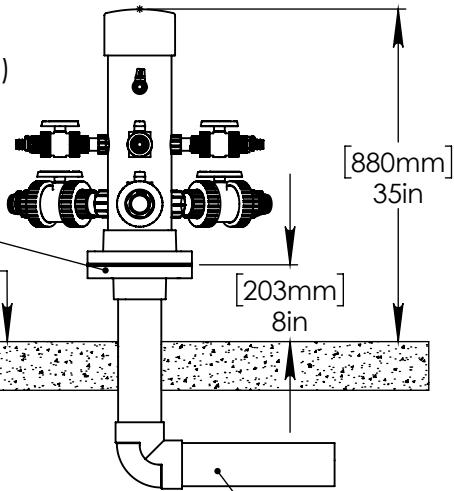

4" (100mm) PVC SCH 40
WATERFEED

- (3) 2" (50mm) VALVES:
(3) WATERSLIDE
- (4) 1" (25mm) VALVES:
(1) AQUACURTAIN
(1) AQUAMILL
(1) AQUAJOG
(1) VERTICAL JETS
- (1) 0.5" (13mm) VALVES:
(1) AQUADUNK

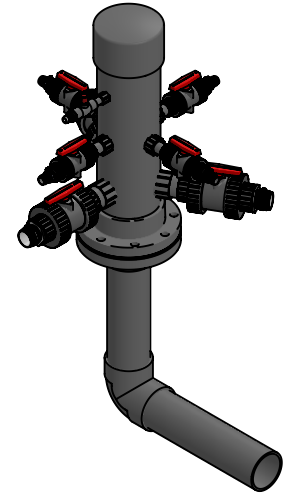

MANIFOLD B

4"-6"
(100mm-150mm)
FLANGE NOT
PROVIDED BY
EMPEX

POOL SLAB

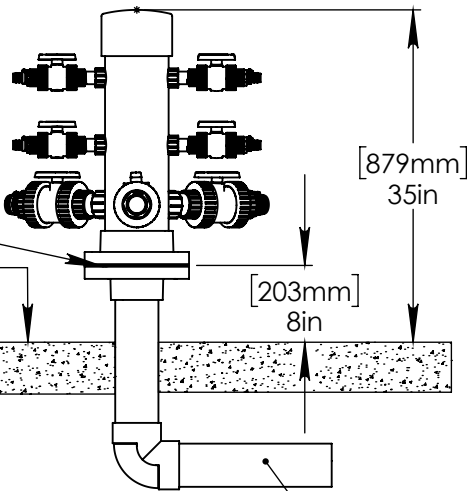

4" (100mm) PVC SCH 40
WATERFEED

- (4) 2" (50mm) VALVES:
(3) WATERSLIDE
(1) AQUADUNKER
- (4) 1" (25mm) VALVES:
(1) AQUACURTAIN
(1) AQUABEND
(1) AQUANOODLE
(1) AQUAWIZZ

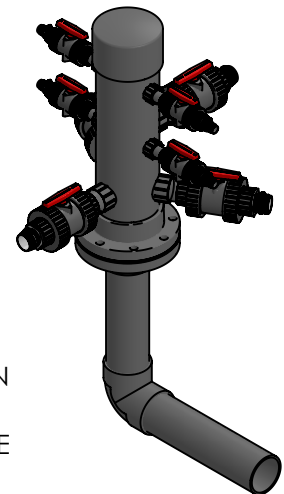

Notes: Overall dimensions of toys are approximate.

© EMPEX WATERTOYS



WATER SUPPLY

740 gpm @ 25 psi
46.7 L/S @ 17.5m

AQUADEK

C610-CR-2SD24

2/3/2017

SCALE:
1:20

Sheet
2 of 3

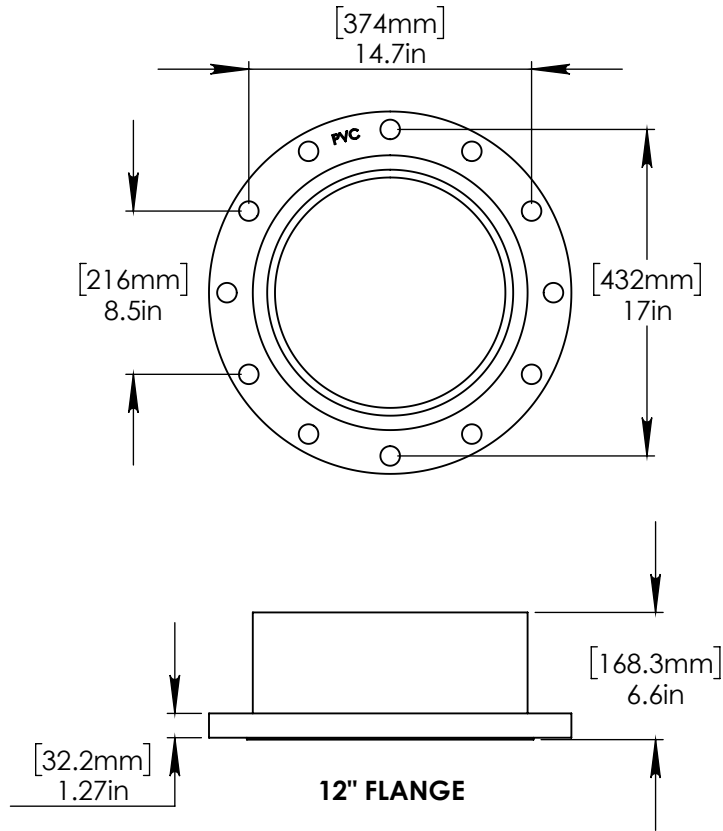
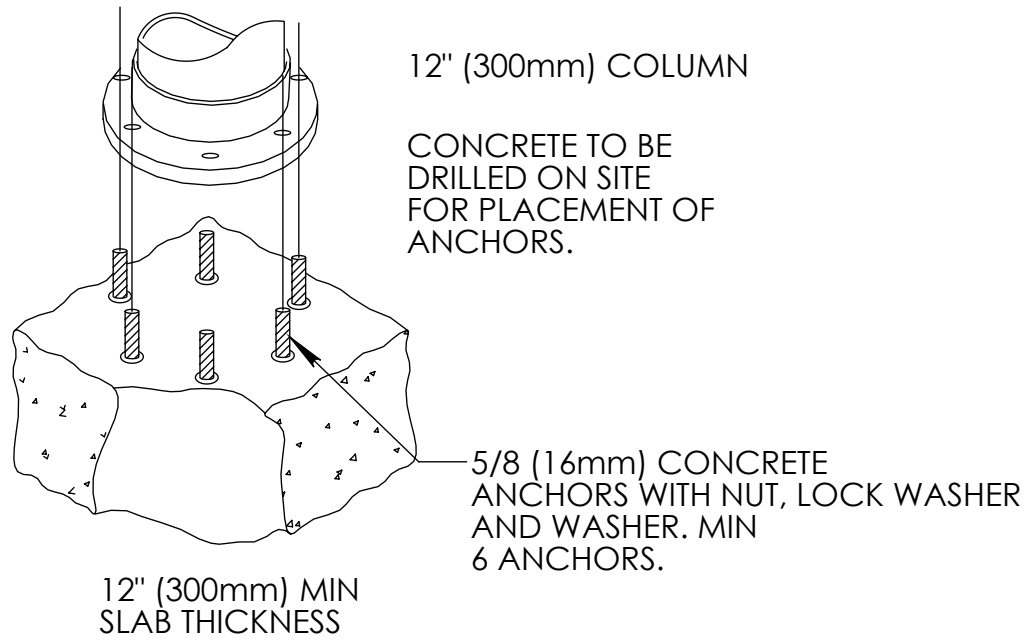

Notes: Overall dimensions of toys are approximate.

© EMPEX WATERTOYS

WATER SUPPLY

740 gpm @ 25 psi
46.7 L/S @ 17.5m

AQUADEK

C610-CR-2SD24

2/3/2017

SCALE:
1:10

Sheet
3 of 3