

1

2

3

4

NOTES:

- (1) PURGE ALL WATER SUPPLY LINES TO REMOVE SOLIDS PRIOR TO TOY INSTALLATION.
- (2) PROVIDE ELECTRICAL BOND WITH POOL REBAR.
- (3) INSTALL ALL WATER TOYS PLUMB AND LEVEL.
- (4) PROVIDE STRAINER UPSTREAM OF TOY WITH MAX PERFORATIONS. #32" (0.8mm)

A

A

B

B

C

C

D

D

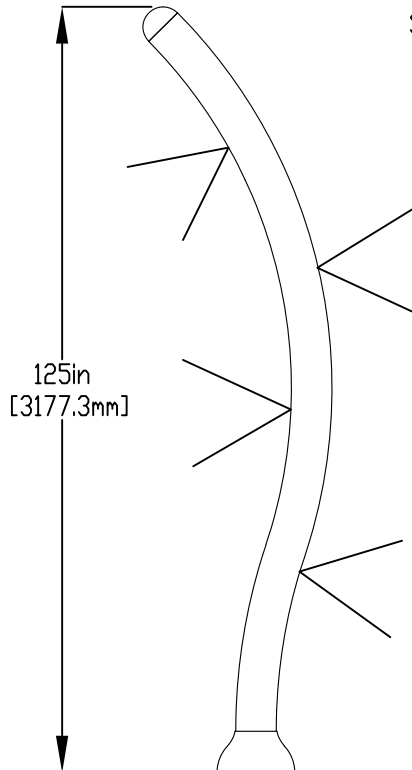

ø72in [1828.8mm]
SPRAY DIAMETER

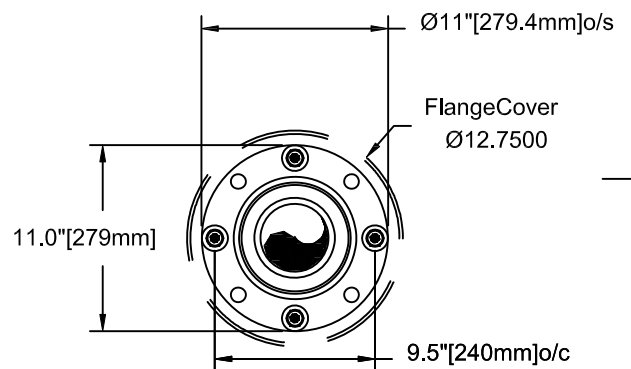
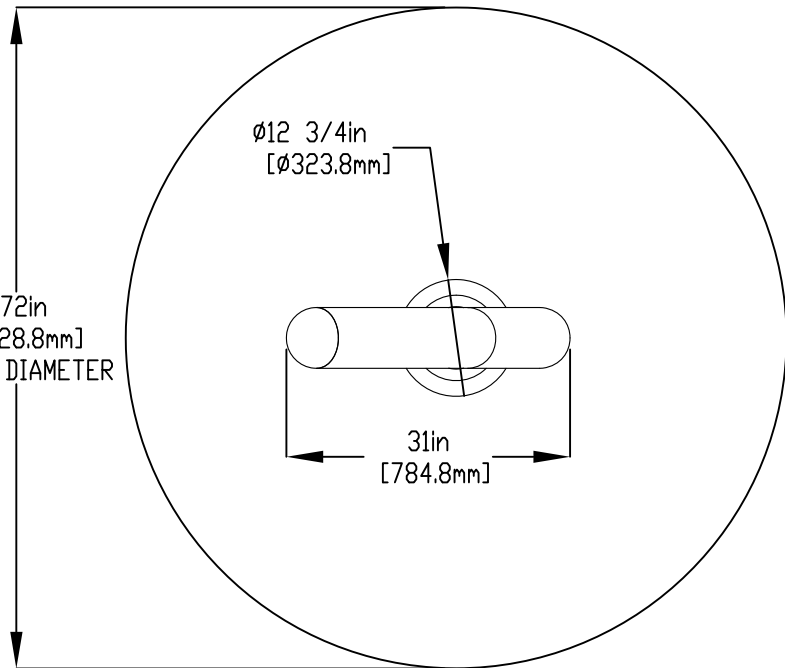

FLOODED COLUMN

LOWER FLANGE COVER AFTER INSTALL

STAINLESS STEEL (316)
ø½" (13mm) TREADED ROD
WASHER, LOCKWASHER & NUT
7" (180mm) TREADED ROD LENGTH
WITH 5" (120mm) EMBEDMENT.
INSTALL MINIMUM 5 ANCHORS,
TO BE PROVIDED BY CONTRACTOR

2" (50mm) S40 PVC PIPE WATERFEED

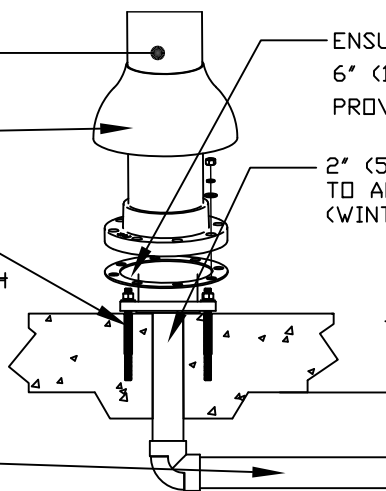

ENSURE LEVEL SURFACE INSTALL
6" (152mm) X ½" (3mm) GASKET
PROVIDED BY EMPEX

2" (50mm) FEED PIPE CUT CLOSE
TO ALLOW FULL DRAINAGE
(WINTERIZATION)

8in [202.3mm]

E

E

F

F



Notes: Overall dimensions of toys are approximate.
Approximate Weight: 68lbs / 30.9 kgs

© EMPEX WATERTOYS

WATER SUPPLY
30 gpm @ 25 psi
1.89L/S @17.5m

AQUAWIGL

T273

09/12/2021

SCALE:

Sheet 1 of 1

1

2

3

4