

**NOTES:**

(1) PURGE ALL WATER SUPPLY LINES TO REMOVE SOLIDS PRIOR TO TOY INSTALLATION.

(2) PROVIDE ELECTRICAL BOND WITH POOL REBAR.

(3) INSTALL ALL WATER TOYS PLUMB AND LEVEL.

(4) PROVIDE STRAINER UPSTREAM OF TOY WITH MAX 1/32" (0.8mm) PERFORATIONS.

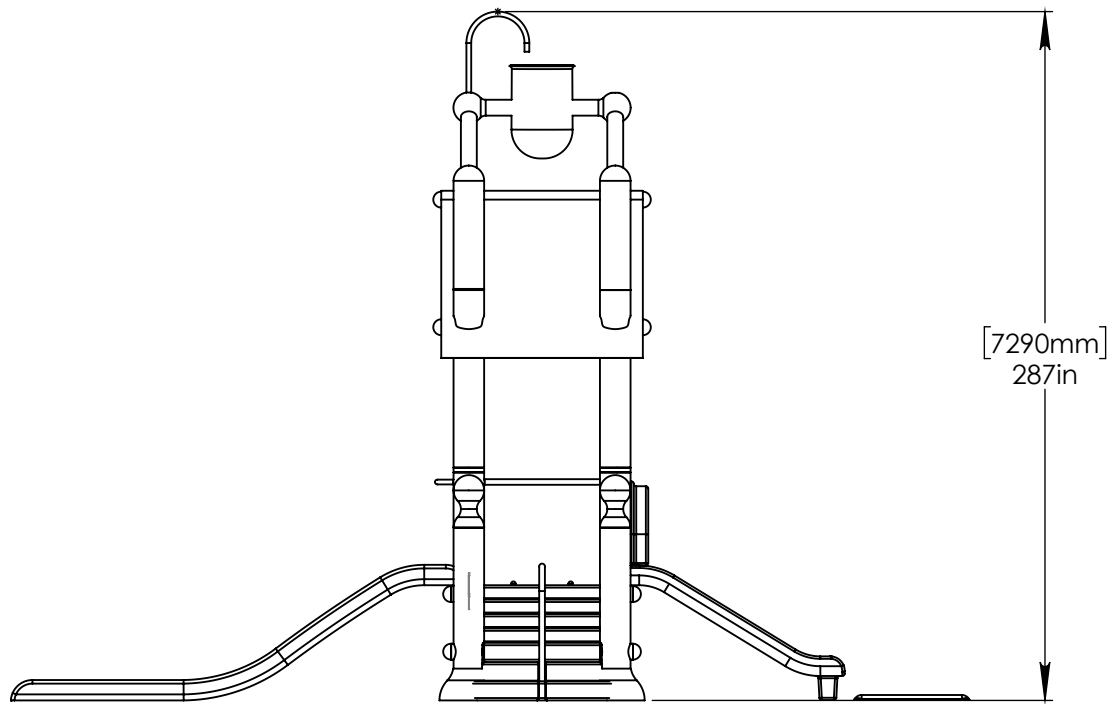
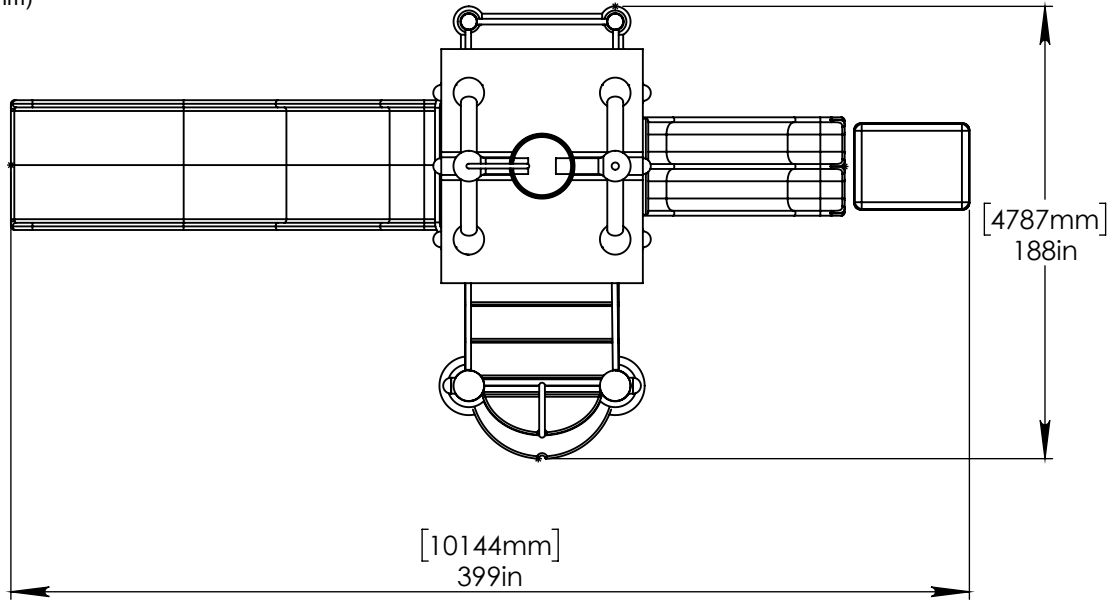

Notes: Overall dimensions of toys are approximate.

© EMPEX WATERTOYS

**WATER SUPPLY**  
 220 gpm @ 25 psi  
 13.9 L/S @17.5m

# AQUADEK

**T410-4D1L**

1/27/2017

SCALE:  
1:80

Sheet  
1 of 2

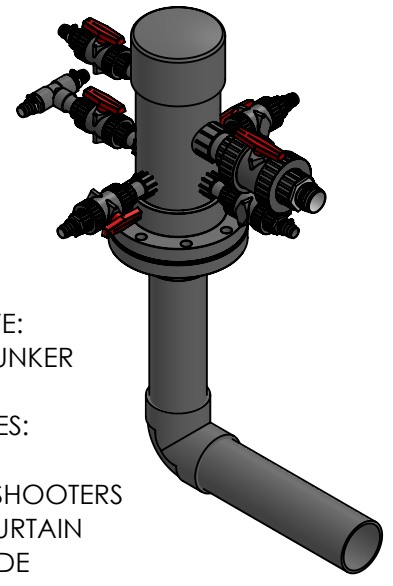
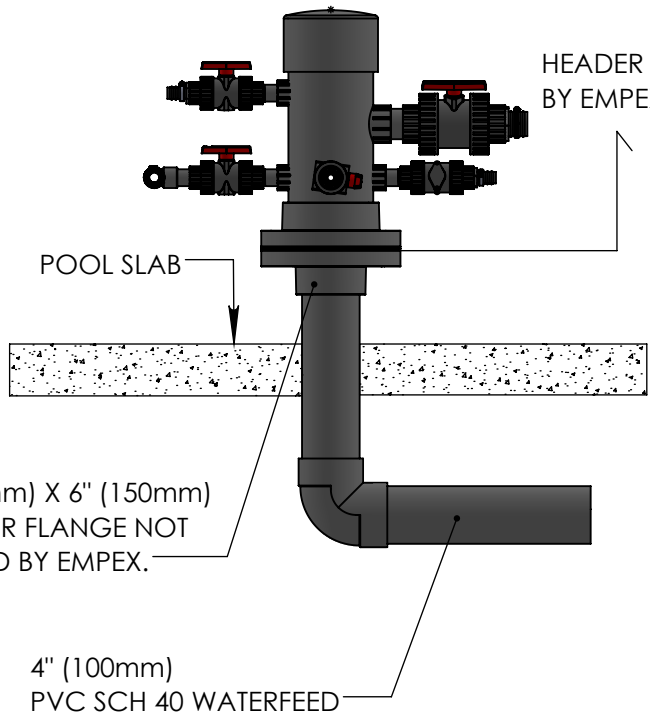

2" (150mm) VALVE:  
(1) AQUADUNKER

1" (100mm) VALVES:  
(2) FINIALS  
(1) FINGERSHOOTERS  
(1) AQUACURTAIN  
(1) LANE SLIDE

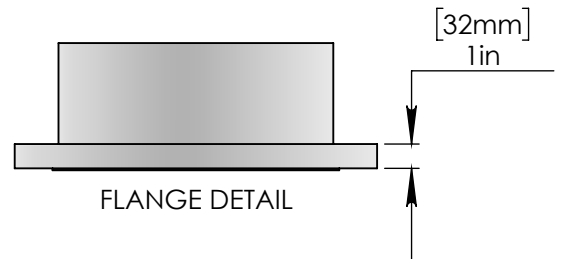
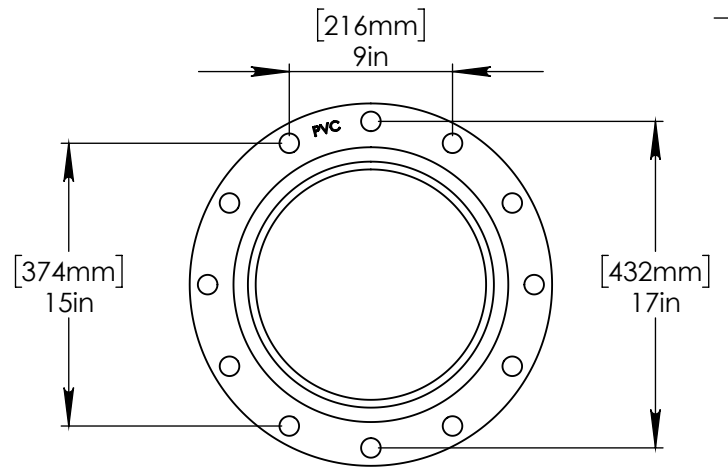
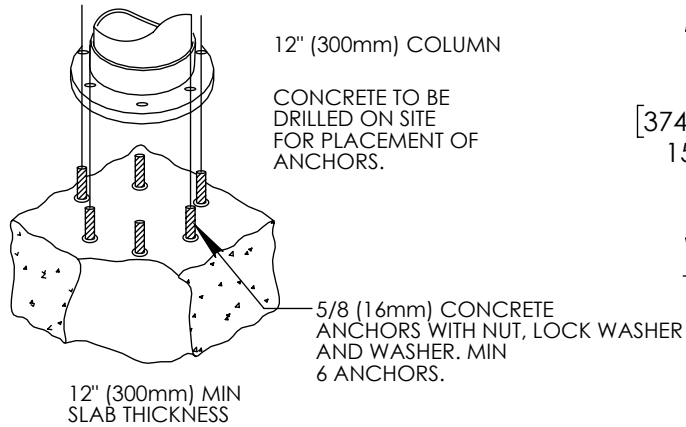

Notes: Overall dimensions of toys are approximate.

© EMPEX WATERTOYS

WATER SUPPLY

220 gpm @ 25 psi  
13.9 L/S @ 17.5m

**AQUADEK**

**T410-4D1L**

1/27/2017

SCALE:  
1:15

Sheet  
2 of 2