

1

2

3

4

NOTES:

(1) PURGE ALL WATER SUPPLY LINES TO REMOVE SOLIDS PRIOR TO TOY INSTALLATION.

(2) PROVIDE ELECTRICAL BOND WITH POOL REBAR.

(3) INSTALL ALL WATER TOYS PLUMB AND LEVEL.

(4) PROVIDE STRAINER UPSTREAM OF TOY WITH MAX PERFORATIONS.
1#32" (0.8mm)

REFER TO INSTALL DIAGRAM FOR ANCHOR DETAILS

REFER TO INSTALL DIAGRAM FOR ANCHOR PLATE DETAILS

A

A

B

B

C

C

D

D

E

E

F

F

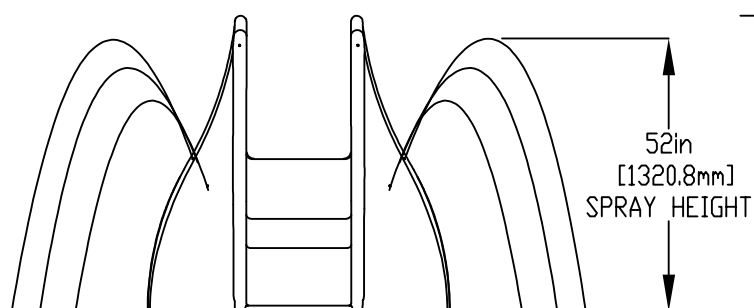
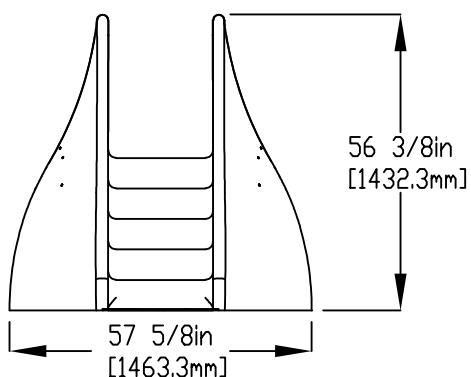
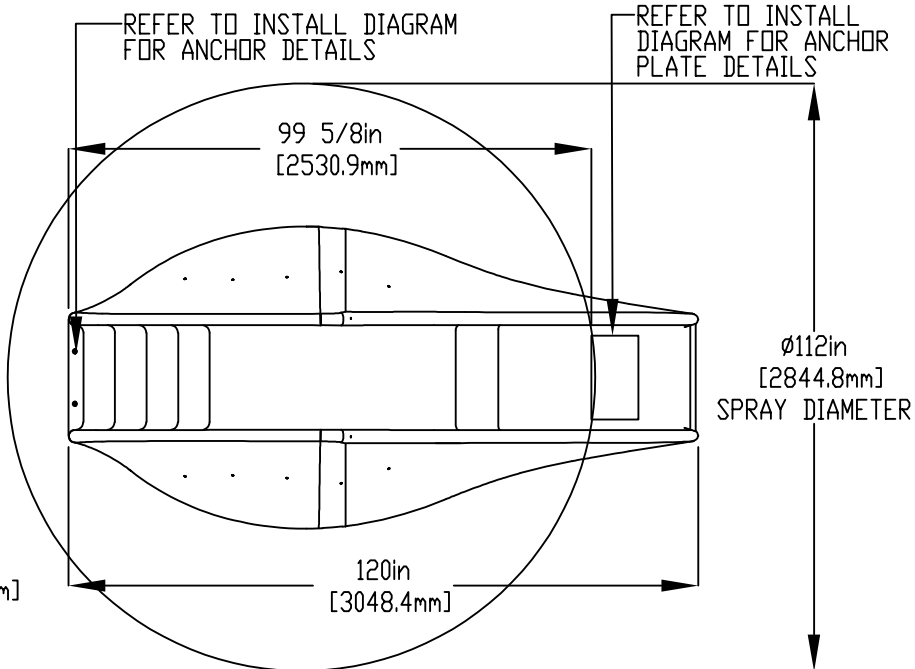
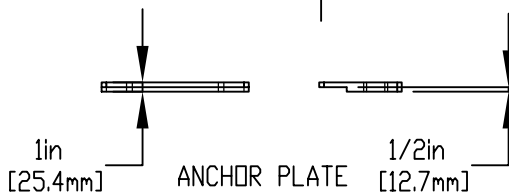
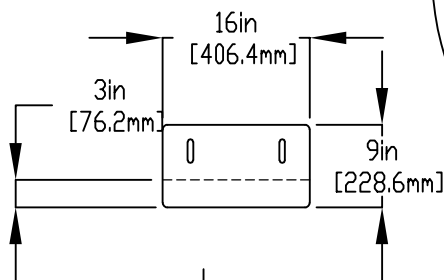

2" (50mm) COUPLING
2" (50mm) TO 1" (25mm) REDUCER
1" (25mm) HOSEBARB W/ SS CLAMP
TO BE PROVIDED BY CONTRACTOR

1" (25mm) FLEX HOSE
PROVIDED BY EMPEX

MAX
WATER DEPTH
0in - 12in
[305.2mm]

2" (50mm) SCH 40 PVC
WATER FEED TO BE EXTENDED
8" (200mm) ABOVE SLAB.

8in [203.2mm]



Notes: Overall dimensions of toys are approximate.
Approximate Weight: 156lbs / 709kgs

© EMPEX WATERTOYS

WATER SUPPLY

30 gpm @ 20 psi
1.89 L/S @ 14.5m

AQUAWAVE

T450

1/20/2020

SCALE:

Sheet
1 of 1

1

2

3

4