

A

A

B

B

C

C

D

D

E

E

F

F

NOTES:

(1) PROVIDE ELECTRICAL BOND WITH POOL REBAR.

(2) 2 PART EPOXY MAY BE USED IN LIEU OF INSERT ANCHOR.

(3) PURGE ALL WATER SUPPLY LINES TO REMOVE SOLIDS PRIOR TO TOY INSTALLATION.

(4) INSTALL ALL WATER TOYS PLUMB AND LEVEL.

(5) PROVIDE STRAINER UPSTREAM OF TOY WITH MAX 1#32" (0.8mm) PERFORATIONS.

[8750.64mm]
344.51in

[16902.27mm]
665.44in

[7662mm]
302in



Notes : (1) Dual Dimensions
(2) Outer dimensions of toys are approximate.

© EMPEX WATER TOYS
JAN 8, 2014

Scale
N.T.S.

WATER SUPPLY

520 gpm @ 25 psi
33L/S @17.5m

AQUADEK T610-246D

Edition

Sheet
1/1

A

A

B

B

C

C

D

D

E

E

F

F

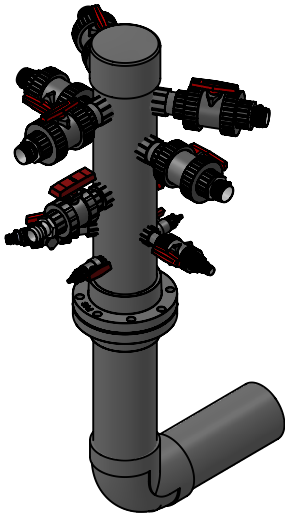

TOTAL 11 MANIFOLD VALVES:
 (5) 2" VAVLES FOR FALLS, DUNKER, (3) FG SLIDE
 (1) 1 1/2" FOR TUBA
 (3) 1" VALVES SHOWER, FINIAL, CURTAIN.
 (2) 1/2" VALVES FOR SHOOTERS

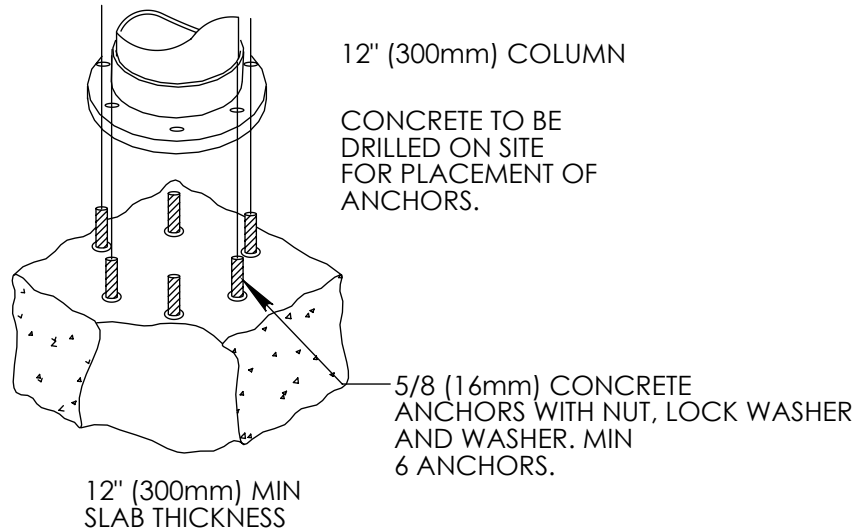
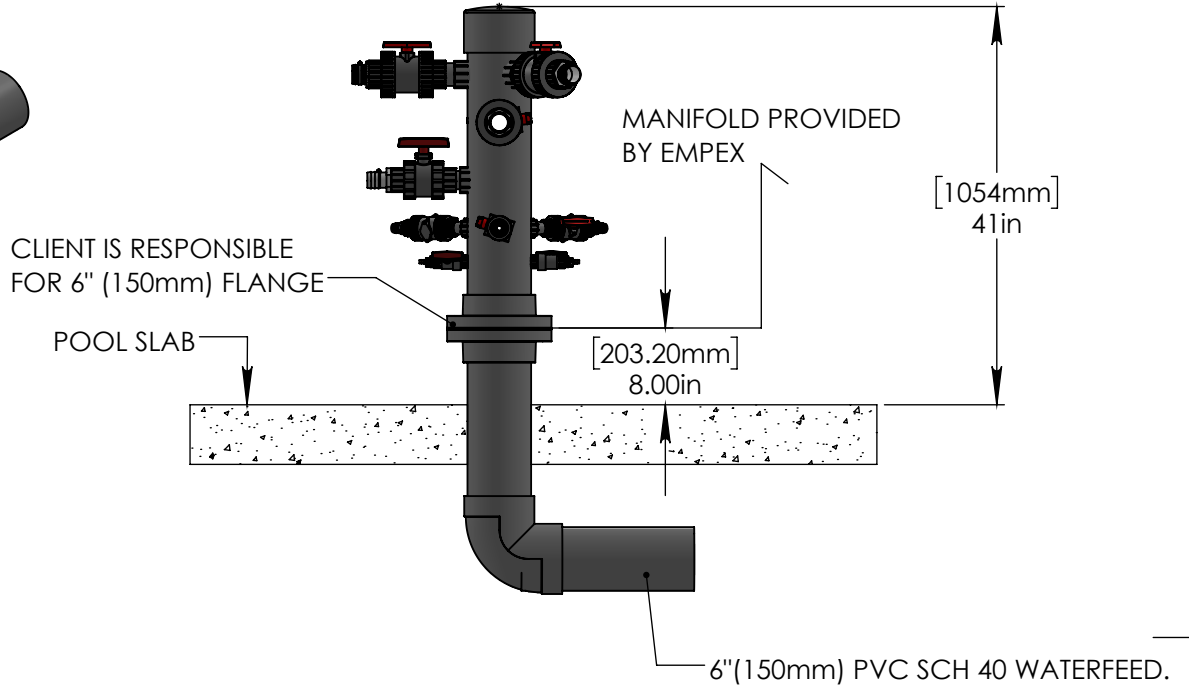

Notes : (1) Dual Dimensions
 (2) Outer dimensions of toys are approximate.

C EMPEX WATER TOYS
 JAN 8, 2014

Scale
 N.T.S.



WATER SUPPLY

520 gpm @ 25 psi
 33L/S @17.5m

AQUADEK T610-246D

Edition

Sheet
 1/1