

NOTES:

- PLAN VIEW**
- (1) PURGE ALL WATER SUPPLY LINES TO REMOVE SOLIDS PRIOR TO TOY INSTALLATION.
 - (2) PROVIDE ELECTRICAL BOND WITH POOL REBAR.
 - (3) INSTALL ALL WATER TOYS PLUMB AND LEVEL.
 - (4) PROVIDE STRAINER UPSTREAM OF TOY WITH MAX 1#32" (0.8mm) PERFORATIONS.

ELEVATION VIEW

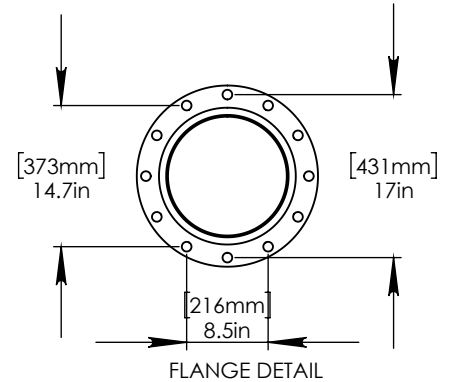

FLANGE DETAIL

2"(50mm)-1"(25mm) FITTING TO BE PROVIDED BY CONTRACTOR.

STAINLESS STEEL (316) 5/8" (16mm) THREADED ROD, WASHER, LOCK WASHER, & NUT. THREADED ROD LENGTH 11" (280mm) WITH 6" (150mm) EMBEDMENT. USE MIN. 8 ANCHORS.

GRANULAR BASE

2"(50mm) PVC SCH 40 WATERFEED TO BE EXTENDED 8"(200mm) ABOVE SLAB.

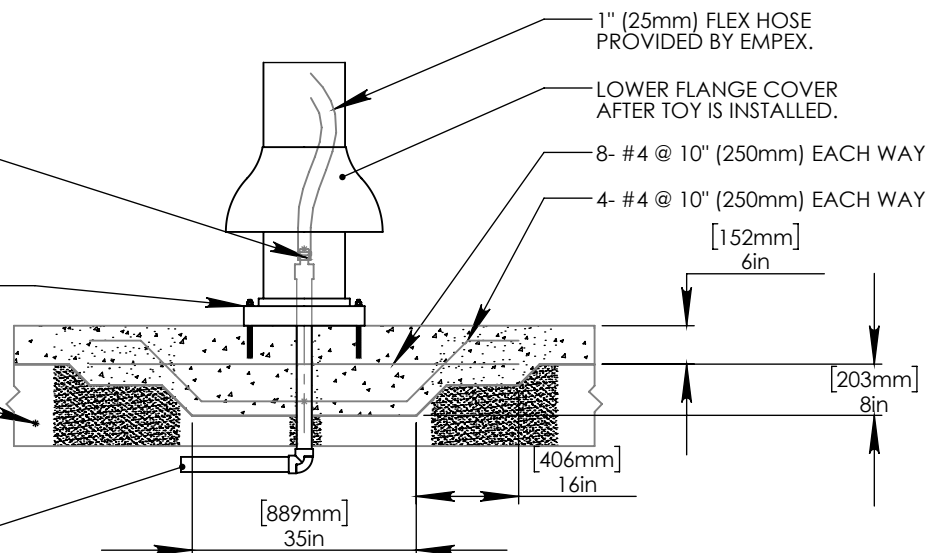

1" (25mm) FLEX HOSE PROVIDED BY EMPEX.

LOWER FLANGE COVER AFTER TOY IS INSTALLED.

8- #4 @ 10" (250mm) EACH WAY

4- #4 @ 10" (250mm) EACH WAY

[152mm] 6in

[203mm] 8in

[889mm] 35in

[406mm] 16in

	Notes: Overall dimensions of toys are approximate.		© EMPEX WATERTOYS	
	WATER SUPPLY 50 gpm @ 25 psi 3.15L/S @ 17.5m		SPLASHIN CRITTERS	
		T725	1/19/2018	SCALE: 1:60 Sheet 1 of 1