

NOTES:

- (1) PURGE ALL WATER SUPPLY LINES TO REMOVE SOLIDS PRIOR TO TOY INSTALLATION.
- (2) PROVIDE ELECTRICAL BOND WITH POOL REBAR.
- (3) INSTALL ALL WATER TOYS PLUMB AND LEVEL.
- (4) PROVIDE STRAINER UPSTREAM OF TOY WITH MAX 1#32" (0.8mm) PERFORATIONS.

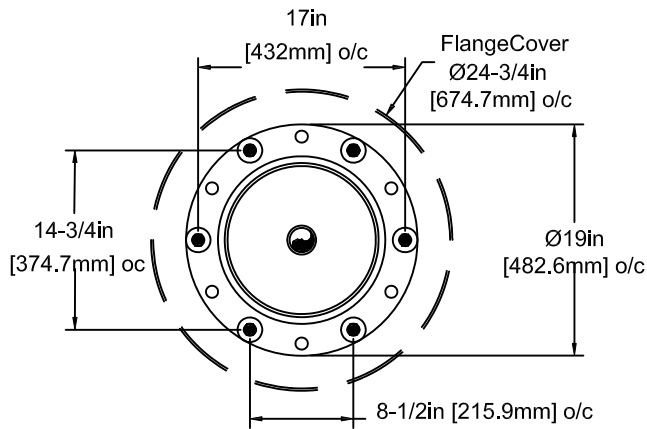

FLANGE DETAIL

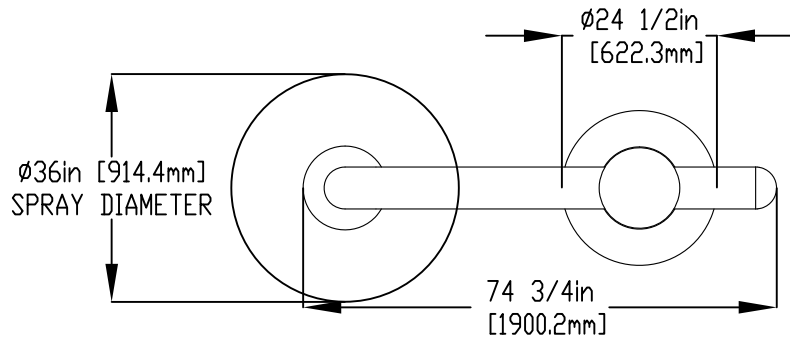
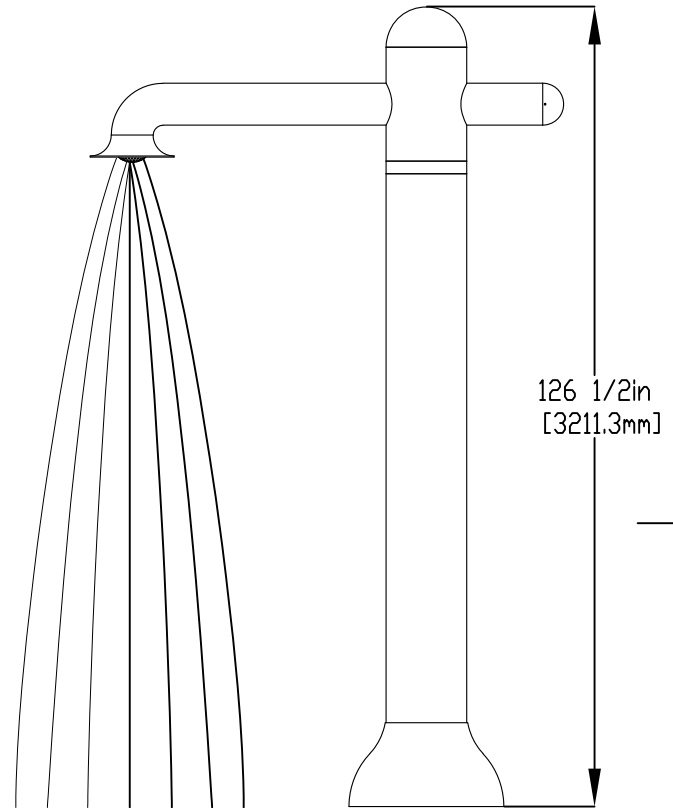

LOWER FLANGE COVER AFTER TOY IS INSTALLED.

TO BE PROVIDED BY CONTRACTOR  
 STAINLESS STEEL (316)  
 5/8" (16mm) THREADED ROD, WASHER,  
 LOCK WASHER, & NUT.  
 THREADED ROD LENGTH 9" (230mm)  
 WITH 6" (150mm) EMBEDMENT. USE  
 MINIMUM 6 ANCHORS.

1" (25mm) FLEX HOSE PROVIDED BY EMPEX.

TO BE PROVIDED BY CONTRACTOR  
 2" (50mm) COUPLING  
 2" (50mm)-1" (25mm) REDUCER  
 1" (25mm) HOSE BARB & SS CLAMP

2" (50mm) SCH 40 PVC  
 WATERFEED TO BE EXTENDED  
 8" (200mm) ABOVE SLAB.

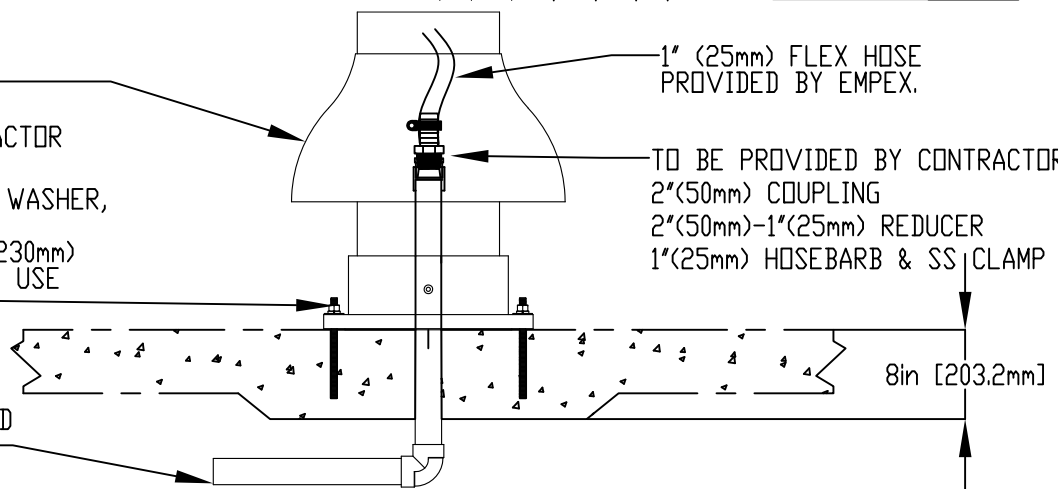

Notes: Overall dimensions of toys are approximate.

© EMPEX WATERTOYS

WATER SUPPLY  
 30 gpm @ 25 psi  
 1.89L/S @17.5m

AQUASHOWER

T873

14/12/2021

SCALE:

Sheet 1 of 1