

NOTES:

- (1) PURGE ALL WATER SUPPLY LINES TO REMOVE SOLIDS PRIOR TO TOY INSTALLATION.
- (2) PROVIDE ELECTRICAL BOND WITH POOL REBAR.
- (3) INSTALL ALL WATER TOYS PLUMB AND LEVEL.
- (4) PROVIDE STRAINER UPSTREAM OF TOY WITH MAX $\#32$ (0.8mm) PERFORATIONS.

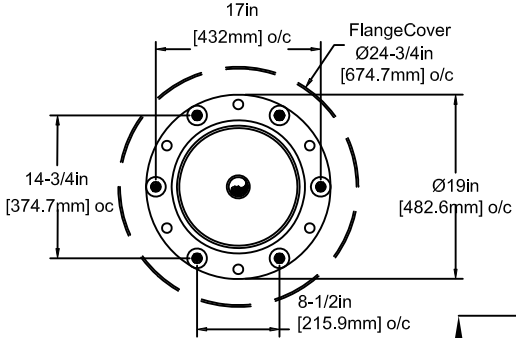

FLANGE DETAIL

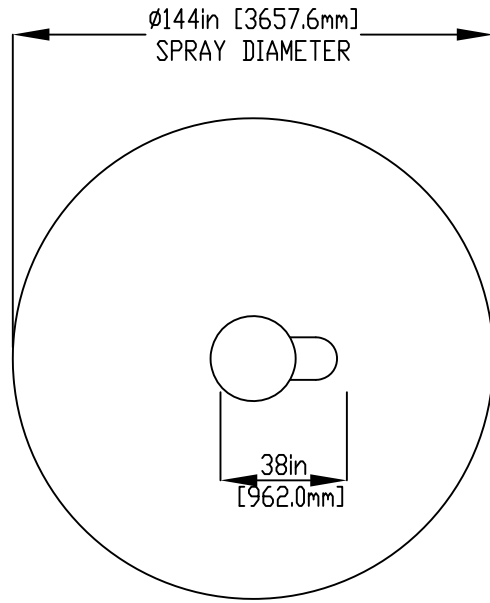
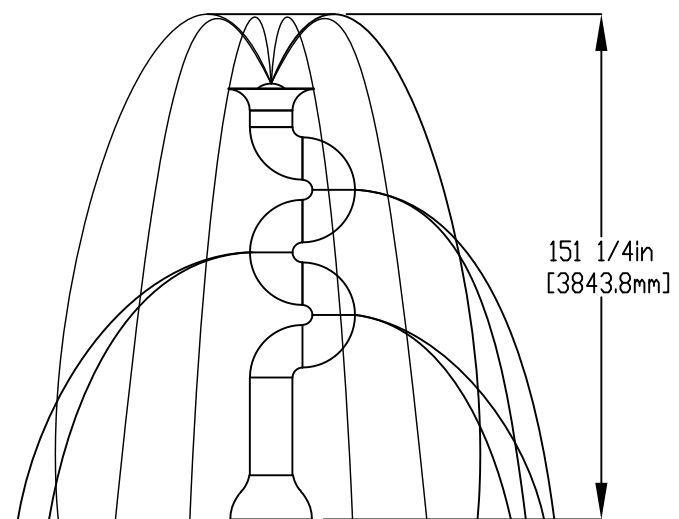
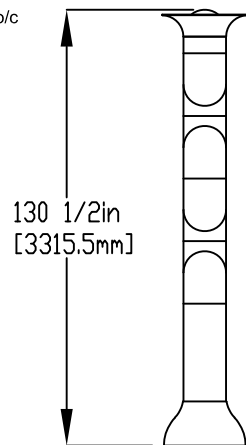

LOWER FLANGE COVER AFTER TOY IS INSTALLED.

STAINLESS STEEL (316)
5/8" (16mm) THREADED ROD, WASHER,
LOCK WASHER, & NUT.
THREADED ROD LENGTH 9" (230mm)
WITH 6" (150mm) EMBEDMENT. USE
MINIMUM 6 ANCHORS.
TO BE PROVIDED BY CONTACTOR

1 1/2" (38mm) FLEX HOSE
PROVIDED BY EMPEX.
2" (50mm) COUPLING
2" (50mm)-1 1/2" (38mm) REDUCER
1-1/2" (38mm) HOSEBARB W/SS CLAMP
TO BE PROVIDED BY CONTRACTOR

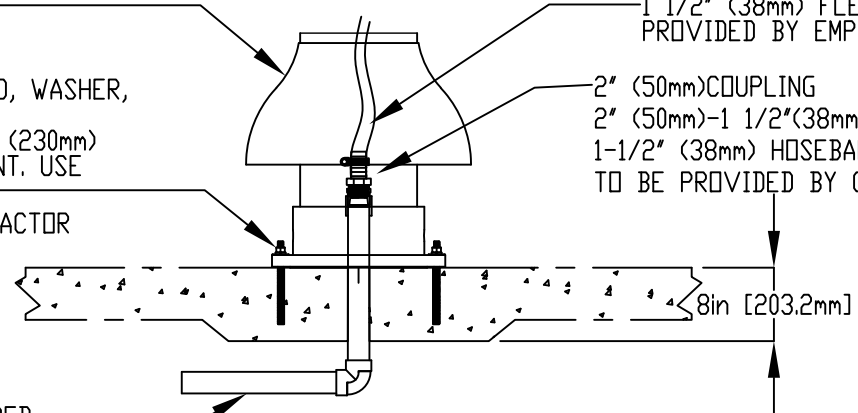

2" (50mm) SCH 40 PVC
WATERFEED TO BE EXTENDED
8" (200mm) ABOVE SLAB.



Notes: Overall dimensions of toys are approximate.

© EMPEX WATERTOYS

WATER SUPPLY
50 gpm @ 25 psi
3.15 L/S @17.5m

AQUARHYM

T882

04/10/2021

SCALE:

Sheet 1 of 1