

1

2

3

4

NOTES:

- (1) PURGE ALL WATER SUPPLY LINES TO REMOVE SOLIDS PRIOR TO TOY INSTALLATION.
- (2) PROVIDE ELECTRICAL BOND WITH POOL REBAR.
- (3) INSTALL ALL WATER TOYS PLUMB AND LEVEL.
- (4) PROVIDE STRAINER UPSTREAM OF TOY WITH MAX PERFORATIONS.

1#32" (0.8mm)

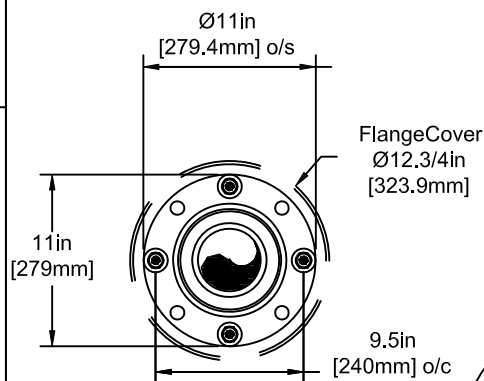
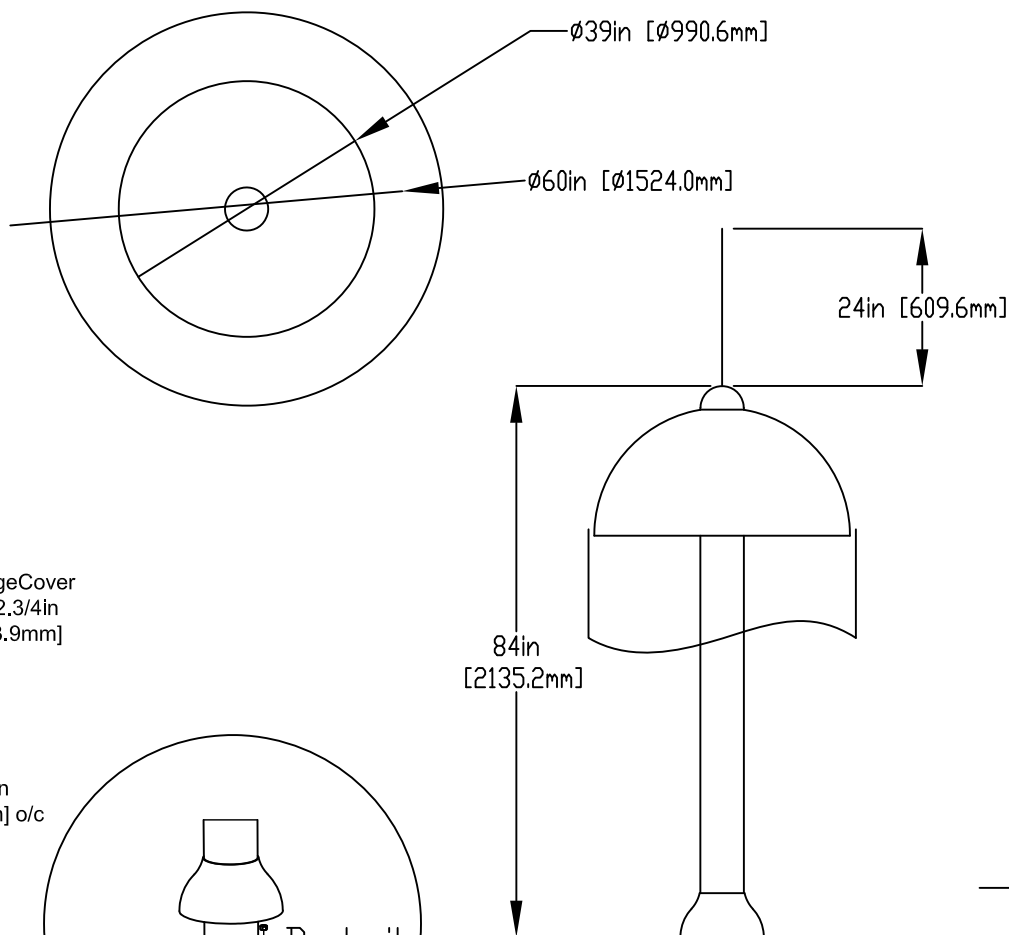

FLANGE DETAIL

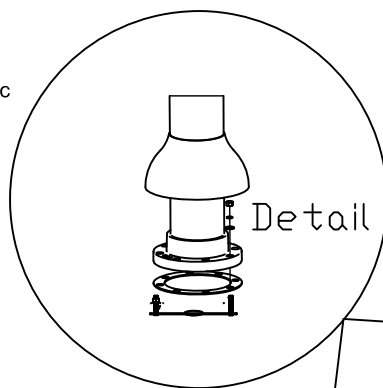

Detail

LOWER FLANGE COVER AFTER TOY IS INSTALLED.

STAINLESS STEEL (316)
5/8" (16mm) THREADED ROD,
WASHER, LOCK WASHER, & NUT.
THREADED ROD LENGTH 9" (230mm)
WITH 6" (150mm) EMBEDMENT. USE MIN.
8 ANCHORS.

ENSURE LEVEL SURFACE. INSTALL
Ø 12" X 1/8" GASKET UNDER
COLUM PIPE FLANGE.

8- #4 @ 10" (250mm) EACH WAY

4- #4 @ 10" (250mm) EACH WAY

6in [152.4mm]

8in [203.2mm]

GRANULAR
BASE

2" (50mm) PVC SCH 40
WATERFEED TO BE
CUT CLOSE TO ALLOW FOR
DRAINAGE (WINTERIZATION)

35in [889.0mm]

16in [406.4mm]

F



Notes: Overall dimensions of toys are approximate.
Approximate Weight: 78lbs / 35.5kgs

© EMPEX WATERTOYS

WATER SUPPLY
70 gpm @ 10 psi
4.4 L/S @ 7m

AQUABRELLO MINI

T887

10/12/2021

SCALE:

Sheet
1 of 1

1

2

3

4