

1 2 3 4

NOTES:

- (1) PURGE ALL WATER SUPPLY LINES TO REMOVE SOLIDS PRIOR TO TOY INSTALLATION.
- (2) PROVIDE ELECTRICAL BOND WITH POOL REBAR.
- (3) INSTALL ALL WATER TOYS PLUMB AND LEVEL.
- (4) PROVIDE STRAINER UPSTREAM OF TOY WITH MAX PERFORATIONS.

1832" (0.8mm)

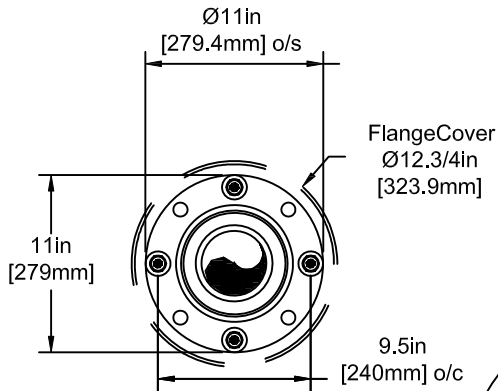
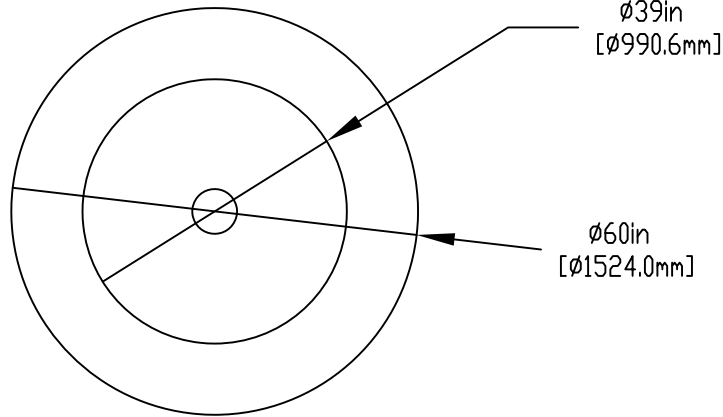

FLANGE DETAIL

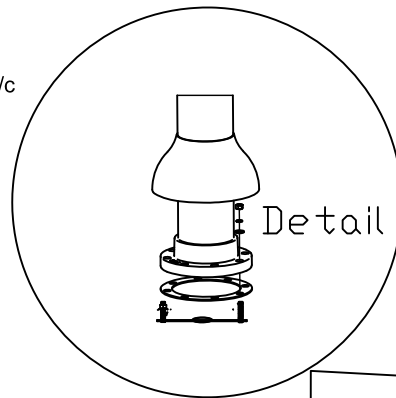

Detail

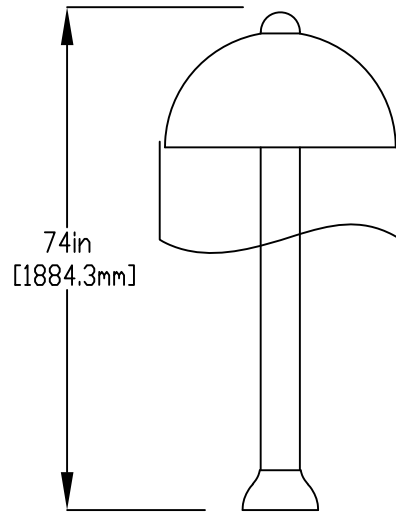

LOWER FLANGE COVER AFTER TOY IS INSTALLED.

ENSURE LEVEL SURFACE. INSTALL ø6" (150mm) X 1/8" (3mm) GASKET INSTALLED UNDER COLUMN PIPE FLANGE. PROVIDED BY EMPEX

STAINLESS STEEL (316)
5/8" (16mm) THREADED ROD,
WASHER, LOCK WASHER, & NUT.
THREADED ROD LENGTH 9" (230mm)
WITH 6" (150mm) EMBEDMENT. USE MIN.
8 ANCHORS. TO BE PROVIDED BY
CONTRACTOR

GRANULAR BASE

2" (50mm) PVC SCH 40
WATERFEED TO BE
CUT CLOSE TO ALLOW FOR
DRAINAGE (WINTERIZATION)

8- #4 @ 10" (250mm) EACH WAY
4- #4 @ 10" (250mm) EACH WAY

6in [152.4mm]

8in [203.2mm]

35in [889.0mm]

16in [406.4mm]



Notes: Overall dimensions of toys are approximate.
Approximate Weight: 68lbs (30.9kgs)

© EMPEX WATERTOYS

WATER SUPPLY
70 gpm @ 10 psi
4.4 L/S @ 7m

AQUABRELLO MINI SMALL

T887S

10/12/2021

SCALE:

Sheet
1 of 1