

**NOTES:**

(1) PURGE ALL WATER SUPPLY LINES TO REMOVE SOLIDS PRIOR TO TOY INSTALLATION.

(2) PROVIDE ELECTRICAL BOND WITH POOL REBAR.

(3) INSTALL ALL WATER TOYS PLUMB AND LEVEL.

(4) PROVIDE STRAINER UPSTREAM OF TOY WITH MAX 1#32" (0.8mm) PERFORATIONS.

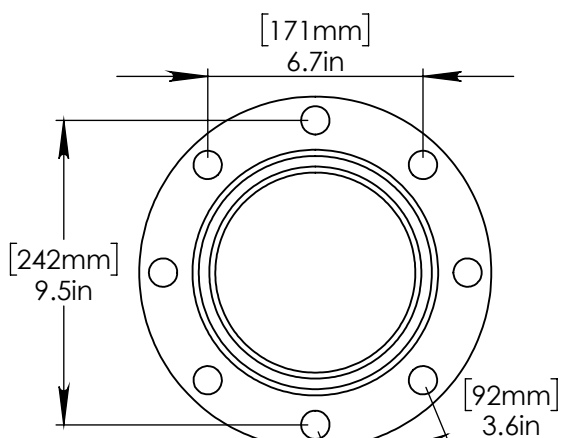
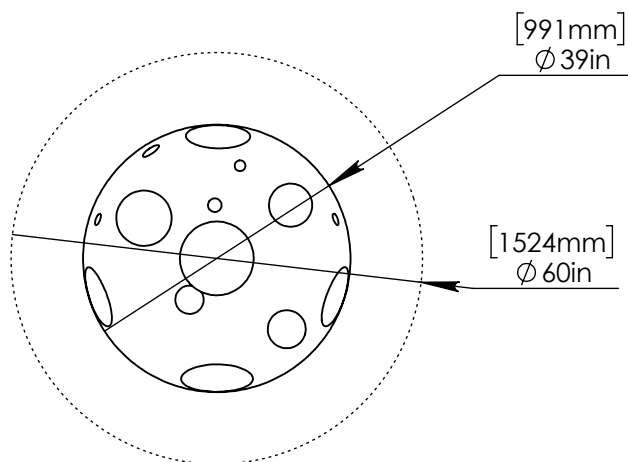

FLANGE DETAIL

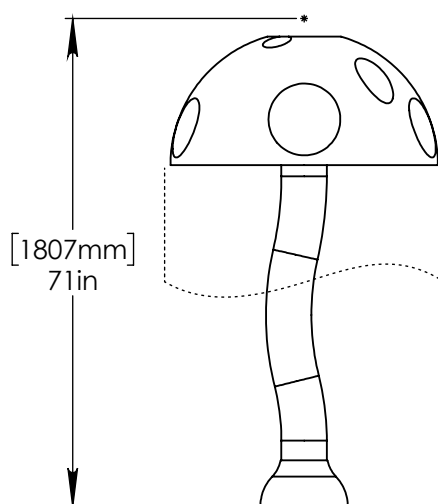

LOWER FLANGE COVER AFTER TOY IS INSTALLED.

STAINLESS STEEL (316) 5/8" (16mm) THREADED ROD, WASHER, LOCK WASHER, & NUT. THREADED ROD LENGTH 9" (230mm) WITH 6" (150mm) EMBEDMENT. USE MIN. 6 ANCHORS.

ENSURE LEVEL SURFACE. INSTALL Ø 6" X 1/8" GASKET UNDER COLUMN PIPE FLANGE.

2" (50mm) PVC SCH 40 WATERFEED TO BE EXTENDED 4" (100mm) ABOVE SLAB.

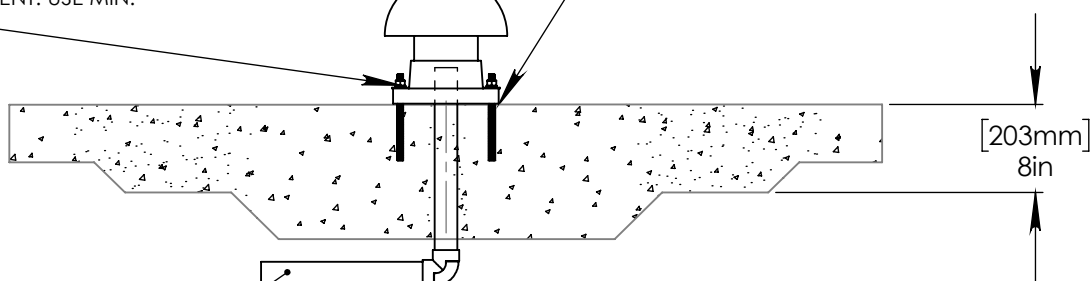

Notes: Overall dimensions of toys are approximate.

© EMPEX WATERTOYS



**WATER SUPPLY**  
70 gpm @ 10 psi  
4.4 L/S @ 7m

**AQUABRELLO MINI CURVED**

**T889L**

9/14/2018

SCALE:  
1:35

Sheet  
1 of 1