

NOTES:

(1) PURGE ALL WATER SUPPLY LINES TO REMOVE SOLIDS PRIOR TO TOY INSTALLATION.

(2) PROVIDE ELECTRICAL BOND WITH POOL REBAR.

(3) INSTALL ALL WATER TOYS PLUMB AND LEVEL.

(4) PROVIDE STRAINER UPSTREAM OF TOY WITH MAX 1#32" (0.8mm) PERFORATIONS.

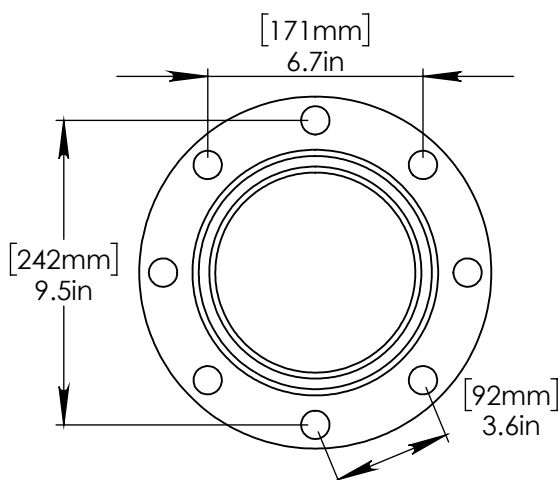
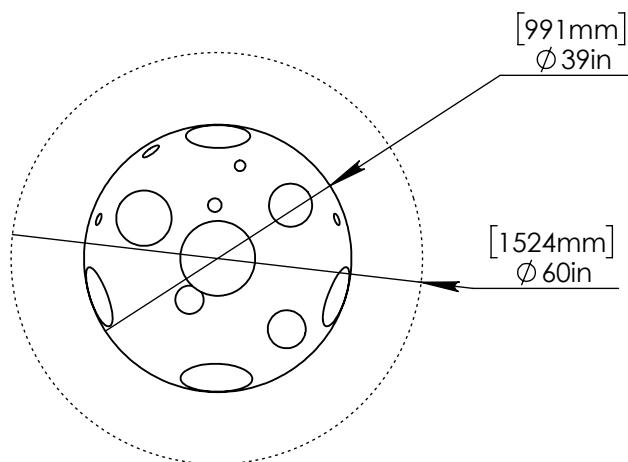

FLANGE DETAIL

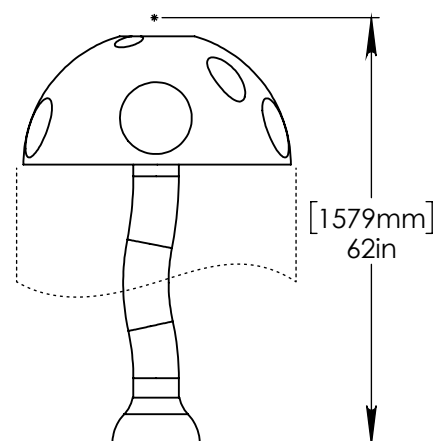

LOWER FLANGE COVER AFTER TOY IS INSTALLED.

ENSURE LEVEL SURFACE. INSTALL Ø 6" X 1/8" GASKET UNDER COLUM PIPE FLANGE.

STAINLESS STEEL (316)
5/8" (16mm) THREADED ROD,
WASHER, LOCK WASHER, & NUT.
THREADED ROD LENGTH 9" (230mm)
WITH 6" (150mm) EMBEDMENT. USE MIN.
6 ANCHORS.

2" (50mm) PVC SCH 40
WATERFEED TO BE
EXTENDED 4" (100mm)
ABOVE SLAB.

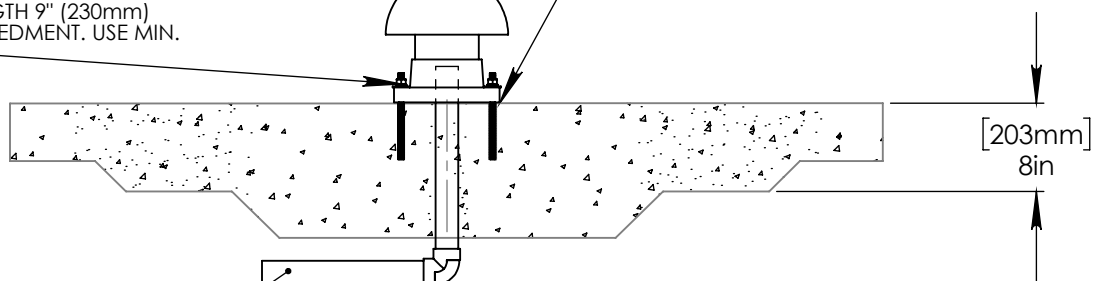

Notes: Overall dimensions of toys are approximate.

© EMPEX WATERTOYS



WATER SUPPLY
70 gpm @ 10 psi
4.4 L/S @ 7m

AQUABRELLO MINI CURVED

T889S

9/14/2018

SCALE:
1:35

Sheet
1 of 1