

**NOTES:**

- (1) PURGE ALL WATER SUPPLY LINES TO REMOVE SOLIDS PRIOR TO TOY INSTALLATION.
- (2) PROVIDE ELECTRICAL BOND WITH POOL REBAR.
- (3) INSTALL ALL WATER TOYS PLUMB AND LEVEL.
- (4) PROVIDE STRAINER UPSTREAM OF TOY WITH MAX PERFORATIONS.  $1/32"$  (0.8mm)

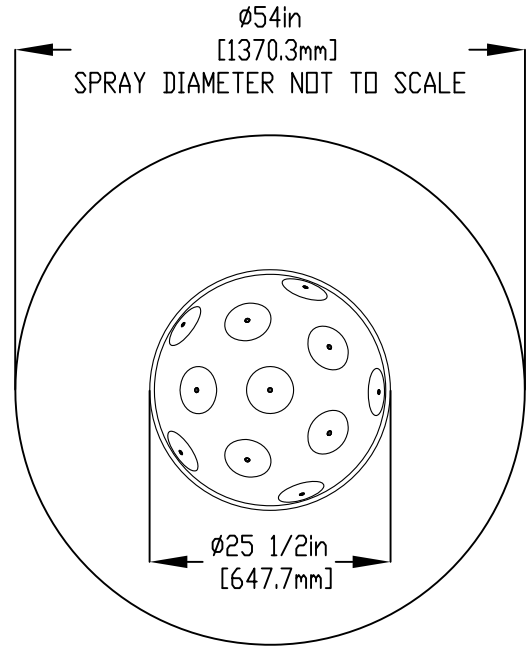

PLAN VIEW

A

A

B

B

C

C

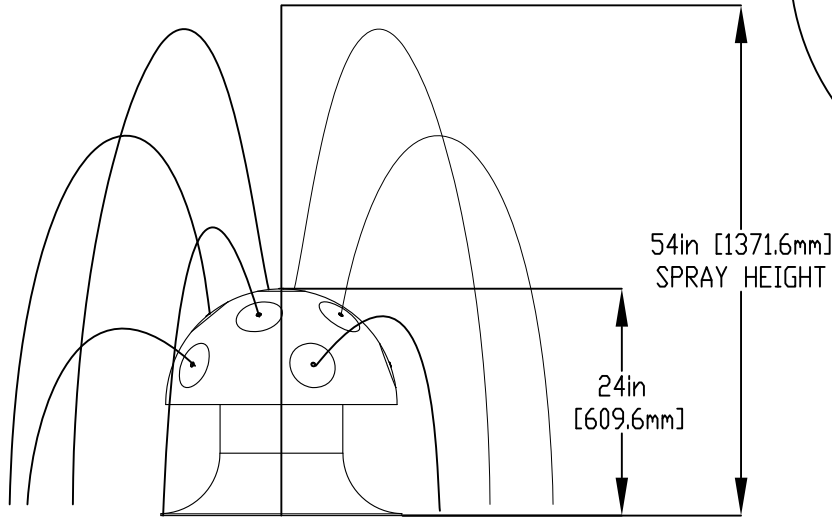

ELEVATION

LOWER TOY INTO RECEIVER SLEEVE

D

D

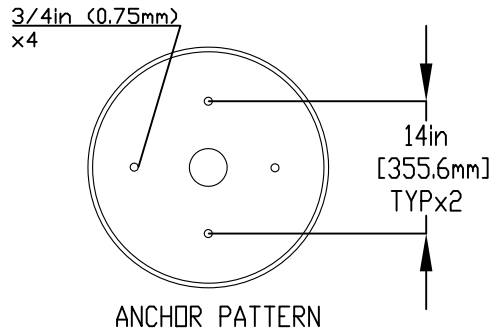

ANCHOR PATTERN

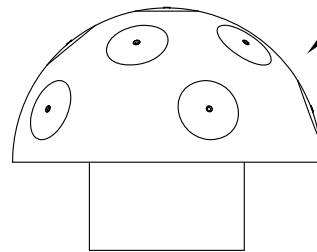

E

E

1/2" (13mm) STAINLESS STEEL (316) THREADED ROD, WASHER, LOCK WASHER, & NUT. SUGGESTED 7" (180mm) THREADED ROD WITH 6" (150mm) EMBEDMENT. TO BE PROVIDED BY CONTRACTOR

1" (25mm) HOSE PROVIDED BY EMPEX.

2" (50mm) COUPLING  
2" (50mm) - 1" (25mm) REDUCER  
1" (25mm) HOSEBARB W/ SS CLAMP TO BE PROVIDED BY CONTRACTOR

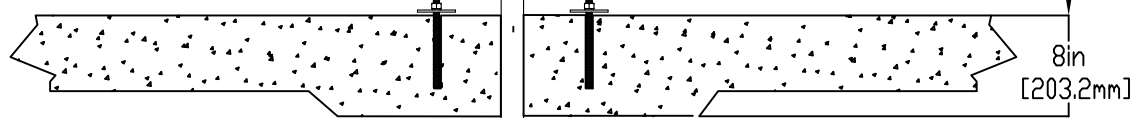

2" (50mm) PVC SCH 40 PIPE EXTENDED 4" (100mm) ABOVE POOL SLAB.

F

F

Notes: Overall dimensions of toys are approximate.  
Approximate Weight: 38lbs / 17.3kgs

© EMPEX WATERTOYS



**WATER SUPPLY**  
20 gpm @ 25 psi  
1.3L/S @17.5m

AQUACAP SMALL

TR268S

15/05/2020

SCALE:

Sheet  
1 of 1