

1

2

3

4

**NOTES:**

(1) PURGE ALL WATER SUPPLY LINES TO REMOVE SOLIDS PRIOR TO TOY INSTALLATION.

(2) PROVIDE ELECTRICAL BOND WITH POOL REBAR.

(3) INSTALL ALL WATER TOYS: PLUMB AND LEVEL.

(4) PROVIDE STRAINER UPSTREAM OF TOY WITH MAX 1#32" (0.8mm) PERFORATIONS.

A

A

B

B

C

C

D

D

E

E

F

F

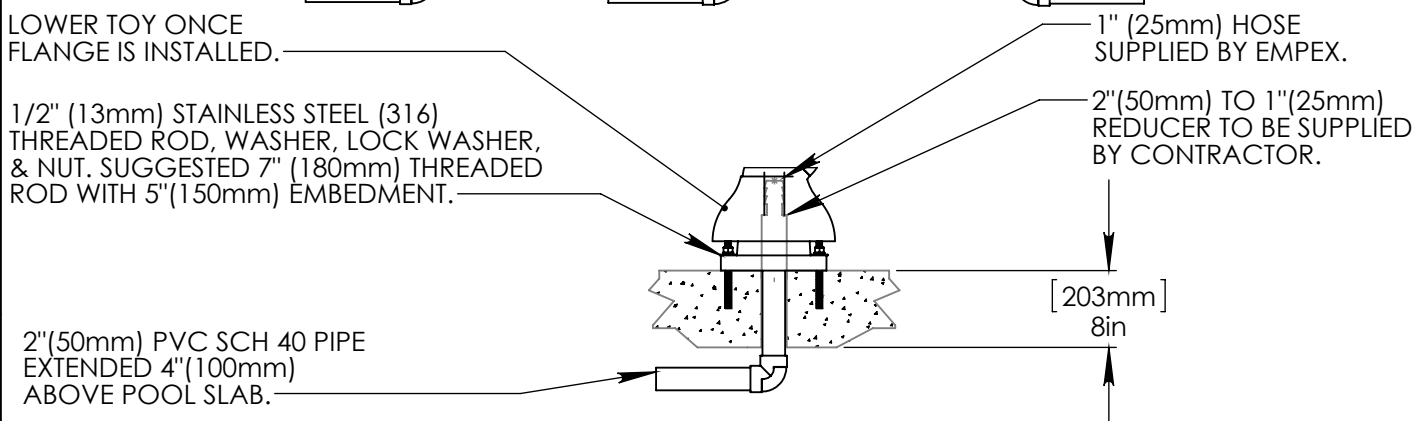
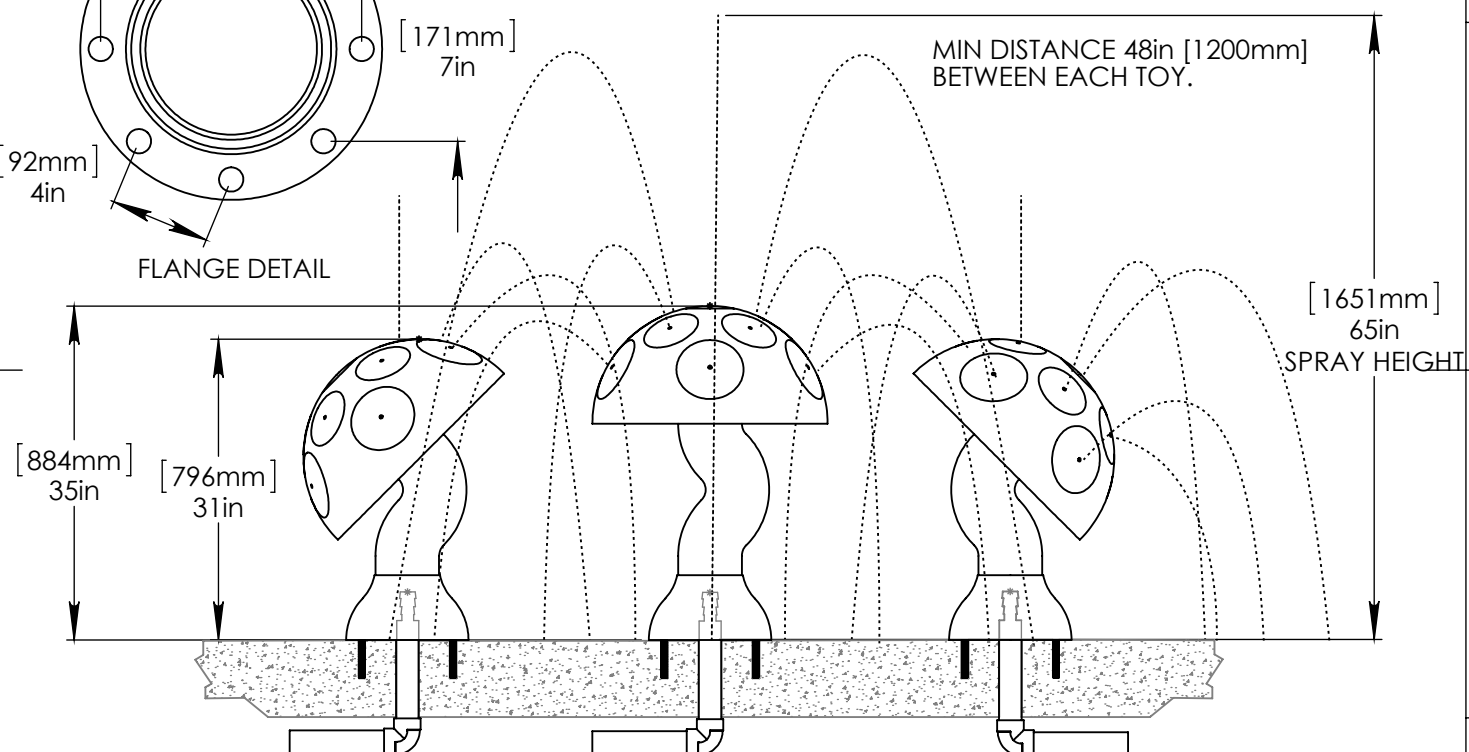
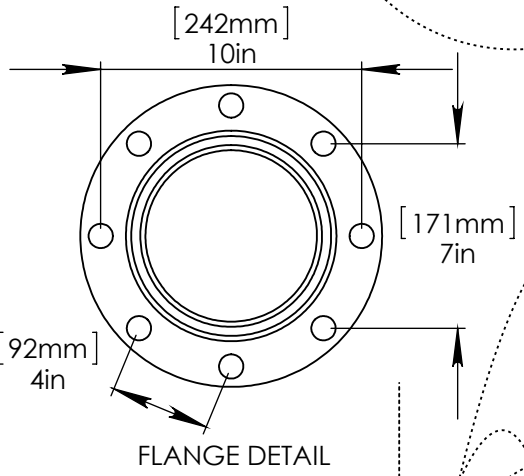
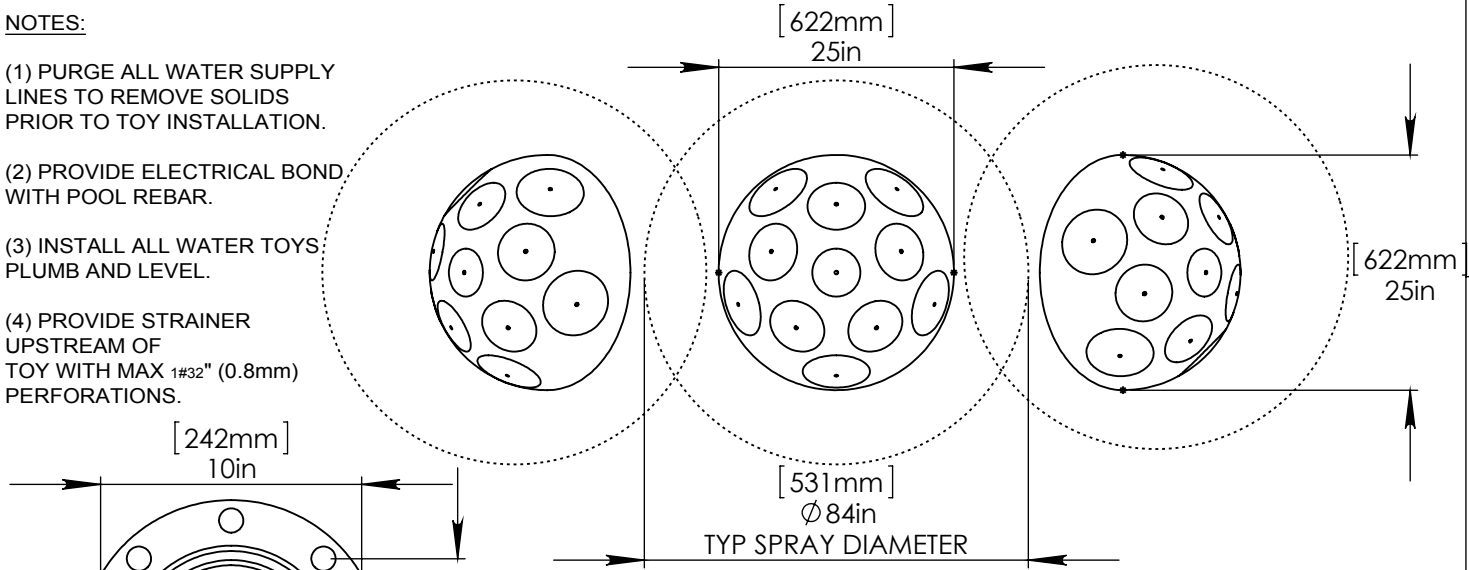

Notes: Overall dimensions of toys are approximate.

© EMPEX WATERTOYS



**WATER SUPPLY**

60 gpm (20 gpm each) @ 25 psi  
3.78 L/S (1.3 L/S each) @ 17.5m

**AQUACAPS TRIO**

**TR269-3**

3/31/2015

SCALE:  
1:20

Sheet  
1 of 1

1

2

3

4