

1

2

3

4

NOTES:

- (1) PURGE ALL WATER SUPPLY LINES TO REMOVE SOLIDS PRIOR TO TOY INSTALLATION.
- (2) PROVIDE ELECTRICAL BOND WITH POOL REBAR.
- (3) INSTALL ALL WATER TOYS PLUMB AND LEVEL.
- (4) PROVIDE STRAINER UPSTREAM OF TOY WITH MAX 1#32" (0.8mm) PERFORATIONS.

[4094mm]
Ø 161in

[5334.00mm]
Ø 210in
SPRAY DIAMETER

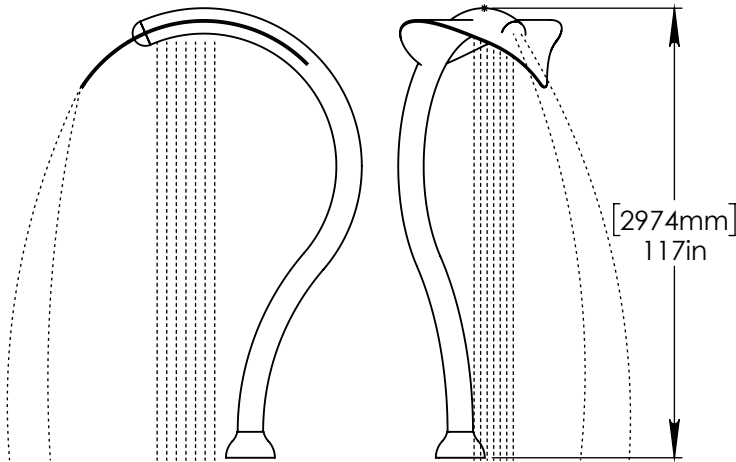
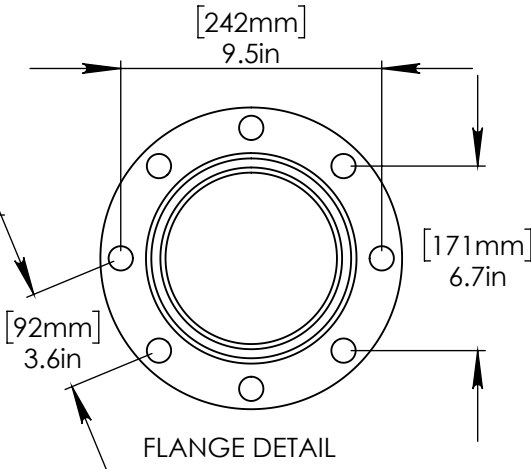

LOWER FLANGE COVER AFTER TOY IS INSTALLED.

STAINLESS STEEL (316)
5/8" (16mm) THREADED ROD, WASHER,
LOCK WASHER, & NUT.
THREADED ROD LENGTH 9" (230mm)
WITH 6" (150mm) EMBEDMENT. USE
MINIMUM 6 ANCHORS.

2" (50mm) SCH 40 PVC
WATER FEED TO BE EXTENDED
8" (200mm) ABOVE SLAB.

1" (25mm) EXPEX HOSE
PROVIDED BY EMPEX.

2" (50mm)-1" (25mm) FITTING
AND HOSE BARB TO BE SUPPLIED
BY CONTRACTOR.

[203.20mm]
8.00in



Notes: Overall dimensions of toys are approximate.

© EMPEX WATERTOYS

WATER SUPPLY

210gpm(70 each toy) @ 25 psi
13.24L/S @17.5m

AQUALEAF TRIO

TR340-3

7/5/2016

SCALE:
1:50

Sheet
1 of 1