

8 7 6 5 4 3 2 1

REVISIONS				
ZONE	REV.	DESCRIPTION	DATE	APPROVED

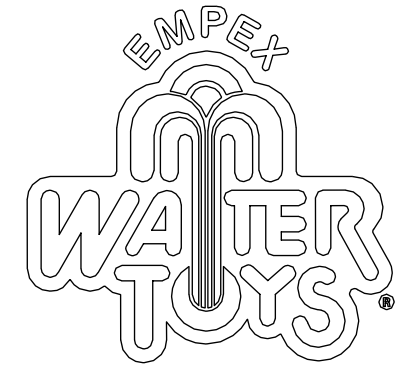

**EMPEX WATERTOYS**  
 50 INNOVATOR AVENUE  
 STOUFFVILLE, ON  
 Canada, L4A 0Y2

Tel: 905 640 3994 Fax: 905 640 5430  
 Toll Free: 1 866 833 8580

File Name:  
 HYDROLINE SPRAY AND SPLASH  
 ZONES layout

CUSTOMER:

## HYDROLINE SPRAY AND SPLASH ZONES layout

PROJECTION ANGLE

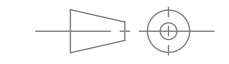

**B**  
 SIZE

SHEET SCALE:  
 1:220

UNITS

Drawings are strictly Design Drawings and not intended to be used for toolmaking purposes. They are not considered final engineering drawings. Specifications for tolerances, tooling and manufacturing are the responsibility of the manufacturer unless otherwise specified.

All copyright, design and other intellectual property rights in the contents hereof are the sole and exclusive property of EMPEX WATERTOYS. The provision of this document to you does not afford you any ownership, rights or license to use or reproduce same, all of which remains the property of EMPEX WATERTOYS. Reproduction, storage in a retrieval system, or transmission in any form by any means, whether electronic, mechanical or otherwise, in whole or in part, without the prior written consent of EMPEX WATERTOYS, is strictly prohibited.

LAST REVISED ON

NAME	Eric	REV
DATE	10/6/2021	

SHEET 1 of 2

SPRAY ZONE  
 0 WATER DEPTH

**AREA: 12055 SQ/FT  
 1120 SQ/M**

D  
C  
B  
A

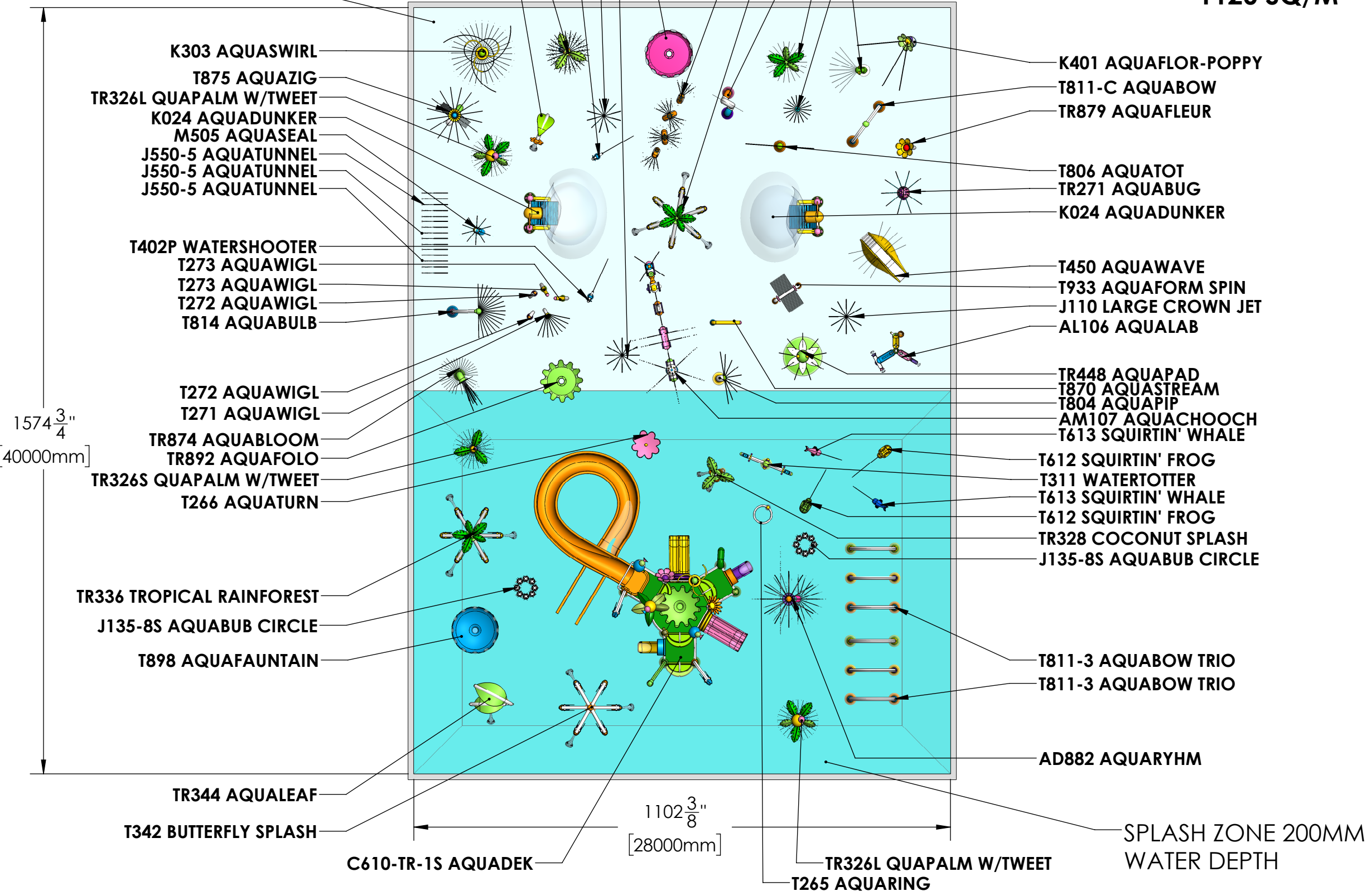

1574 <sup>3</sup>/<sub>4</sub>"  
 [40000mm]

1102 <sup>3</sup>/<sub>8</sub>"  
 [28000mm]

SPLASH ZONE 200MM  
 WATER DEPTH

8 7 6 5 4 3 2 1



**EMPEX WATER TOYS**  
 50 INNOVATOR AVENUE  
 STOUFFVILLE, ON  
 Canada, L4A 0Y2

Tel: 905 640 3994 Fax: 905 640 5430  
 Toll Free: 1 866 833 8580

File Name:  
 HYDROLINE SPRAY AND SPLASH  
 ZONES layout

**CUSTOMER:**

## HYDROLINE SPRAY AND SPLASH ZONES layout

PROJECTION ANGLE

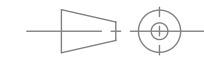

**B**

SIZE

SHEET SCALE:  
 1:220

UNITS

Drawings are strictly Design Drawings and not intended to be used for toolmaking purposes. They are not considered final engineering drawings. Specifications for tolerances, tooling and manufacturing are the responsibility of the manufacturer unless otherwise specified.

All copyright, design and other intellectual property rights in the contents hereof are the sole and exclusive property of EMPEX WATER TOYS. The provision of this document to you does not afford you any ownership, rights or license to use or reproduce same, all of which remains the property of EMPEX WATER TOYS. Reproduction, storage in a retrieval system, or transmission in any form by any means, whether electronic, mechanical or otherwise, in whole or in part, without the prior written consent of EMPEX WATER TOYS, is strictly prohibited.

LAST REVISED ON

NAME

Eric

REV

DATE

10/6/2021

SHEET 2 of 2

Qty	Toy	Description	MIN GPM PER FEATURE	MAX GPM PER FEATURE	MIN LtpS PER FEATURE	MAX LtpS PER FEATURE	TOTAL MIN GPM	TOTAL MAXGPM	TOTAL MIN LtpS	TOTAL MAX LtpS	System Pressure (PSI)
1	AD882	Aquaryhm	35	50	2.2	3.15	35	50	2.205	3.15	25
1	AD898	Aquafountain	280	400	17.7	25.3	280	400	17.71	25.3	10
1	AL106	Aqualab	49	70	3.1	4.42	49	70	3.094	4.42	25
1	AM107	Aquachooch	84	120	5.3	7.6	84	120	5.32	7.6	25
3	J110	Large Crown Jet	19	27	1.2	1.7	56.7	81	3.57	5.1	10
2	J135-8S	Aquabub Circle	49	70	3.1	4.4	98	140	6.16	8.8	10
1	J440	Fountain Jet	11	15	1.3	1.89	10.5	15	1.323	1.89	10
3	J550-5	Aquatunnel	25	35	1.5	2.2	73.5	105	4.62	6.6	10
2	K024	Aquadunker	49	70	3.1	4.4	98	140	6.16	8.8	25
1	K303	Aquaswirl	21	30	1.3	1.89	21	30	1.323	1.89	25
1	K401	Aquaflor-Poppy	21	30	1.3	1.89	21	30	1.323	1.89	25
1	M505	Aquaseal	21	30	1.3	1.89	21	30	1.323	1.89	25
1	T265	Aquaring	21	30	1.3	1.89	21	30	1.323	1.89	25
1	T266	Aquatum	49	70	3.1	4.4	49	70	3.08	4.4	25
1	T271	Aquawigl	21	30	1.3	1.89	21	30	1.323	1.89	25
2	T272	Aquawigl	21	30	1.3	1.89	42	60	2.646	3.78	25
2	T273	Aquawigl	21	30	1.3	1.89	42	60	2.646	3.78	25
1	T311	Watertotter	n/a	n/a	n/a	n/a	n/a	n/a	n/a	n/a	n/a
1	T342	Butterfly Splash	35	50	2.2	3.15	35	50	2.205	3.15	25
2	T402P	Watershooter	1	2	0.1	0.12	2.8	4	0.168	0.24	25
1	T450	Aquawave	21	30	1.3	1.89	21	30	1.323	1.89	25
2	T612	Squirtin' Frog	n/a	n/a	n/a	n/a	n/a	n/a	n/a	n/a	n/a
2	T613	Squirtin' Whale	n/a	n/a	n/a	n/a	n/a	n/a	n/a	n/a	n/a
1	T804	Aquapip	21	30	1.3	1.89	21	30	1.323	1.89	25
1	T806	Aquatot	21	30	1.3	1.89	21	30	1.323	1.89	25
1	T808	Aqualoop	35	50	2.2	3.15	35	50	2.205	3.15	25
1	T811-C	Aquabow	25	35	1.5	2.21	24.5	35	1.547	2.21	25
2	T811-3	Aquabow Trio	25	35	1.5	2.21	147	210	9.282	13.26	25
1	T814	Aquabulb	21	30	1.3	1.89	21	30	1.323	1.89	25
1	T870	Aquastream	21	30	1.3	1.89	21	30	1.323	1.89	25
1	T875	Aquazig	42	60	2.7	3.79	42	60	2.653	3.79	25
1	T898	Aquafountain	280	400	17.7	25.3	280	400	17.71	25.3	10
1	T933	Aquafom Spin	21	30	1.3	1.89	21	30	1.323	1.89	25
1	TR271	Aquabug	14	20	0.9	1.3	14	20	0.91	1.3	25
1	TR273S	Aquahopper	21	30	1.3	1.89	21	30	1.323	1.89	25
1	TR321	Aquaserp	42	60	2.7	3.8	84	120	5.32	7.6	25
1	TR325L	Aquapalm	21	30	1.3	1.89	21	30	1.323	1.89	25
1	TR326S	Aquapalm w/Tweet	21	30	1.3	1.89	21	30	1.323	1.89	25
2	TR326L	Aquapalm w/Tweet	21	30	1.3	1.89	42	60	2.646	3.78	25
1	TR327S	Aquapalm Curve	21	30	1.3	1.89	21	30	1.323	1.89	25
1	TR328	Coconut Splash	21	30	1.3	1.89	21	30	1.323	1.89	25
2	TR336	Tropical Rainforest	35	50	2.2	3.15	70	100	4.41	6.3	25
1	TR342	Aqualeaf	49	70	3.1	4.4	49	70	3.08	4.4	25
1	TR344	Aqualeaf	21	30	1.3	1.89	21	30	1.323	1.89	25
1	TR448	Aquapad	32	45	2.0	2.8	31.5	45	1.96	2.8	25
1	TR874	Aquabloom	42	60	2.7	3.79	42	60	2.653	3.79	25
1	TR879	Aquafeur	27	38	1.7	2.4	26.6	38	1.68	2.4	25
1	TR892	Aquafolo	140	200	8.8	12.63	140	200	8.841	12.63	25
1	C610-TR-1S	Aquadek	350	500	21.7	31	350	500	21.7	31	25
63		<b>TOTALS</b>					2690.1	3843	169.995	242.85	