

Qty	Toy	Description	MIN GPM PER FEATURE	MAX GPM PER FEATURE	MIN LIPS PER FEATURE	MAX LIPS PER FEATURE	TOTAL MIN GPM	TOTAL MAX GPM	TOTAL MIN LtpS	TOTAL MAX LtpS	System Pressure (PSI)
4	J100	Small Crown Jet	4	5	0.2	0.32	14	20	0.896	1.28	25
3	J110	Large Crown Jet	19	27	1.2	1.7	56.7	81	3.57	5.1	10
2	J330	Vertical Jet	5	7	0.3	0.44	9.8	14	0.616	0.88	10
2	J330-5	Aqualine	25	35	1.5	2.2	49	70	3.08	4.4	10
2	J330-8	Aquacurve	39	56	2.5	3.5	78.4	112	4.9	7	10
2	J440	Fountain Jet	11	15	1.3	1.89	21	30	2.646	3.78	10
4	J550-5	Aquatunnel	25	35	1.5	2.2	98	140	6.16	8.8	10
1	T272	Aquawigl	21	30	1.3	1.89	21	30	1.323	1.89	25
3	T402P	Watershooter	1	2	0.1	0.12	4.2	6	0.252	0.36	25
1	T730	Aquafall	49	70	3.1	4.4	49	70	3.08	4.4	25
1	T802	Aquanip	11	15	0.7	1	10.5	15	0.7	1	25
1	T803	Aquabop	21	30	1.3	1.89	21	30	1.323	1.89	25
1	T807	Aquashere	21	30	1.3	1.89	21	30	1.323	1.89	25
1	T808	Aqualoop	35	50	2.2	3.15	35	50	2.205	3.15	25
1	T810-4	Aquabolo Quad	25	35	1.5	2.21	98	140	6.188	8.84	25
1	T811-3	Aquabow Trio	25	35	1.5	2.21	73.5	105	4.641	6.63	25
1	T814	Aquabulb	21	30	1.3	1.89	21	30	1.323	1.89	25
1	T816	Aquadunk	7	10	0.4	0.63	7	10	0.441	0.63	25
1	T870	Aquastream	21	30	1.3	1.89	21	30	1.323	1.89	25
1	T871	Aquatee	35	50	2.2	3.15	35	50	2.205	3.15	25
1	T886	Aquabrello	175	250	11.0	15.77	175	250	11.039	15.77	10
1	T898	Aquafountain	280	400	17.7	25.3	280	400	17.71	25.3	10
1	TR271	Aquabug	14	20	0.9	1.3	14	20	0.91	1.3	25
1	TR874	Aquabloom	42	60	2.7	3.79	42	60	2.653	3.79	25
38		TOTALS					1255.1	1793	80.507	115.01	

REVISIONS				
ZONE	REV.	DESCRIPTION	DATE	APPROVED

**AREA: 4181 SQ/FT
388 SQ/M**



EMPEX WATERTOYS
50 INNOVATOR AVENUE
STOUFFVILLE, ON
Canada, L4A 0Y2

Tel: 905 640 3994 Fax: 905 640 5430
Toll Free: 1 866 833 8580

File Name: PRUSZKOW WATER PARK layout.SLDPRT

CUSTOMER:

**PRUSZKOW
WATER PARK**

PROJECTION ANGLE

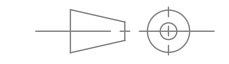

B
SIZE

SHEET SCALE:
1:300

UNITS

Drawings are strictly Design Drawings and not intended to be used for toolmaking purposes. They are not considered final engineering drawings. Specifications for tolerances, tooling and manufacturing are the responsibility of the manufacturer unless otherwise specified.

All copyright, design and other intellectual property rights in the contents hereof are the sole and exclusive property of EMPEX WATERTOYS. The provision of this document to you does not afford you any ownership, rights or license to use or reproduce same, all of which remains the property of EMPEX WATERTOYS. Reproduction, storage in a retrieval system, or transmission in any form by any means, whether electronic, mechanical or otherwise, in whole or in part, without the prior written consent of EMPEX WATERTOYS, is strictly prohibited.

LAST REVISED ON		REV
NAME	Eric	
DATE	6/15/2020	

SHEET 1 of 1

