

NOTES:

- (1) PURGE ALL WATER SUPPLY LINES TO REMOVE SOLIDS PRIOR TO TOY INSTALLATION.
- (2) PROVIDE ELECTRICAL BOND WITH POOL REBAR.
- (3) INSTALL ALL WATER TOYS PLUMB AND LEVEL.
- (4) PROVIDE STRAINER UPSTREAM OF TOY WITH MAX 1/32" (0.8mm) PERFORATIONS.

- 2" (50mm) COUPLING
- 2" (50mm) TO 1" (25mm) REDUCER
- 1" (25mm) HOSE BARB W/SS CLAMP TO BE PROVIDED BY CONTRACTOR

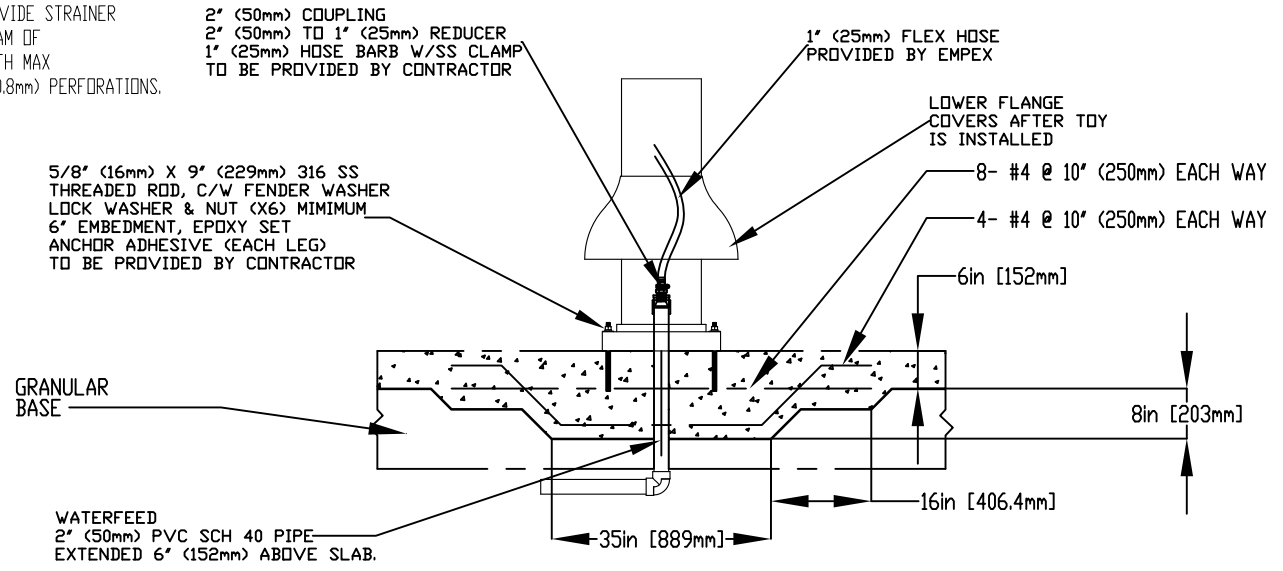
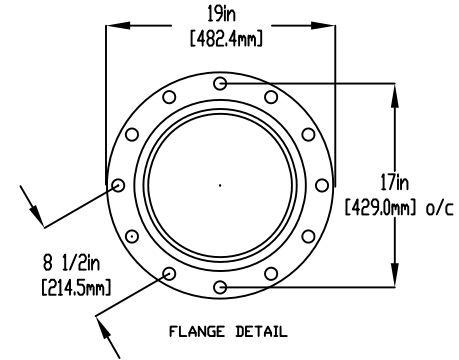

	Notes: Overall dimensions of toys are approximate. Approximate Weight: 557lbs (262.3kgs)		© EMPEX WATERTOYS		
	WATER SUPPLY 50 gpm @ 25 psi 3.15L/S @17.5m		TIPPIN' SWIRLS T433		
			29/05/2023	SCALE:	Sheet 1 of 1