

NOTES:

- (1) PURGE ALL WATER SUPPLY LINES TO REMOVE SOLIDS PRIOR TO TOY INSTALLATION.
- (2) PROVIDE ELECTRICAL BOND WITH POOL REBAR.
- (3) INSTALL ALL WATER TOYS PLUMB AND LEVEL.
- (4) PROVIDE STRAINER UPSTREAM OF TOY WITH MAX 1/32" (0.8mm) PERFORATIONS.

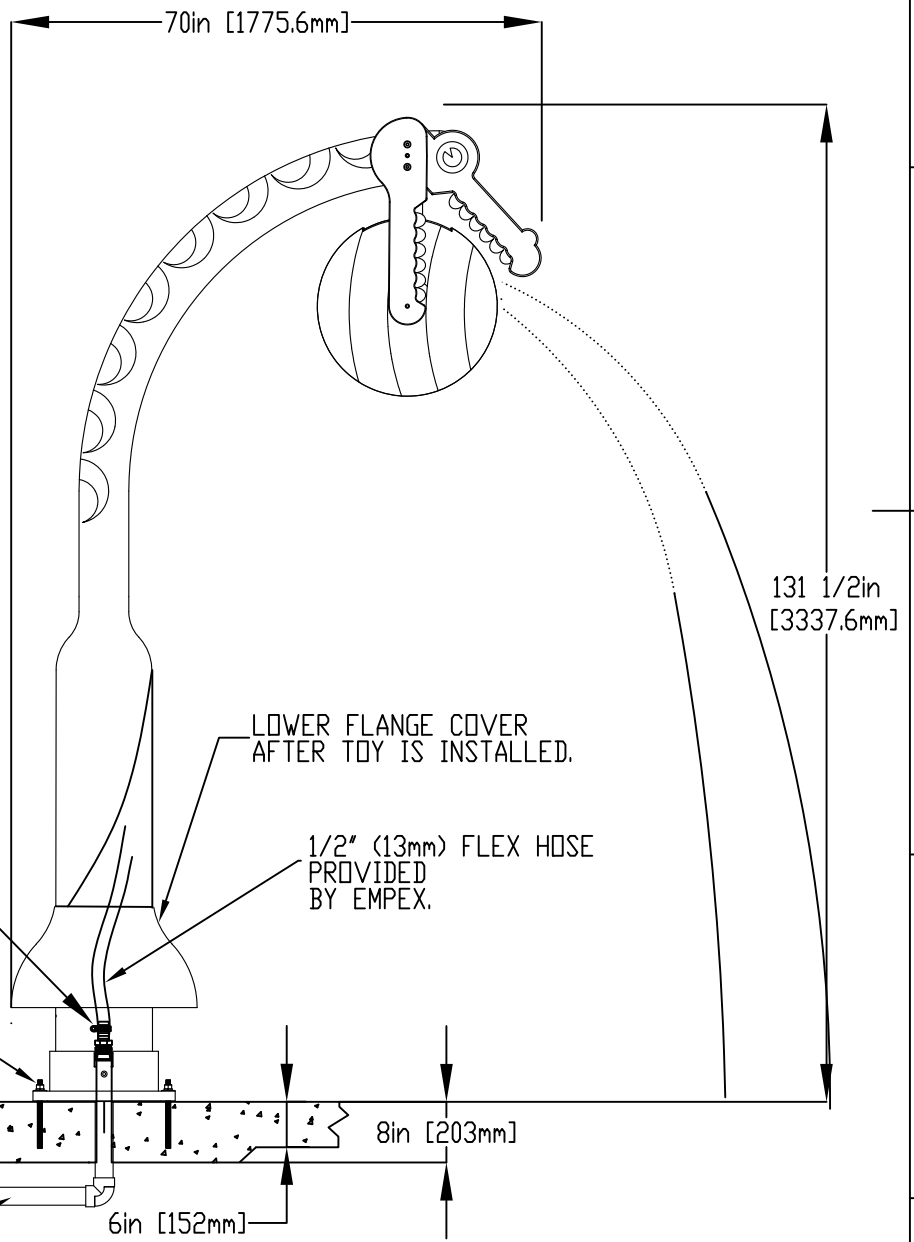
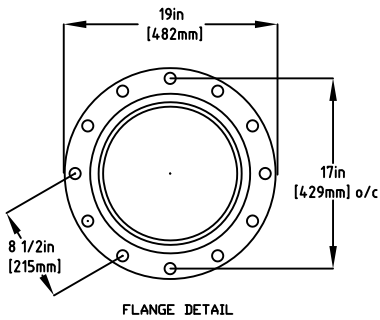
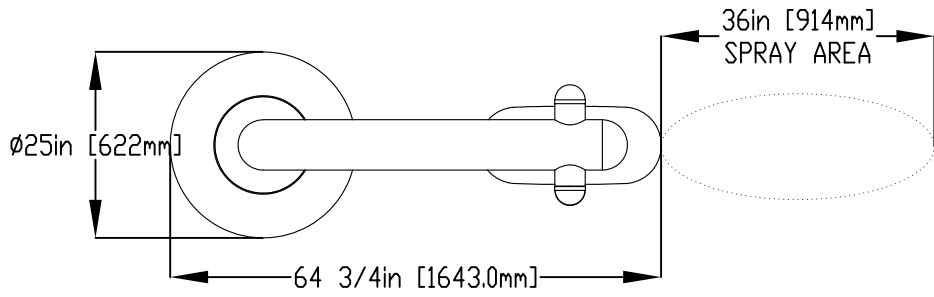

2" (50mm) COUPLING
 2" (50mm)-1/2" (13mm) REDUCER
 1/2" (50mm) HOSEBARB W/SS CLAMP
 TO BE PROVIDED BY CONTRACTOR

5/8" (16mm) X 9" (230mm) 316SS
 THREADED ROD C/W FENDER WASHER,
 LOCK WASHER & NUT (X6), MINIMUM
 6" (152mm) EMBEDMENT, EPOXY SET
 ANCHOR ADHESIVE
 TO BE PROVIDED BY CONTRACTOR

WATERFEED
 2" (50mm) SCH 40 PVC PIPE
 EXTENDED 6" (152mm) ABOVE SLAB.

LOWER FLANGE COVER
 AFTER TOY IS INSTALLED.

1/2" (13mm) FLEX HOSE
 PROVIDED
 BY EMPEX.



Notes: Overall dimensions of toys are approximate.
 Approximate Weight: 178lbs / 80.9kgs

© EMPEX WATERTOYS

WATER SUPPLY
 10 gpm @ 25 psi
 0.63 L/S @ 17.5m

AQUADUNK GATR

Z216

01/06/2023

SCALE:

Sheet
 1 of 1