

NOTES:

- (1) PURGE ALL WATER SUPPLY LINES TO REMOVE SOLIDS PRIOR TO TOY INSTALLATION.
- (2) PROVIDE ELECTRICAL BOND WITH POOL REBAR.
- (3) INSTALL ALL WATER TOYS PLUMB AND LEVEL.
- (4) PROVIDE STRAINER UPSTREAM OF TOY WITH MAX 1/32" (0.8mm) PERFORATIONS.

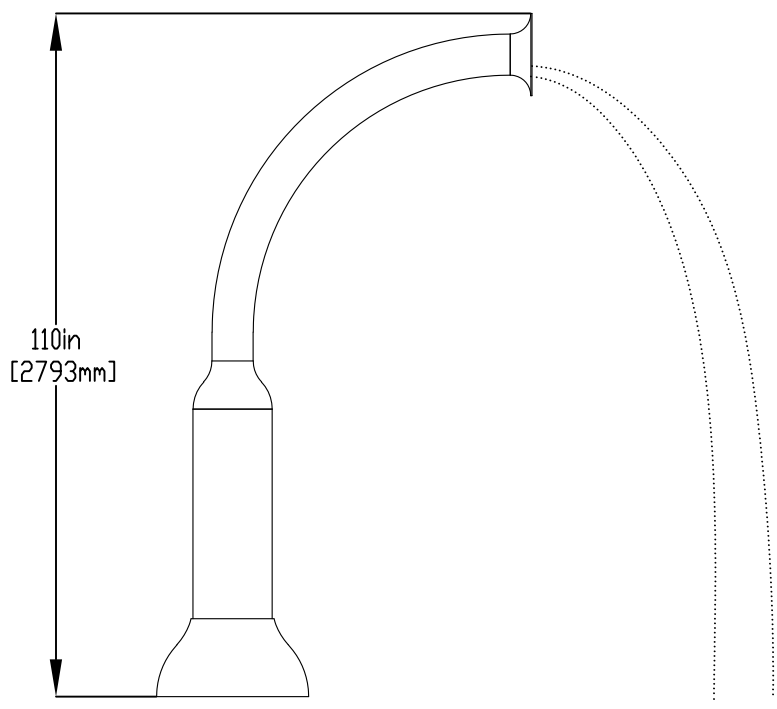
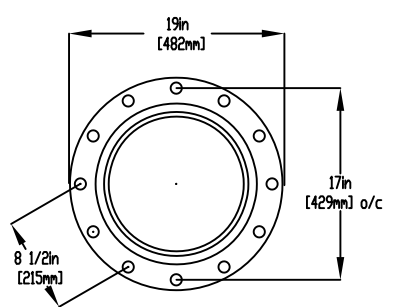
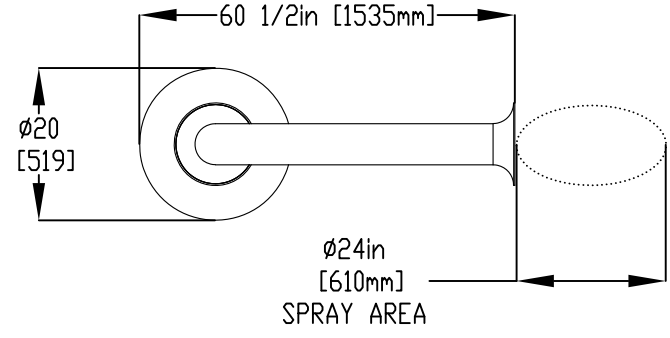

LOWER FLANGE COVER AFTER TOY IS INSTALLED.

1/2" (13mm) X 8" (203mm) 316SS THREADED ROD, C/W FENDER WASHER, LOCK WASHER & NUT (X6) MINIMUM 6" (152mm) EMBEDMENT, EPOXY SET ANCHOR ADHESIVE TO BE PROVIDED BY CONTRACTOR

ENSURE LEVEL SURFACE. INSTALL 12" (305mm) X 1/8" (3mm) GASKET UNDER COLUMN FLANGE.

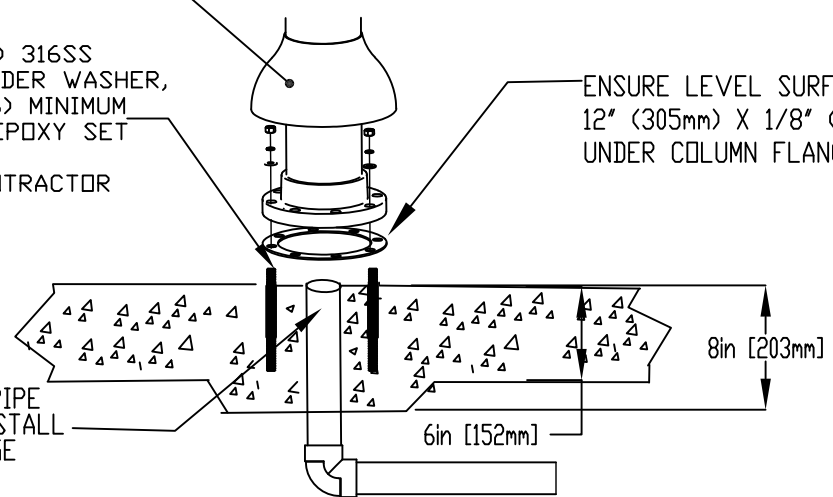

WATERFEED 2" (50mm) PVC SCH 40 PIPE CUT CLOSE PRIOR TO INSTALL TO ALLOW FULL DRAINAGE WINTERIZATION)

Notes: Overall dimensions of toys are approximate. Approximate Weight: 160lbs (72.7kgs)

© EMPEX WATERTOYS



WATER SUPPLY  
30 gpm @ 25 psi  
1.89L/S @17.5m

AQUABENDO

T813

01/03/2022

SCALE:

Sheet 1 of 1