

1

2

3

4

NOTES:

(1) PURGE ALL WATER SUPPLY LINES TO REMOVE SOLIDS PRIOR TO TOY INSTALLATION.

(2) PROVIDE ELECTRICAL BOND WITH POOL REBAR.

(3) INSTALL ALL WATER TOYS PLUMB AND LEVEL.

(4) PROVIDE STRAINER UPSTREAM OF TOY WITH MAX 1/32" (0.8mm) PERFORATIONS.

A

A

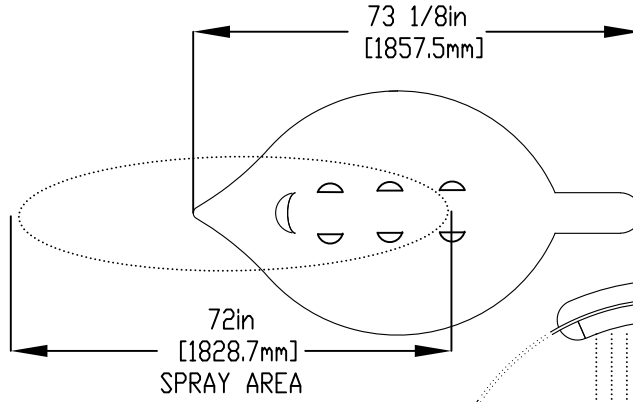

B

B

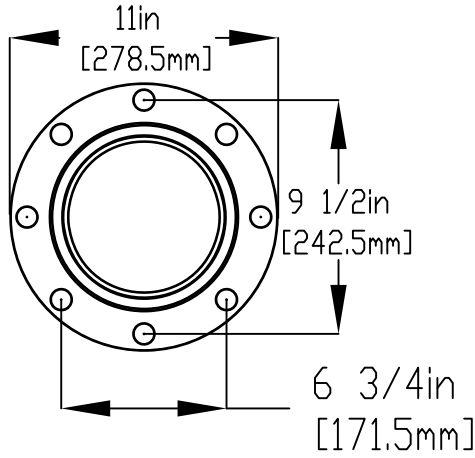

FLANGE DETAIL

117 1/8in [2973.7mm]

C

C

D

D

LOWER FLANGE COVER AFTER TOY IS INSTALLED.

5/8" (16mm) X 9" (229mm) 316SS THREADED ROD, C/W FENDER WASHER, LOCK WASHER, & NUT (X6). MINIMUM 6" (152mm) EMBEDMENT, EPOXY SET ANCHOR ADHESIVE TO BE PROVIDED BY CONTRACTOR

ENSURE LEVEL & PLUMB 6" (152mm) X 1/8"(3mm) GASKET INSTALLED UNDER FLANGE PROVIDED BY EMPEX

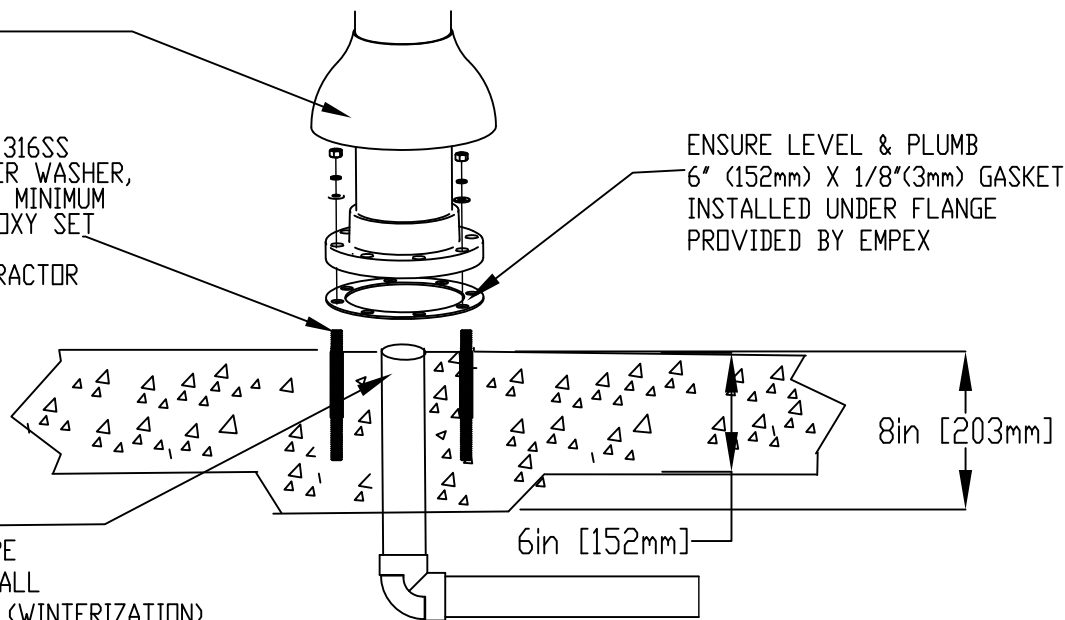

WATER FEED 2" (50mm) SCH 40 PVC PIPE CUT CLOSE PRIOR TO INSTALL TO ALLOW FULL DRAINAGE (WINTERIZATION)

E

E

F

F



Notes: Overall dimensions of toys are approximate.

© EMPEX WATERTOYS

WATER SUPPLY

70 gpm @ 25 psi
4.4 L/S @17.5m

AQUALEAF

TR340

15/05/2020

SCALE:

Sheet
1 of 1

1

2

3

4