

1

2

3

4

A

A

NOTES:

(1) PURGE ALL WATER SUPPLY LINES TO REMOVE SOLIDS PRIOR TO TOY INSTALLATION.

(2) PROVIDE ELECTRICAL BOND WITH POOL REBAR.

(3) INSTALL ALL WATER TOYS PLUMB AND LEVEL.

(4) PROVIDE STRAINER UPSTREAM OF TOY WITH MAX 1/32" X (0.8mm) PERFORATIONS.

B

B

Ø84IN
[2133.6MM]
SPRAY DIAMETER

Ø12 3/4in
[Ø323.9mm]

18in
[458.4mm]

C

C

48 3/4IN
[1238.8MM]

D

D

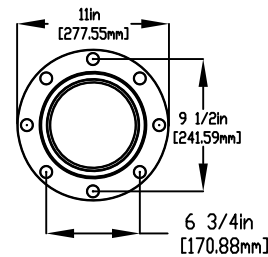

FLANGE DETAIL

LOWER FLANGE COVER AFTER INSTALL

E

E

1/2" (13mm) X 8" (203mm) 316SS THREADED ROD, C/W FENDER WASHER, LOCK WASHER & NUT (X6) MINIMUM 6" (152mm) EMBEDMENT, EPOXY SET ANCHOR ADHESIVE TO BE PROVIDED BY CONTRACTOR

FLOODED COLUMN ENSURE LEVEL & PLUMB (6" 152mm) X 1/8" (3mm) GASKET, INSTALLED UNDER FLANGE TO BE PROVIDED BY EMPEX

WATERFEED 2" (50MM) PVC SCH40 PIPE CUT CLOSE PRIOR TO INSTALL TO ALLOW FOR FULL DRAINAGE

8in [203mm]

6in [152mm]

F

F



Notes: Overall dimensions of toys are approximate.
Approximate Weight: 32lbs / 14.5kgs

© EMPEX WATERTOYS

WATER SUPPLY

30 gpm @ 25 psi
1.89L/S @17.5m

AQUAWIGL

T270

01/05/2020

SCALE:

Sheet
1 of 1

1

2

3

4